

## **QUICK SET UP GUIDE**

---

### ACCESSORIES



*For illustrative purposes only.*



**STEP 1**

Install the AromaSteam in a location convenient for replacing essential oil bottles.

**STEP 2**

Install the Check valve into a tee in the steamline.

**STEP 3**

Connect the preassembled pressure tube to the AromaSteam pump and the check valve.

**STEP 4**

Connect the preassembled suction tube to the AromaSteam pump and place the end into the essential oil bottle. Place the essential oil bottle into the caddy provided.

## AROMASTEAM SYSTEM

Electronic Oil delivery system evenly infuses aroma into steam for an aromatherapy experience. Complete with oil container caddy, hoses, fittings and oil check valve.

AromaSteam Essential oils are available in one-liter bottles. Not for use with acrylic or fiberglass rooms.

**DO NOT EXCEED 30 FEET OF TUBING  
OR A VERTICAL DISTANCE OF 6 FEET  
BETWEEN THE PUMP HEAD AND  
CHECK VALVE.**

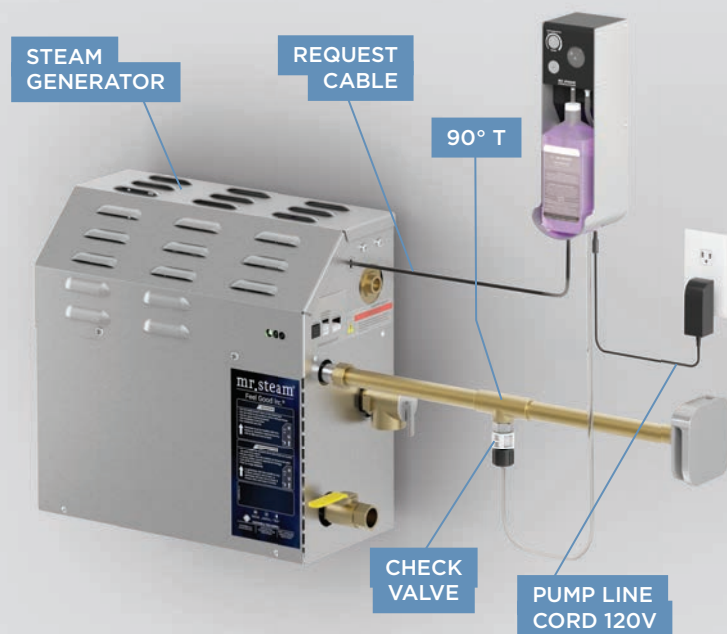

**⚠WARNING** The information in this guide is designed to provide a general overview of how MrSteam® products are installed. All images and diagrams are for illustrative purposes only and may have been altered for presentation purposes. NEVER use this document for the Installation, Operation or Maintenance of any MrSteam® product. For installation, operation and maintenance information and instructions, only use the applicable MrSteam® Installation, Operation & Maintenance Manual(s). The specific Installation, Operation & Maintenance manual that is supplied with each MrSteam® product contains important information required for the safe and reliable installation and operation of the product. Failure to install any MrSteam® product according to the applicable manual may result in property damage, an inoperable system/control, or hazardous condition. If you do not have the applicable Installation, Operation & Maintenance manual please contact MrSteam® for a free copy, or download a copy from [www.mrsteam.com](http://www.mrsteam.com). If you have any questions about the installation, operation or maintenance of any MrSteam® product please contact a customer or technical service representative using the contact information on the back cover of this guide or consult a properly licensed contractor, architect and/or design professional.

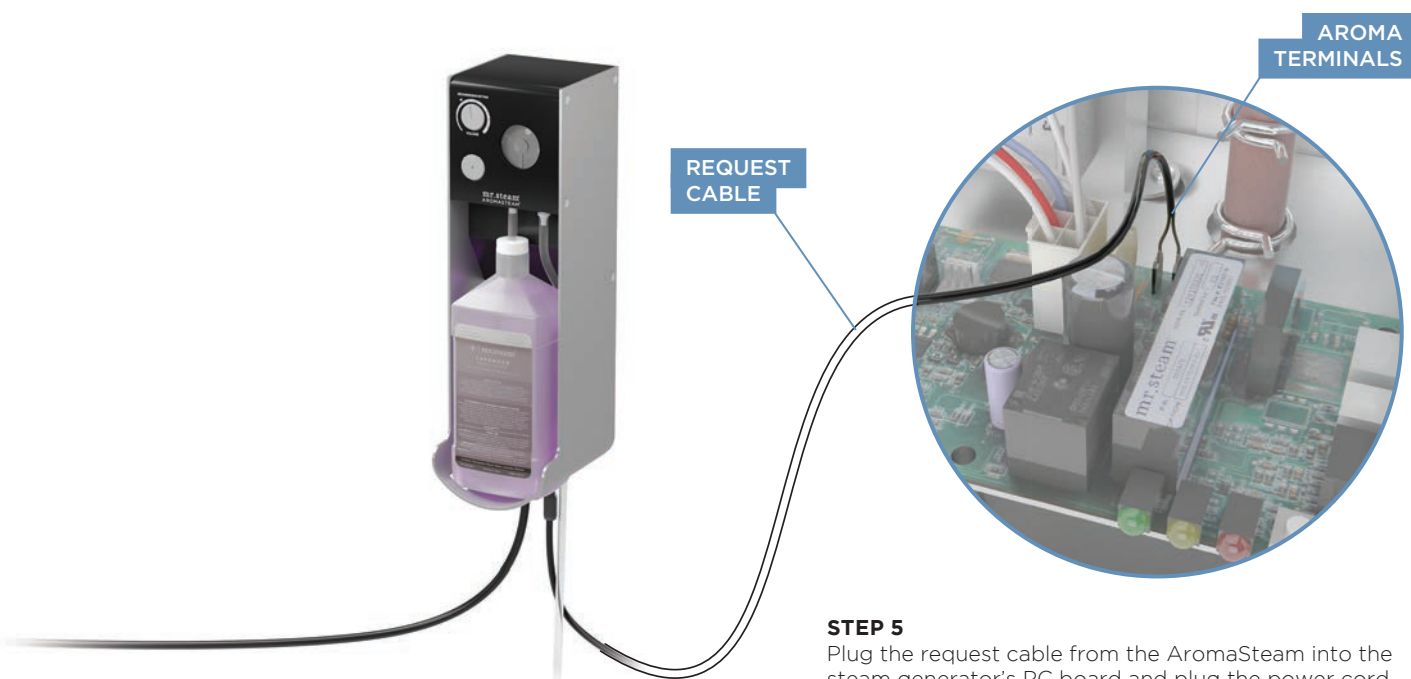

**⚠WARNING** The information in this guide is designed to provide a general overview of how MrSteam® products are installed. All images and diagrams are for illustrative purposes only and may have been altered for presentation purposes. NEVER use this document for the Installation, Operation or Maintenance of any MrSteam® product. For installation, operation and maintenance information and instructions, only use the applicable MrSteam® Installation, Operation & Maintenance Manual(s). The specific Installation, Operation & Maintenance manual that is supplied with each MrSteam® product contains important information required for the safe and reliable installation and operation of the product. Failure to install any MrSteam® product according to the applicable manual may result in property damage, an inoperable system/control, or hazardous condition. If you do not have the applicable Installation, Operation & Maintenance manual please contact MrSteam® for a free copy, or download a copy from [www.mrsteam.com](http://www.mrsteam.com). If you have any questions about the installation, operation or maintenance of any MrSteam® product please contact a customer or technical service representative using the contact information on the back cover of this guide or consult a properly licensed contractor, architect and/or design professional.

## AROMASTEAM STEAMHEAD

NOTE: Steamhead to be installed 6-12" above the finished floor. A 1.5" diameter hole in the steam room is required to mount the steamhead. Refer to the MrSteam Installation Manual for additional installation information.

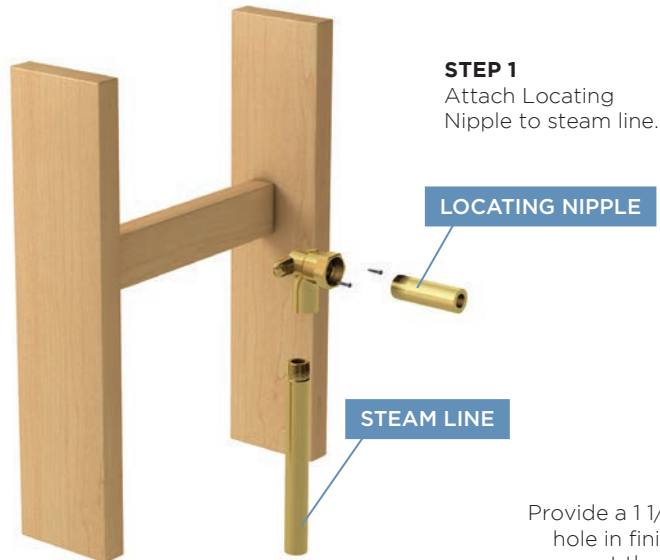

**STEP 2**  
Provide a 1 1/2" diameter hole in finished wall to mount the steamhead.



OIL WELL



The Acrylic Shield (PN 103938 for round and 103938SQ for square) is for use when acrylic or other non-heat resistant materials are used for the steamroom enclosure. The Acrylic Shield is to be installed between the finished wall and the steamhead.

NOTE: Do not locate the control above or near the SteamHead

**⚠️WARNING** The information in this guide is designed to provide a general overview of how MrSteam® products are installed. All images and diagrams are for illustrative purposes only and may have been altered for presentation purposes. NEVER use this document for the Installation, Operation or Maintenance of any MrSteam® product. For installation, operation and maintenance information and instructions, only use the applicable MrSteam® Installation, Operation & Maintenance Manual(s). The specific Installation, Operation & Maintenance manual that is supplied with each MrSteam® product contains important information required for the safe and reliable installation and operation of the product. Failure to install any MrSteam® product according to the applicable manual may result in property damage, an inoperable system/control, or hazardous condition. If you do not have the applicable Installation, Operation & Maintenance manual please contact MrSteam® for a free copy, or download a copy from [www.mrsteam.com](http://www.mrsteam.com). If you have any questions about the installation, operation or maintenance of any MrSteam® product please contact a customer or technical service representative using the contact information on the back cover of this guide or consult a properly licensed contractor, architect and/or design professional.



## USING ESSENTIAL OILS WITH THE AROMASTEAM™ STEAMHEAD

- Enjoy essential oils by placing a drop or two, into your steamhead as shown in the illustration.
- Tightly close containers when storing oils.
- Keep away from sources of ignition.

*For illustrative purposes only. Consult with qualified designer, architect or contractor for steamroom construction details.*

### ⚠ WARNING

**1. START WITH ONE DROP TO GAUGE STRENGTH AND SUITABILITY. LIMIT TO A MAXIMUM OF A FEW DROPS DURING A STEAMBATHING SESSION.**

**2. PLACE THE DROPS INTO THE MRSTEAM AROMASTEAM STEAMHEAD WELL PRIOR TO TURNING ON THE STEAMBATH. DO NOT PLACE DROPS IN A HOT STEAM HEAD AS SERIOUS INJURY CAN RESULT IF YOU DO NOT FOLLOW THIS WARNING.**

**3. SOME PEOPLE MAY FIND THAT THE AROMA MAKES THEM DIZZY AND THE USER SHOULD EXIT THE STEAM BATH IMMEDIATELY. IF SKIN IRRITATION OCCURS STOP USING THE OILS IMMEDIATELY. REMOVE ANY EXCESS OIL BY WASHING IN MILD**

**SOAP AND WATER. IF INGESTED, RINSE MOUTH WITH WATER. ADMINISTER WATER OR MILK TO DILUTE. CONTACT A PHYSICIAN IMMEDIATELY.**

**4. USE ESSENTIAL OILS WITH CAUTION. ESSENTIAL OILS ARE FOR EXTERNAL USE ONLY. KEEP OUT OF REACH OF CHILDREN. ESSENTIAL OILS ARE HIGHLY CONCENTRATED AND ARE POTENT SUBSTANCES AND SHOULD NOT BE APPLIED DIRECTLY TO THE SKIN AS THEY CAN BE IRRITANTS. USE ESSENTIAL OILS WITH CAUTION.**

**5. ESSENTIAL OILS AND/OR AROMATHERAPY CAN CAUSE INFLAMMATION, BURNS, HEADACHE, NAUSEA AND ALLERGIC REACTIONS. CONSULT A PHYSICIAN BEFORE USING AROMATHERAPY.**

⚠ WARNING The information in this guide is designed to provide a general overview of how MrSteam® products are installed. All images and diagrams are for illustrative purposes only and may have been altered for presentation purposes. NEVER use this document for the Installation, Operation or Maintenance of any MrSteam® product. For installation, operation and maintenance information and instructions, only use the applicable MrSteam® Installation, Operation & Maintenance Manual(s). The specific Installation, Operation & Maintenance manual that is supplied with each MrSteam® product contains important information required for the safe and reliable installation and operation of the product. Failure to install any MrSteam® product according to the applicable manual may result in property damage, an inoperable system/control, or hazardous condition. If you do not have the applicable Installation, Operation & Maintenance manual please contact MrSteam® for a free copy, or download a copy from [www.mrsteam.com](http://www.mrsteam.com). If you have any questions about the installation, operation or maintenance of any MrSteam® product please contact a customer or technical service representative using the contact information on the back cover of this guide or consult a properly licensed contractor, architect and/or design professional.

## LINEAR STEAMHEAD



Do not locate the steam head in any location where the steam emission zone is near a seat, bench, or any space occupied by any persons. for a diagram of the steam emission zone.



The brackets can slide horizontally (Figure 1).



FIGURE 1

*For illustrative purposes only. Consult with qualified designer, architect or contractor for steamroom construction details.*

**⚠ WARNING** The information in this guide is designed to provide a general overview of how MrSteam® products are installed. All images and diagrams are for illustrative purposes only and may have been altered for presentation purposes. NEVER use this document for the Installation, Operation or Maintenance of any MrSteam® product. For installation, operation and maintenance information and instructions, only use the applicable MrSteam® Installation, Operation & Maintenance Manual(s). The specific Installation, Operation & Maintenance manual that is supplied with each MrSteam® product contains important information required for the safe and reliable installation and operation of the product. Failure to install any MrSteam® product according to the applicable manual may result in property damage, an inoperable system/control, or hazardous condition. If you do not have the applicable Installation, Operation & Maintenance manual please contact MrSteam® for a free copy, or download a copy from [www.mrsteam.com](http://www.mrsteam.com). If you have any questions about the installation, operation or maintenance of any MrSteam® product please contact a customer or technical service representative using the contact information on the back cover of this guide or consult a properly licensed contractor, architect and/or design professional.



FIGURE 2

The brackets are adjustable to fit tightly between the beams (Figure 2).

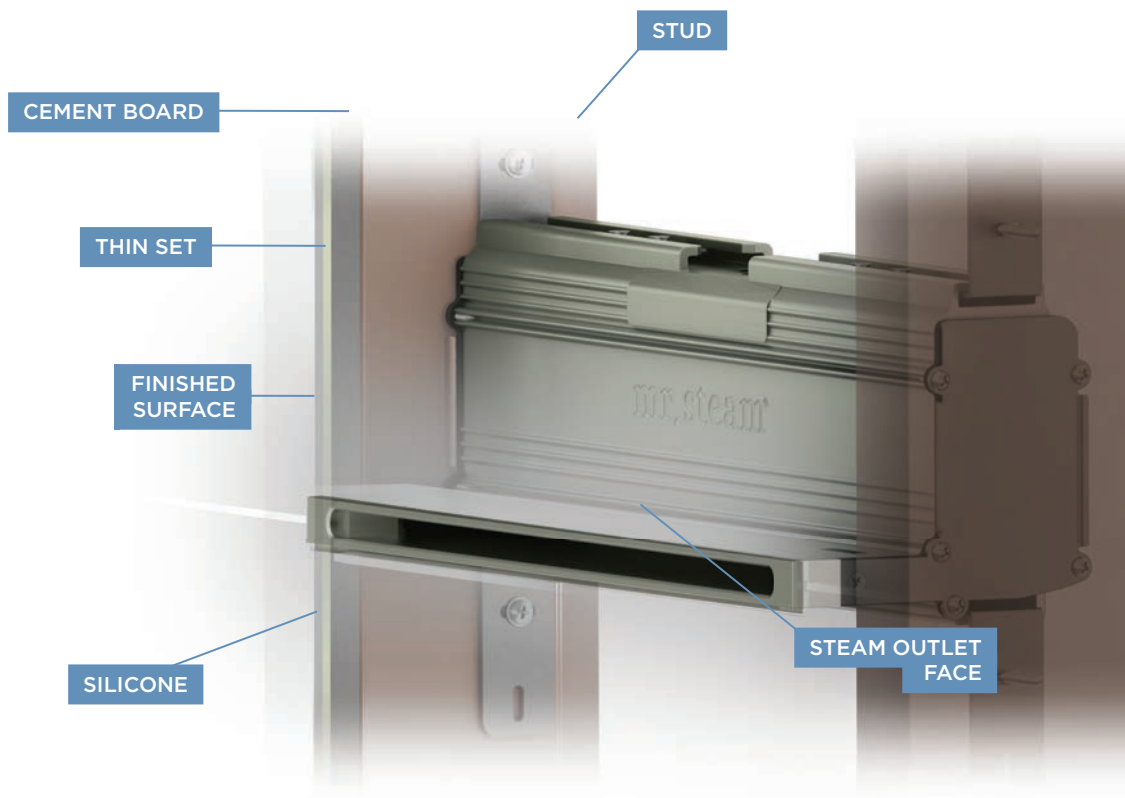

**⚠WARNING** The information in this guide is designed to provide a general overview of how MrSteam® products are installed. All images and diagrams are for illustrative purposes only and may have been altered for presentation purposes. NEVER use this document for the Installation, Operation or Maintenance of any MrSteam® product. For installation, operation and maintenance information and instructions, only use the applicable MrSteam® Installation, Operation & Maintenance Manual(s). The specific Installation, Operation & Maintenance manual that is supplied with each MrSteam® product contains important information required for the safe and reliable installation and operation of the product. Failure to install any MrSteam® product according to the applicable manual may result in property damage, an inoperable system/control, or hazardous condition. If you do not have the applicable Installation, Operation & Maintenance manual please contact MrSteam® for a free copy, or download a copy from [www.mrsteam.com](http://www.mrsteam.com). If you have any questions about the installation, operation or maintenance of any MrSteam® product please contact a customer or technical service representative using the contact information on the back cover of this guide or consult a properly licensed contractor, architect and/or design professional.

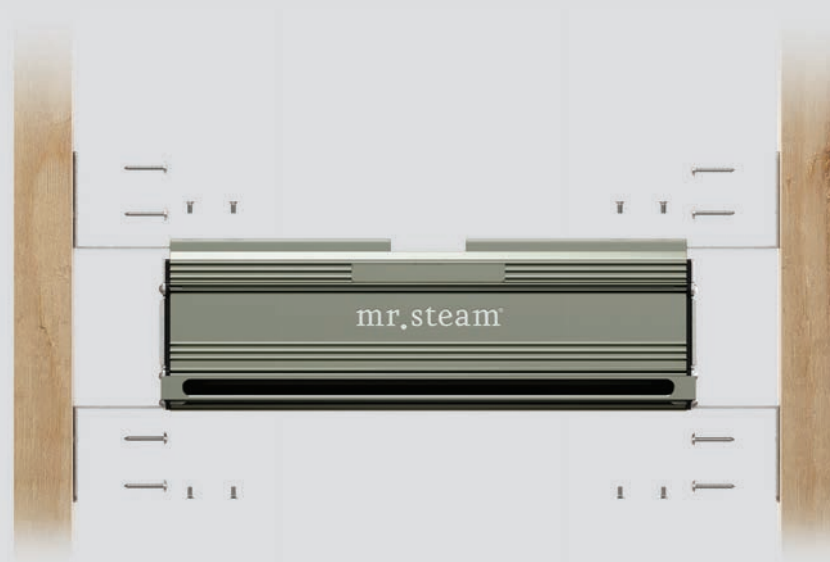

**STEP 1**

Determine the location of the finished wall surface. Mount the steam head between two studs by screws through the four slotted holes. Use a level to ensure steam head is level in both the horizontal and vertical positions.

Position the steam head face to be recessed 1/8" from the finished wall surface. 3/4" NPT Steam line opening should be on top. DO NOT mount steam head upside down. Tighten the 8 screws on the 4 brackets to secure the steamhead in the correct location between the studs.

**⚠WARNING** The information in this guide is designed to provide a general overview of how MrSteam® products are installed. All images and diagrams are for illustrative purposes only and may have been altered for presentation purposes. NEVER use this document for the Installation, Operation or Maintenance of any MrSteam® product. For installation, operation and maintenance information and instructions, only use the applicable MrSteam® Installation, Operation & Maintenance Manual(s). The specific Installation, Operation & Maintenance manual that is supplied with each MrSteam® product contains important information required for the safe and reliable installation and operation of the product. Failure to install any MrSteam® product according to the applicable manual may result in property damage, an inoperable system/control, or hazardous condition. If you do not have the applicable Installation, Operation & Maintenance manual please contact MrSteam® for a free copy, or download a copy from [www.mrsteam.com](http://www.mrsteam.com). If you have any questions about the installation, operation or maintenance of any MrSteam® product please contact a customer or technical service representative using the contact information on the back cover of this guide or consult a properly licensed contractor, architect and/or design professional.

**STEP 2**

Attach steam piping to the 3/4" NPT opening on the top of the linear steam head.

**STEP 3**

After the finished wall surface has been installed use high temperature caulking around the steam outlet as required to make a water proof seal.

*For illustrative purposes only. Consult with qualified designer, architect or contractor for steamroom construction details.*

**⚠WARNING** The information in this guide is designed to provide a general overview of how MrSteam® products are installed. All images and diagrams are for illustrative purposes only and may have been altered for presentation purposes. NEVER use this document for the Installation, Operation or Maintenance of any MrSteam® product. For installation, operation and maintenance information and instructions, only use the applicable MrSteam® Installation, Operation & Maintenance Manual(s). The specific Installation, Operation & Maintenance manual that is supplied with each MrSteam® product contains important information required for the safe and reliable installation and operation of the product. Failure to install any MrSteam® product according to the applicable manual may result in property damage, an inoperable system/control, or hazardous condition. If you do not have the applicable Installation, Operation & Maintenance manual please contact MrSteam® for a free copy, or download a copy from [www.mrsteam.com](http://www.mrsteam.com). If you have any questions about the installation, operation or maintenance of any MrSteam® product please contact a customer or technical service representative using the contact information on the back cover of this guide or consult a properly licensed contractor, architect and/or design professional.

## FACEPLATE

FIGURE 1

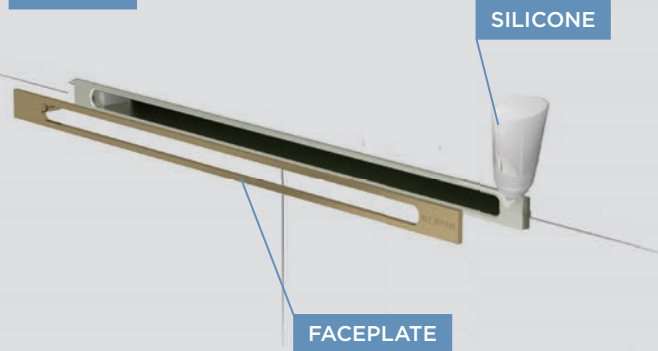

### STEP 1

Securely press Faceplate into the opening of Linear Steam Head (Figure 1).

### STEP 2

Apply silicone (supplied) in gap between the steam head and the tile as required to create a moisture seal. Failure to create a moisture seal may result in a leak within the wall cavity and cause problems associated with leaks, moisture and property damage from leaks (Figure 2).

FIGURE 2

APPLY SILICONE  
IN GAP

## DIVERTER

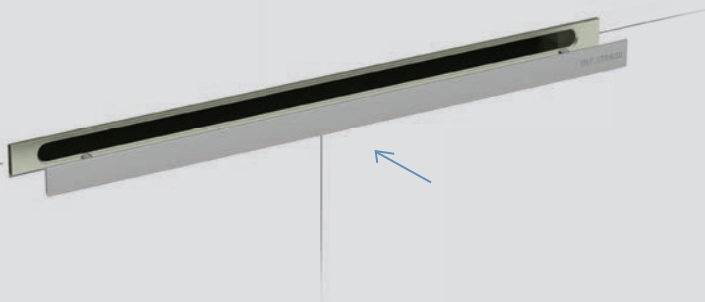

*For illustrative purposes only. Consult with qualified designer, architect or contractor for steamroom construction details.*

### STEP 1

Never install, remove or adjust a diverter into the linear steam head when the steam head is hot or if steam is turned on. Installing, removing or adjusting a diverter into the linear steam head when the steam head is hot or if steam is turned on may cause a burn hazard and personal injury.

**NOTE: BECAUSE DIRECT STEAM EMISSION IS VERY HOT, DIVERTER WILL BECOME HOT DURING STEAM SESSION, AND WILL REMAIN HOT FOR A PERIOD OF TIME AFTER STEAM SESSION.**

**⚠️WARNING** The information in this guide is designed to provide a general overview of how MrSteam® products are installed. All images and diagrams are for illustrative purposes only and may have been altered for presentation purposes. NEVER use this document for the Installation, Operation or Maintenance of any MrSteam® product. For installation, operation and maintenance information and instructions, only use the applicable MrSteam® Installation, Operation & Maintenance Manual(s). The specific Installation, Operation & Maintenance manual that is supplied with each MrSteam® product contains important information required for the safe and reliable installation and operation of the product. Failure to install any MrSteam® product according to the applicable manual may result in property damage, an inoperable system/control, or hazardous condition. If you do not have the applicable Installation, Operation & Maintenance manual please contact MrSteam® for a free copy, or download a copy from [www.mrsteam.com](http://www.mrsteam.com). If you have any questions about the installation, operation or maintenance of any MrSteam® product please contact a customer or technical service representative using the contact information on the back cover of this guide or consult a properly licensed contractor, architect and/or design professional.



## AROMATRAY

The AromaTray is designed to be inserted horizontally into the Linear SteamHead face plate or clipped on to the Diverter plate and used in the vertical position

### STEP 1

Place Aroma Tray in steam outlet of Linear Steam Head (Figure 1) or on Diverter. (Figure 2) Place a drop or two of AromaSteam™ essential oil in AromaTray.

FIGURE 1



FIGURE 2

**NOTE: THE AROMATRAY WILL BECOME HOT DURING A STEAM BATH SESSION, AND WILL REMAIN HOT FOR A PERIOD OF TIME AFTER THE STEAM BATH SESSION.**

*For illustrative purposes only. Consult with qualified designer, architect or contractor for steamroom construction details.*

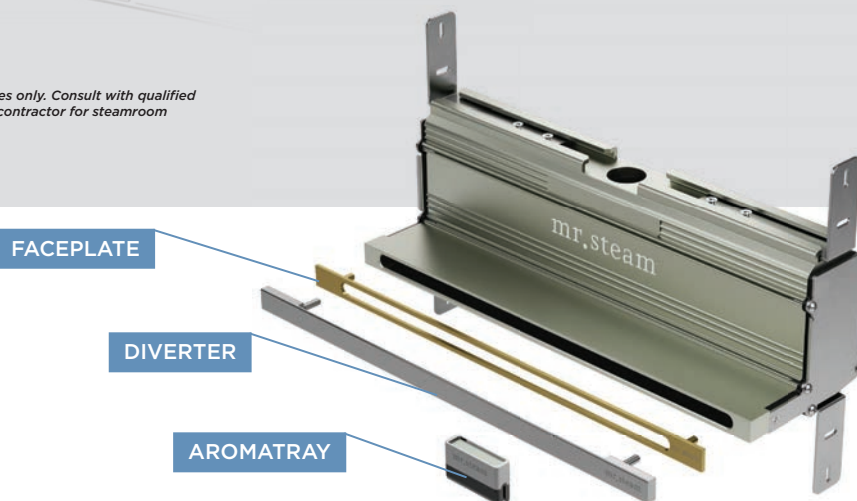

**⚠WARNING** The information in this guide is designed to provide a general overview of how MrSteam® products are installed. All images and diagrams are for illustrative purposes only and may have been altered for presentation purposes. NEVER use this document for the Installation, Operation or Maintenance of any MrSteam® product. For installation, operation and maintenance information and instructions, only use the applicable MrSteam® Installation, Operation & Maintenance Manual(s). The specific Installation, Operation & Maintenance manual that is supplied with each MrSteam® product contains important information required for the safe and reliable installation and operation of the product. Failure to install any MrSteam® product according to the applicable manual may result in property damage, an inoperable system/control, or hazardous condition. If you do not have the applicable Installation, Operation & Maintenance manual please contact MrSteam® for a free copy, or download a copy from [www.mrsteam.com](http://www.mrsteam.com). If you have any questions about the installation, operation or maintenance of any MrSteam® product please contact a customer or technical service representative using the contact information on the back cover of this guide or consult a properly licensed contractor, architect and/or design professional.

## CHROMASTEAMX

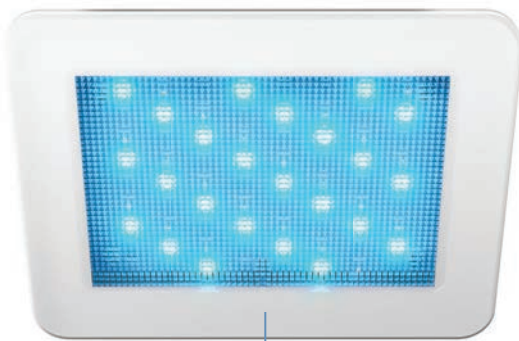

LED FIXTURE

CHROMAX  
CONTROL BOX

**NOTE: FOR MOOD LIGHTING ONLY.**

### STEP 1

Locating the ChromaX Control Box. Determine the desired location of the ChromaSteamX control box outside the steam room in a dry location.

### STEP 2

Installing the ChromaX Control Box. Using screws and washers, affix the ChromaX Control Box to a stable vertical surface (e.g., stud) using the mounting holes on either side of the ChromaX Control Box (Figure 1).

FIGURE 1



FIGURE 2

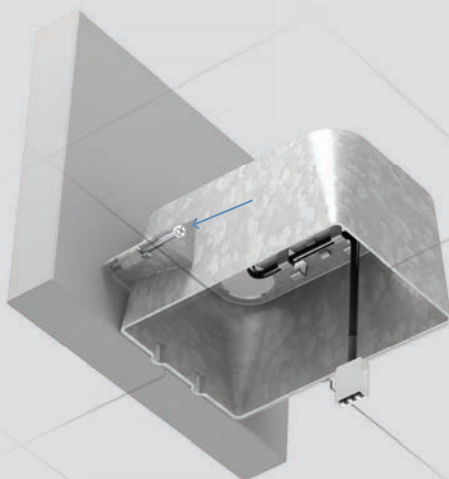

*For illustrative purposes only. Consult with qualified designer, architect or contractor for steamroom construction details.*

### STEP 3

Install junction box. Remove one of the four knockouts from the junction box. The resulting hole will allow routing of the 30-foot LED power cable into the junction box. Locate the two tabs on the junction box, and line them up against a ceiling joist. The tabs locate the junction box proud of (slightly raised from) the joist. Screw the two screws into the ceiling joist to secure the junction box (Figure 2).

**⚠WARNING** The information in this guide is designed to provide a general overview of how MrSteam® products are installed. All images and diagrams are for illustrative purposes only and may have been altered for presentation purposes. NEVER use this document for the Installation, Operation or Maintenance of any MrSteam® product. For installation, operation and maintenance information and instructions, only use the applicable MrSteam® Installation, Operation & Maintenance Manual(s). The specific Installation, Operation & Maintenance manual that is supplied with each MrSteam® product contains important information required for the safe and reliable installation and operation of the product. Failure to install any MrSteam® product according to the applicable manual may result in property damage, an inoperable system/control, or hazardous condition. If you do not have the applicable Installation, Operation & Maintenance manual please contact MrSteam® for a free copy, or download a copy from [www.mrsteam.com](http://www.mrsteam.com). If you have any questions about the installation, operation or maintenance of any MrSteam® product please contact a customer or technical service representative using the contact information on the back cover of this guide or consult a properly licensed contractor, architect and/or design professional.

**STEP 4**

Connect the ChromaSteamX fixture's pigtail to the 30-foot LED power cable in the junction box (Figure 3).

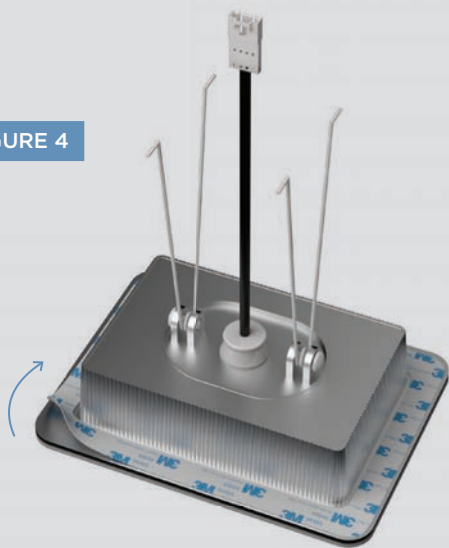
**FIGURE 4****STEP 6**

Squeeze the retention springs on the back of the fixture and fit them into the junction box (Figure 5). Insert the fixture into the junction box and affix it to the ceiling, being careful not to pinch the pigtail/LED power cable. Press firmly around edges of the fixture to ensure adhesion to ceiling.

**FIGURE 6****FIGURE 3****STEP 5**

Clean the surface of the ceiling to ensure the double-stick adhesive of the fixture bonds completely to the ceiling. Peel off and discard the protective layer from the fixture's double-stick adhesive (Figure 4).

**FIGURE 5****STEP 7**

Apply a bead of silicone around the perimeter of the fixture (Figure 6) as required to create a moisture seal between the fixture and the steam room ceiling.

*For illustrative purposes only. Consult with qualified designer, architect or contractor for steamroom construction details.*

**⚠WARNING** The information in this guide is designed to provide a general overview of how MrSteam® products are installed. All images and diagrams are for illustrative purposes only and may have been altered for presentation purposes. NEVER use this document for the installation, operation or maintenance of any MrSteam® product. For installation, operation and maintenance information and instructions, only use the applicable MrSteam® Installation, Operation & Maintenance Manual(s). The specific Installation, Operation & Maintenance manual that is supplied with each MrSteam® product contains important information required for the safe and reliable installation and operation of the product. Failure to install any MrSteam® product according to the applicable manual may result in property damage, an inoperable system/control, or hazardous condition. If you do not have the applicable Installation, Operation & Maintenance manual please contact MrSteam® for a free copy, or download a copy from [www.mrsteam.com](http://www.mrsteam.com). If you have any questions about the installation, operation or maintenance of any MrSteam® product please contact a customer or technical service representative using the contact information on the back cover of this guide or consult a properly licensed contractor, architect and/or design professional.



**STEP 8**

Plug the accessory communication cable into port labeled HUB on the ChromaX Control Box (A in Figure 7).

**STEP 9**

Plug the FREE END of the accessory communication cable into any of the accessory ports on the iSteam®X Hub (B in Figure 7).

**STEP 10**

Plug in the power supply provided with ChromaSteamX into the (C in Figure 7) ChromaSteamX control box port marked 12 VDC.

**STEP 11**

Plug the power supply into a standard outlet (D in Figure 7).

**CAUTION: CHROMASTEAMX IS FOR MOOD LIGHTING ONLY, AND DOES NOT SUBSTITUTE FOR GENERAL SHOWER ILLUMINATION.**

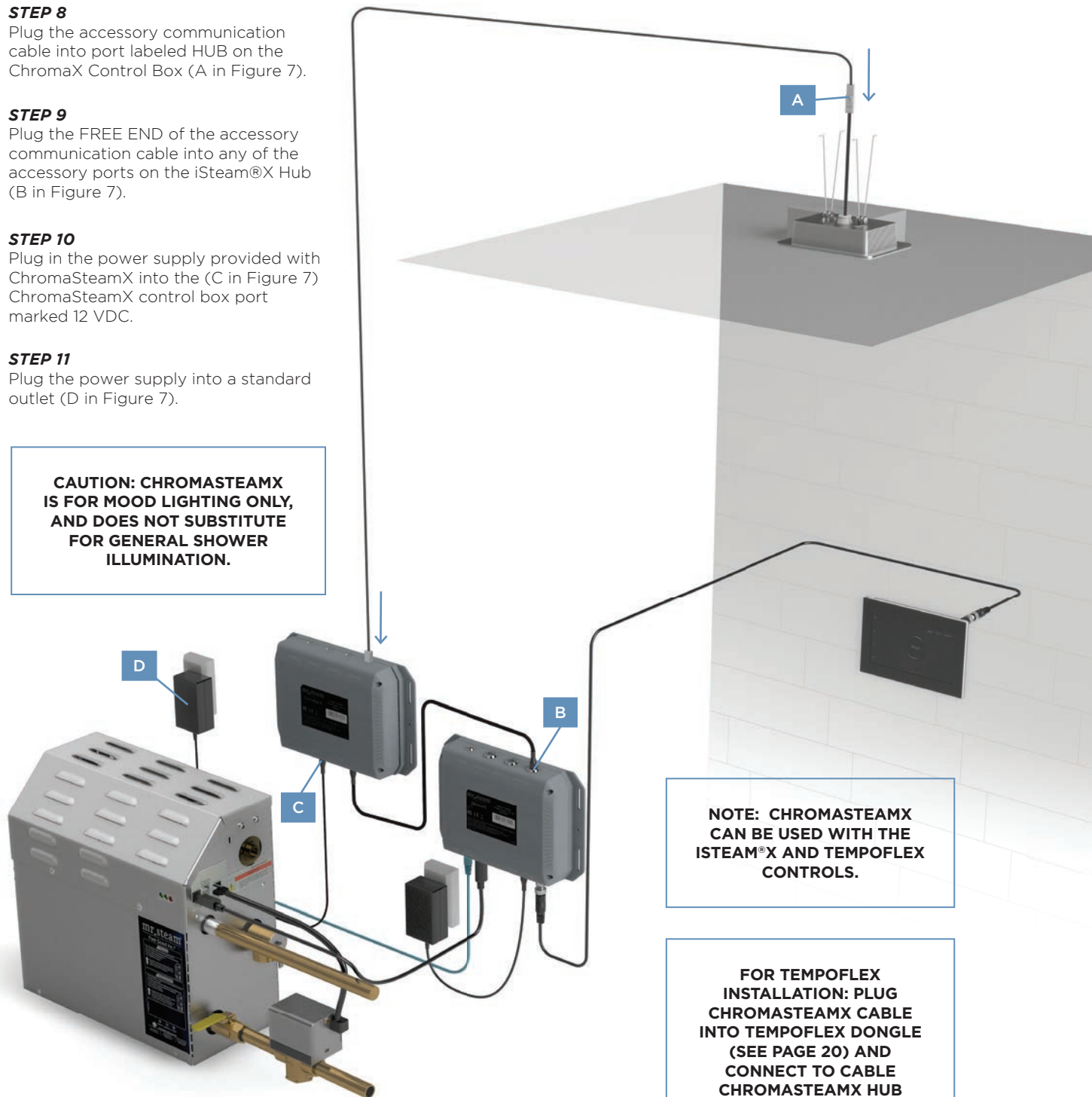
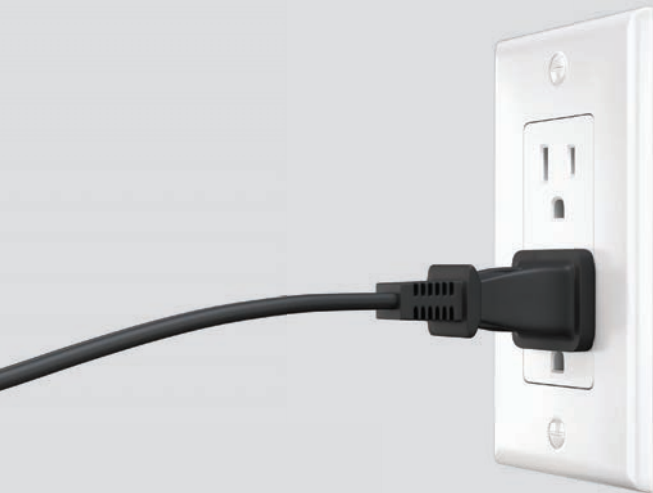

FIGURE 7

**⚠WARNING** The information in this guide is designed to provide a general overview of how MrSteam® products are installed. All images and diagrams are for illustrative purposes only and may have been altered for presentation purposes. NEVER use this document for the Installation, Operation or Maintenance of any MrSteam® product. For installation, operation and maintenance information and instructions, only use the applicable MrSteam® Installation, Operation & Maintenance Manual(s). The specific Installation, Operation & Maintenance manual that is supplied with each MrSteam® product contains important information required for the safe and reliable installation and operation of the product. Failure to install any MrSteam® product according to the applicable manual may result in property damage, an inoperable system/control, or hazardous condition. If you do not have the applicable Installation, Operation & Maintenance manual please contact MrSteam® for a free copy, or download a copy from [www.mrsteam.com](http://www.mrsteam.com). If you have any questions about the installation, operation or maintenance of any MrSteam® product please contact a customer or technical service representative using the contact information on the back cover of this guide or consult a properly licensed contractor, architect and/or design professional.

## AUDIO X SYSTEM

- The AudioX System is a Bluetooth enabled innovation in wet and warm environment audio.
- Comes with two 60-watt peak power speakers specially designed for use inside or outside the shower enclosure.
- AudioX speakers are 7.5" square with a 5" mounting depth, designed to be flush mounted on the wall or ceiling, with marine-grade, powder-coated grills.
- Use only CL2 or CL3 UL listed wires to connect speakers to audio source.



### STEP 1

Locate 120v power outlet withing 6 feet of first AudioX speaker.

**⚠WARNING** The information in this guide is designed to provide a general overview of how MrSteam® products are installed. All images and diagrams are for illustrative purposes only and may have been altered for presentation purposes. NEVER use this document for the Installation, Operation or Maintenance of any MrSteam® product. For installation, operation and maintenance information and instructions, only use the applicable MrSteam® Installation, Operation & Maintenance Manual(s). The specific Installation, Operation & Maintenance manual that is supplied with each MrSteam® product contains important information required for the safe and reliable installation and operation of the product. Failure to install any MrSteam® product according to the applicable manual may result in property damage, an inoperable system/control, or hazardous condition. If you do not have the applicable Installation, Operation & Maintenance manual please contact MrSteam® for a free copy, or download a copy from [www.mrsteam.com](http://www.mrsteam.com). If you have any questions about the installation, operation or maintenance of any MrSteam® product please contact a customer or technical service representative using the contact information on the back cover of this guide or consult a properly licensed contractor, architect and/or design professional.



**STEP 2**

Determine the location of the speakers and cut the appropriate size and shape.

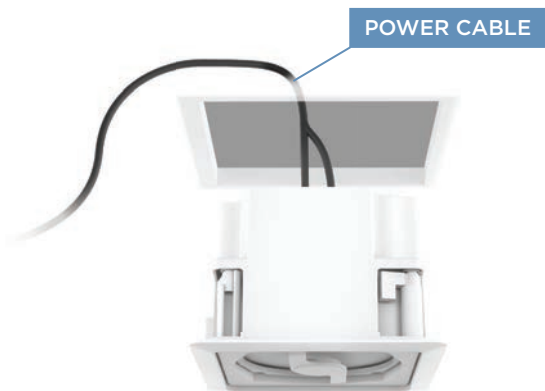

**STEP 3**

Pass the power cable through the hole and remove speaker cover grill



**STEP 4**

Apply a bead of silicone around the perimeter of the fixture as required to create a moisture seal between the fixture and the steam room ceiling.

**⚠WARNING** The information in this guide is designed to provide a general overview of how MrSteam® products are installed. All images and diagrams are for illustrative purposes only and may have been altered for presentation purposes. NEVER use this document for the Installation, Operation or Maintenance of any MrSteam® product. For installation, operation and maintenance information and instructions, only use the applicable MrSteam® Installation, Operation & Maintenance Manual(s). The specific Installation, Operation & Maintenance manual that is supplied with each MrSteam® product contains important information required for the safe and reliable installation and operation of the product. Failure to install any MrSteam® product according to the applicable manual may result in property damage, an inoperable system/control, or hazardous condition. If you do not have the applicable Installation, Operation & Maintenance manual please contact MrSteam® for a free copy, or download a copy from [www.mrsteam.com](http://www.mrsteam.com). If you have any questions about the installation, operation or maintenance of any MrSteam® product please contact a customer or technical service representative using the contact information on the back cover of this guide or consult a properly licensed contractor, architect and/or design professional.



**STEP 5**

Use a screwdriver to make the mechanism rotate behind the ceiling drywall.

**SCREWDRIVER****COVER GRILL****STEP 6**

Fit the speaker cover grill.

**⚠WARNING** The information in this guide is designed to provide a general overview of how MrSteam® products are installed. All images and diagrams are for illustrative purposes only and may have been altered for presentation purposes. NEVER use this document for the Installation, Operation or Maintenance of any MrSteam® product. For installation, operation and maintenance information and instructions, only use the applicable MrSteam® Installation, Operation & Maintenance Manual(s). The specific Installation, Operation & Maintenance manual that is supplied with each MrSteam® product contains important information required for the safe and reliable installation and operation of the product. Failure to install any MrSteam® product according to the applicable manual may result in property damage, an inoperable system/control, or hazardous condition. If you do not have the applicable Installation, Operation & Maintenance manual please contact MrSteam® for a free copy, or download a copy from [www.mrsteam.com](http://www.mrsteam.com). If you have any questions about the installation, operation or maintenance of any MrSteam® product please contact a customer or technical service representative using the contact information on the back cover of this guide or consult a properly licensed contractor, architect and/or design professional.



Available in Square (7") in both white and black designs.

**⚠WARNING** The information in this guide is designed to provide a general overview of how MrSteam® products are installed. All images and diagrams are for illustrative purposes only and may have been altered for presentation purposes. NEVER use this document for the Installation, Operation or Maintenance of any MrSteam® product. For installation, operation and maintenance information and instructions, only use the applicable MrSteam® Installation, Operation & Maintenance Manual(s). The specific Installation, Operation & Maintenance manual that is supplied with each MrSteam® product contains important information required for the safe and reliable installation and operation of the product. Failure to install any MrSteam® product according to the applicable manual may result in property damage, an inoperable system/control, or hazardous condition. If you do not have the applicable Installation, Operation & Maintenance manual please contact MrSteam® for a free copy, or download a copy from [www.mrsteam.com](http://www.mrsteam.com). If you have any questions about the installation, operation or maintenance of any MrSteam® product please contact a customer or technical service representative using the contact information on the back cover of this guide or consult a properly licensed contractor, architect and/or design professional.

## SHOWER SEAT

### STEP 1

Mount the WallSeat on a suitable surface like tile, granite or marble. Mount the seat at a height above the floor according to personal preference.

### STEP 2

Using the template provided, drill four pilot holes into the header and 4 clearance holes into the tile. Use a level to ensure pilot holes are level. Be precise.

Do not oversize or undersize the pilot holes. Drill the pilot holes to the full 3" depth (length of the screws).

Fill the mounting holes with silicone (provided) before mounting the brackets to the wall as required to prevent moisture from penetrating into the wall and/or wall cavity.



FIGURE 1

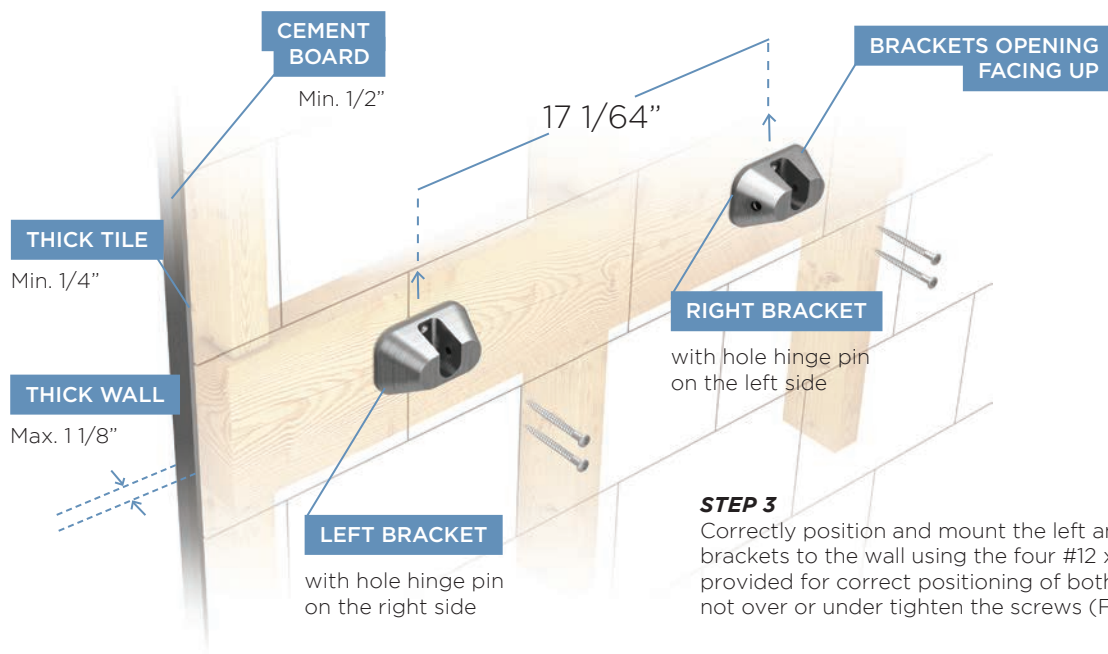

### STEP 3

Correctly position and mount the left and right brackets to the wall using the four #12 x 3" screws provided for correct positioning of both brackets. Do not over or under tighten the screws (Figure 1).

*For illustrative purposes only. Consult with qualified designer, architect or contractor for steamroom construction details.*

**⚠WARNING** The information in this guide is designed to provide a general overview of how MrSteam® products are installed. All images and diagrams are for illustrative purposes only and may have been altered for presentation purposes. NEVER use this document for the Installation, Operation or Maintenance of any MrSteam® product. For installation, operation and maintenance information and instructions, only use the applicable MrSteam® Installation, Operation & Maintenance Manual(s). The specific Installation, Operation & Maintenance manual that is supplied with each MrSteam® product contains important information required for the safe and reliable installation and operation of the product. Failure to install any MrSteam® product according to the applicable manual may result in property damage, an inoperable system/control, or hazardous condition. If you do not have the applicable Installation, Operation & Maintenance manual please contact MrSteam® for a free copy, or download a copy from [www.mrsteam.com](http://www.mrsteam.com). If you have any questions about the installation, operation or maintenance of any MrSteam® product please contact a customer or technical service representative using the contact information on the back cover of this guide or consult a properly licensed contractor, architect and/or design professional.



FIGURE 2

**STEP 4**

Insert seat assembly to brackets. Place seat with the MrSteam logo on the bottom. Insert hinge pins to both left and right brackets while the seat assembly is in vertical position. Securely tighten both hinge pins, using Allen wrench provided (Figure 2).

FIGURE 3

LEVEL  
SCREW**STEP 5**

If the seat is not parallel to the floor when it is in the lowered or seated position use the allen wrench provided to adjust both level screws so the wallseat is parallel to the floor and it contacts both brackets at the same time (Figure 3).

FIGURE 4



**⚠WARNING** The information in this guide is designed to provide a general overview of how MrSteam® products are installed. All images and diagrams are for illustrative purposes only and may have been altered for presentation purposes. NEVER use this document for the Installation, Operation or Maintenance of any MrSteam® product. For installation, operation and maintenance information and instructions, only use the applicable MrSteam® Installation, Operation & Maintenance Manual(s). The specific Installation, Operation & Maintenance manual that is supplied with each MrSteam® product contains important information required for the safe and reliable installation and operation of the product. Failure to install any MrSteam® product according to the applicable manual may result in property damage, an inoperable system/control, or hazardous condition. If you do not have the applicable Installation, Operation & Maintenance manual please contact MrSteam® for a free copy, or download a copy from [www.mrsteam.com](http://www.mrsteam.com). If you have any questions about the installation, operation or maintenance of any MrSteam® product please contact a customer or technical service representative using the contact information on the back cover of this guide or consult a properly licensed contractor, architect and/or design professional.



## STEAMLINX® MODULE AND MOBILE APP

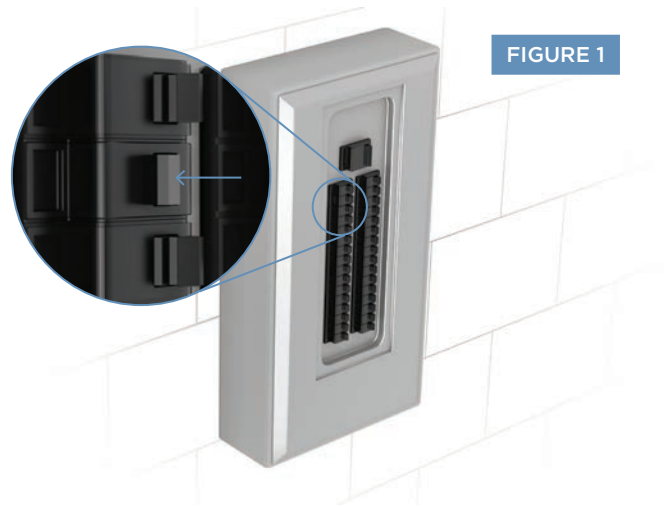

FIGURE 1

### STEP 1

Disconnect power to the generator at the breaker box (Figure 1).

### STEP 2

Locate SteamLinx A adjacent to the steam generator and mount to a secure surface using the mounting tab provided (Figure 2).

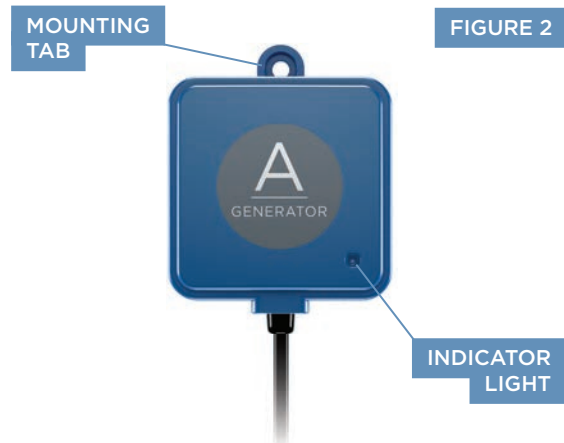
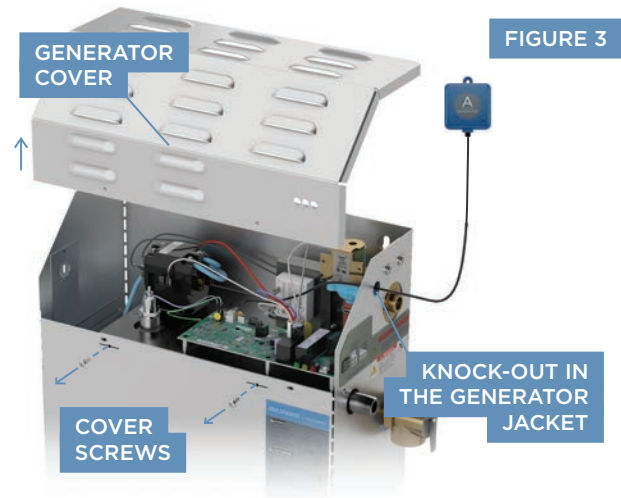

FIGURE 2

**⚠WARNING** The information in this guide is designed to provide a general overview of how MrSteam® products are installed. All images and diagrams are for illustrative purposes only and may have been altered for presentation purposes. NEVER use this document for the Installation, Operation or Maintenance of any MrSteam® product. For installation, operation and maintenance information and instructions, only use the applicable MrSteam® Installation, Operation & Maintenance Manual(s). The specific Installation, Operation & Maintenance manual that is supplied with each MrSteam® product contains important information required for the safe and reliable installation and operation of the product. Failure to install any MrSteam® product according to the applicable manual may result in property damage, an inoperable system/control, or hazardous condition. If you do not have the applicable Installation, Operation & Maintenance manual please contact MrSteam® for a free copy, or download a copy from [www.mrsteam.com](http://www.mrsteam.com). If you have any questions about the installation, operation or maintenance of any MrSteam® product please contact a customer or technical service representative using the contact information on the back cover of this guide or consult a properly licensed contractor, architect and/or design professional.

**STEP 3**

Remove generator cover. Route the SteamLinX® A cable through the knockout (Figure 3).

**STEP 4**

Plug the SteamLinX® A cable into one of the white connectors located at the far left side of the circuit board. Replace cover and screws.

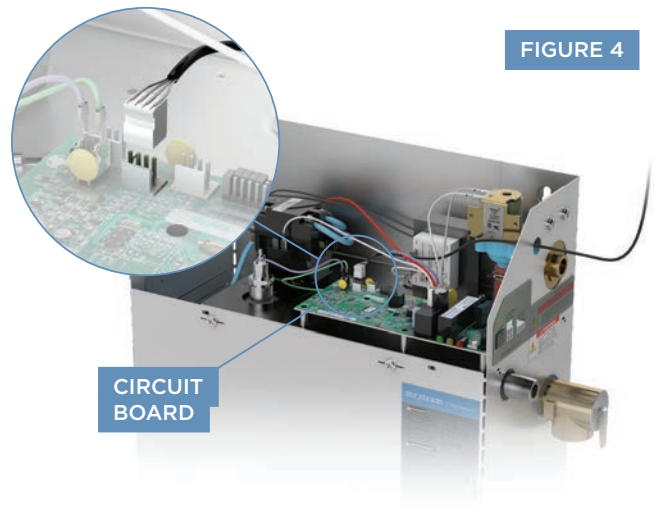
**STEP 5**

Plug the blue ethernet cable provided into an open ethernet port on the back of the router and the other end into SteamLinX® B. Plug the power supply into a 120V outlet (Figure 5).

**STEP 6**

Ensure the mobile device is connected to the router's WiFi network. Download the SteamLinX® App from the App Store or Google Play.

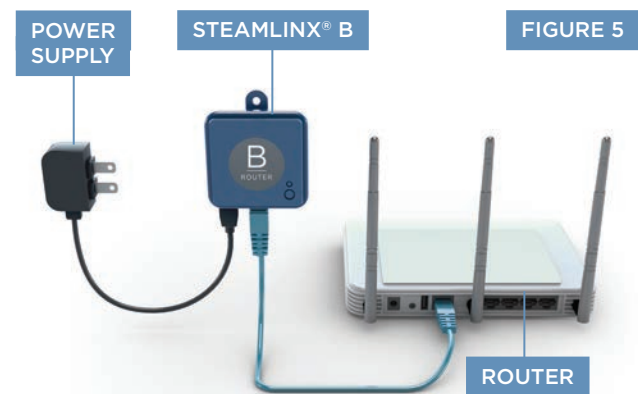

**⚠WARNING** The information in this guide is designed to provide a general overview of how MrSteam® products are installed. All images and diagrams are for illustrative purposes only and may have been altered for presentation purposes. NEVER use this document for the Installation, Operation or Maintenance of any MrSteam® product. For installation, operation and maintenance information and instructions, only use the applicable MrSteam® Installation, Operation & Maintenance Manual(s). The specific Installation, Operation & Maintenance manual that is supplied with each MrSteam® product contains important information required for the safe and reliable installation and operation of the product. Failure to install any MrSteam® product according to the applicable manual may result in property damage, an inoperable system/control, or hazardous condition. If you do not have the applicable Installation, Operation & Maintenance manual please contact MrSteam® for a free copy, or download a copy from [www.mrsteam.com](http://www.mrsteam.com). If you have any questions about the installation, operation or maintenance of any MrSteam® product please contact a customer or technical service representative using the contact information on the back cover of this guide or consult a properly licensed contractor, architect and/or design professional.

## TYPICAL INSTALL OF DREAM PACKAGE SCHEMATIC

- |          |                   |          |                      |
|----------|-------------------|----------|----------------------|
| <b>1</b> | Steamlinx®        | <b>5</b> | SteamHead            |
| <b>2</b> | ChromaSteamx Hub  | <b>6</b> | iSteam®X Control     |
| <b>3</b> | iSteam®X Hub      | <b>7</b> | ChromaSteamX Fixture |
| <b>4</b> | AromaSteam System | <b>8</b> | AudioX System        |

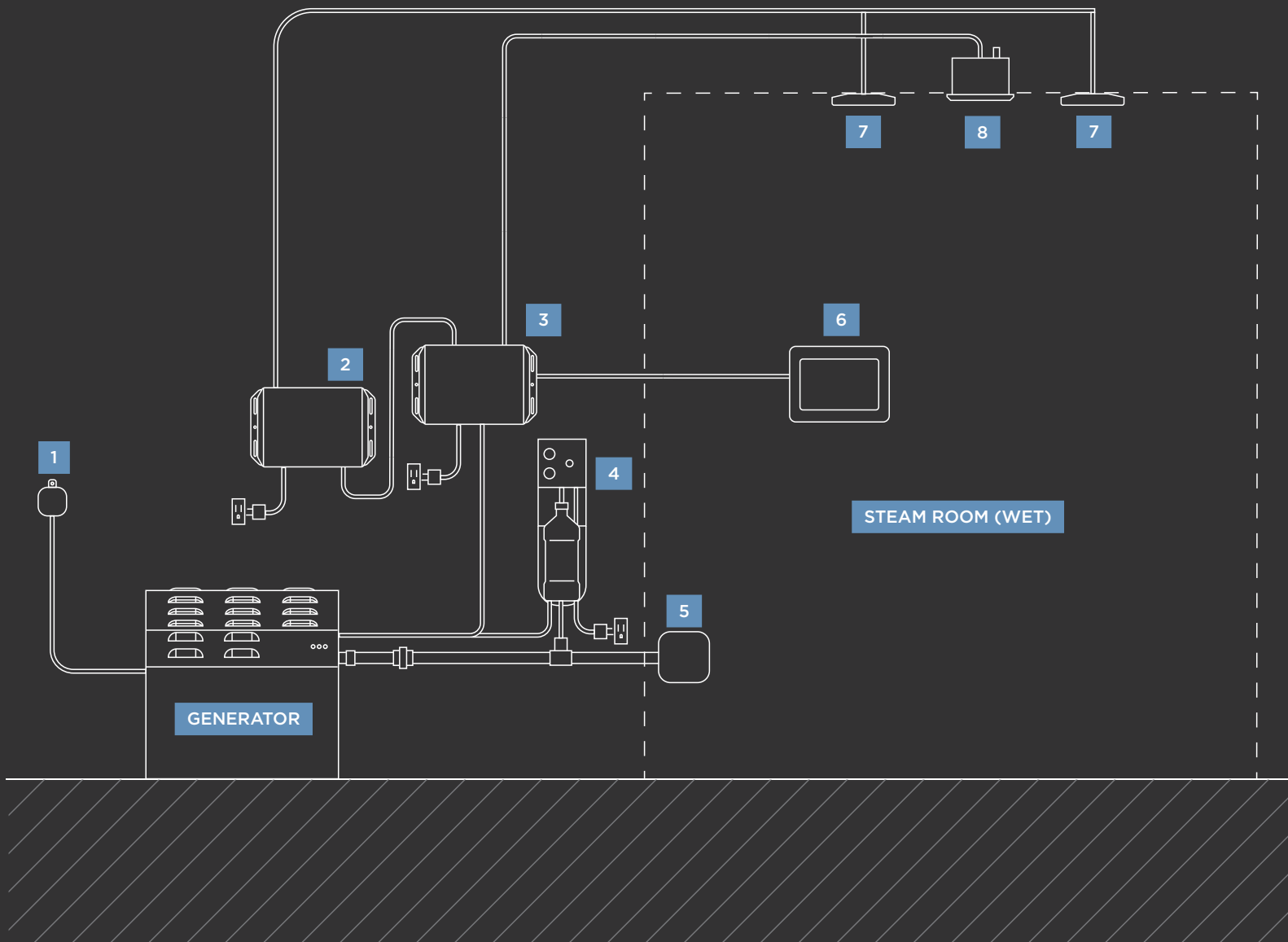

**⚠️ WARNING** The information in this guide is designed to provide a general overview of how MrSteam® products are installed. All images and diagrams are for illustrative purposes only and may have been altered for presentation purposes. NEVER use this document for the Installation, Operation or Maintenance of any MrSteam® product. For installation, operation and maintenance information and instructions, only use the applicable MrSteam® Installation, Operation & Maintenance Manual(s). The specific Installation, Operation & Maintenance manual that is supplied with each MrSteam® product contains important information required for the safe and reliable installation and operation of the product. Failure to install any MrSteam® product according to the applicable manual may result in property damage, an inoperable system/control, or hazardous condition. If you do not have the applicable Installation, Operation & Maintenance manual please contact MrSteam® for a free copy, or download a copy from [www.mrsteam.com](http://www.mrsteam.com). If you have any questions about the installation, operation or maintenance of any MrSteam® product please contact a customer or technical service representative using the contact information on the back cover of this guide or consult a properly licensed contractor, architect and/or design professional.



A leader and innovator in residential and commercial steam shower systems, spa products and experiences.

## CONTACT US

HEADQUARTERS  
MrSteam Corporation®  
43-20 34th Street  
Long Island City, NY. 11101 USA  
tel 1-800-76 STEAM (767-8326)

WEST COAST  
MrSteam Corporation®  
9410 South La Cienega Blvd  
Los Angeles, CA. 90301 USA  
tel 1-800-72 STEAM (727-8326)

Or write to us at [hello@mrsteam.com](mailto:hello@mrsteam.com)

Mr. Steam, Mr. Steam and des., TempoFlex®, A Lifetime of Pleasure, AromaBio, AutoFlush, Audio@Home, AutoSteam, Broadway Collection, Butler Package, ChromaSound Spa Package, ChromeSteamX, Clean Steam...Every Time, Club Therapy, Day Spa, Digital 1, Express Steam, Etempo, Etempo/Plus, Etempo/Start, Feel Good Inc., Fifth Avenue Collection, From Bathroom to Spa, HomeWizard, iButler, iDream Package, iGenie, iSpa Package, iSteamX, iTempo, iTempo/Plus, Linear, Linear Steamhead, Making Wellness a Way of Life, Metro Collection, Mrsauna, MusicTherapy, MySteam, Spa Package, Steam on Demand, Steam@Home, SmartSizing, Steam in a Box, SteamStart, SteamStop, SteamTherapy, Sussman, Tempo, Tala, The Intelligent SteamBath, Virtual Spa System, and Warmatowel are registered trademarks of MrSteam Corporation.

HomeWizard is a trademark of MrSteam Corporation.

\* Please refer to the applicable MrSteam Installation, Operation & Maintenance Manual, at [mrsteam.com](http://mrsteam.com), for installation, operation and maintenance information and instructions. Failure to do so may result in property damage or an inoperable or hazardous condition. For safety and convenience, consult a qualified contractor, architect and/or design professional.

See product packaging and labeling for important information.

Copyright 2025 MrSteam Corporation. All rights reserved.

PUR100537, Revision 06/2025

mr.steam®



[www.mrsteam.com](http://www.mrsteam.com)