



Installation, Operation & Maintenance Manual

Sauna Room Instructions

RMSDS46A: (83"H x 71"W x 48"D)

RMSDA56A: (83"H x 71"W x 60"D)

RMSDA57A: (83"H x 83"W x 60"D)

RMSDA66A: (83"H x 71"W x 71"D)

RMSDA67A: (83"H x 83"W x 71"D)

RMSDA68A: (83"H x 95"W x 71"D)

IMPORTANT: Leave this material with the home owner.

1. Preparations

- Sauna package must be stored in a heated and dry room.
- Prior to installation the package must be opened and stored for 48h to adjust to relative humidity of the room.
- Ensure the sauna model fits in the designated room with sufficient extra room for ease of installation.
- Clean the location of sauna with care in order to not damage any details, elements
- Room must be well ventilated and with water drain on or near the position of the sauna.
- Sauna is intended to be installed on a level surface to ensure proper installation and quality of the installed product.
- Adequate electrical supply must be ensured for electrical components of the sauna. Refer to user manuals of respective products.

 **WARNING** All Electrical wiring to be installed by a qualified licensed electrician in accordance with local and national electrical code.

 **WARNING** **DO NOT** paint or stain the inside of the sauna room, dangerous our gassing of paints or stain may occur at sauna temperatures.

IMPORTANT NOTE: Sauna rooms have a wax finish use only cleaners and waxes designed for sauna rooms.

 **WARNING** The sauna must be installed on a heat resistant floor like tile or concrete. MrSteam does not recommend installing the sauna on a wood Floor.

 **WARNING** **DO NOT** install the sauna on carpet, vinyl or laminate flooring.

IMPORTANT NOTE:
MrSteam sauna rooms are packaged with MrSteam heaters and sold as the following kits:
MSDA46AC4C1 includes the RMSDA46A rom with the SC04AC1 heater
MSDA56AC6C1 includes the RMSDA56A rom with the SC06AC1 heater
MSDA57AC6C1 includes the RMSDA57A rom with the SC06AC1 heater
MSDA66AC6C1 includes the RMSDA66A rom with the SC06AC1 heater
MSDA67AC9C1 includes the RMSDA67A rom with the SC09AC1 heater
MSDA68AC9C1 includes the RMSDA67A rom with the SC09AC1 heater

TABLE OF CONTENTS

Leave Space1
Tools Needed2
Base Frame3
Walls.....4
Multichip Closing System5
Fixing6-10
Interior11-12
Assistance Frames.....13
Bench Support Installing.....14-16
Removing Assistance Frames17
Wiring Inside Walls18
Connection LED-Strips.....19
Fixing Bench Skirt20
Backrest & Bench Grids21
Interior 1122
Heater Guard23
Wiring on Ceiling24
Electrical Connections25
Glass Wall.....26
Door27
Finishing Touches.....28
Completed Sauna29

 **WARNING**
REDUCE THE RISK OF OVERHEATING
1. Exit immediately if uncomfortable, dizzy, or sleepy. Staying too long in a heated area is capable of causing overheating.
2. Supervise children at all times.
3. Check with a doctor before use if pregnant, in poor health, or under medical care.
4. Breathing heated air in conjunction with consumption of alcohol, drugs, or medication is capable of causing unconsciousness.

L2342-1 Rev A

HYPERTHERMIA occurs when the internal temperature of the body reaches a level several degrees above the normal body temperature of 98.6°F. The symptoms of hyperthermia include an increase in the internal temperature of the body, dizziness, lethargy, drowsiness, and fainting. The effects of hyperthermia include:
a) Failure to perceive heat;
b) Failure to recognize the need to exit the room;
c) Unawareness of impending hazard;
d) Fetal damage in pregnant women;
e) Physical inability to exit the room; and
f) Unconsciousness.

Leave Space for Better Assembly

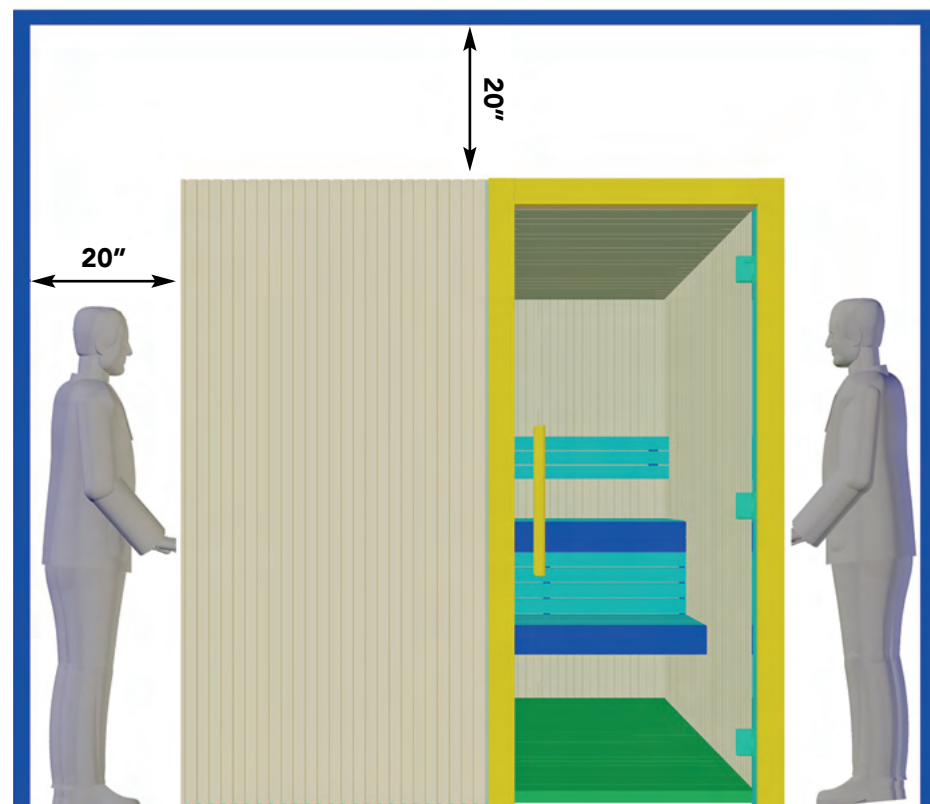
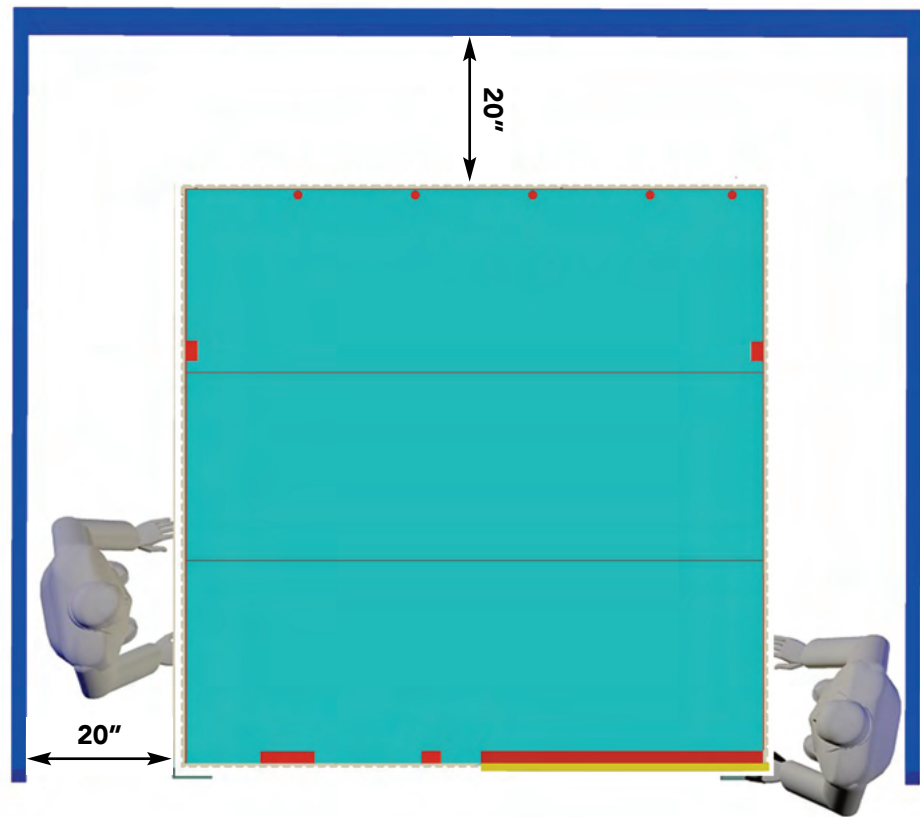

Tools Need



Measuring Tape

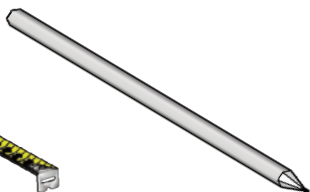

Marker Pen

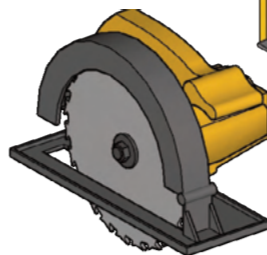

Circular Saw

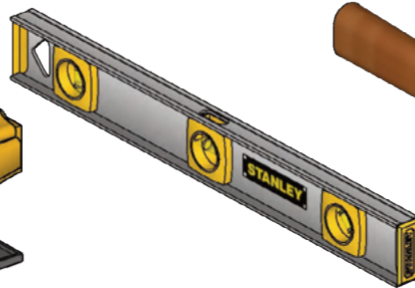

Water Level

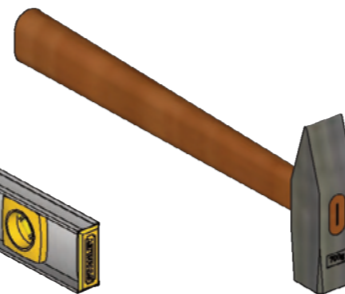

Hammer

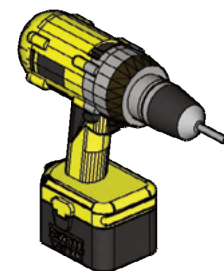

Drill

CAUTION Many steps in the construction require lifting heavy and or bulky items, MrSteam recommends construction be done by no less than two people



1. Base Frame

	x (in)	y (in)
RMSDA46A	83 1/4	69 5/8
RMSDA56A	90 1/4	1770
RMSDA57A	100 1/4	81 3/4
RMSDA66A	98 5/8	69 5/8
RMSDA67A	107 5/8	81 3/4
RMSDA68A	117 1/4	93 7/8

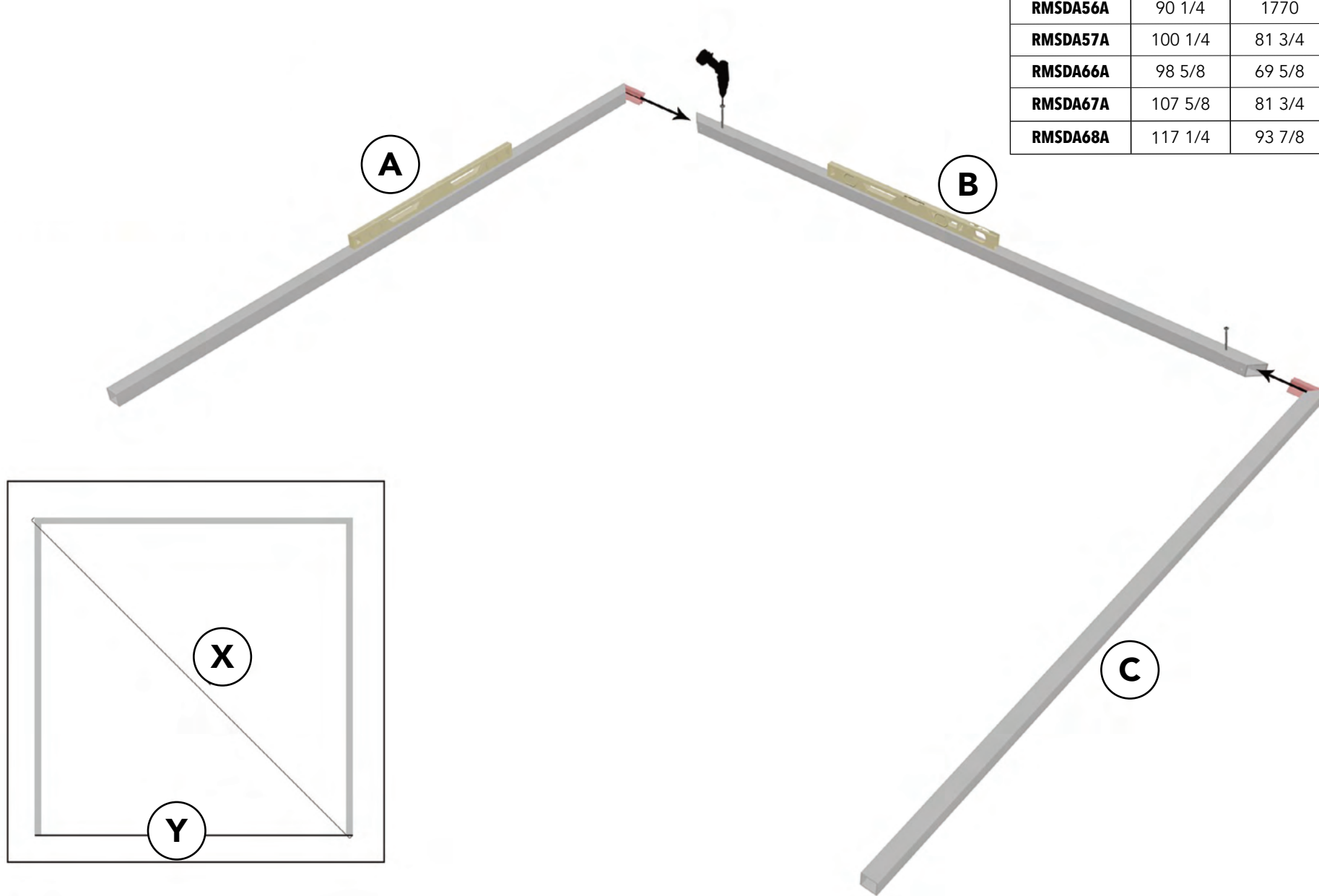

2. Walls

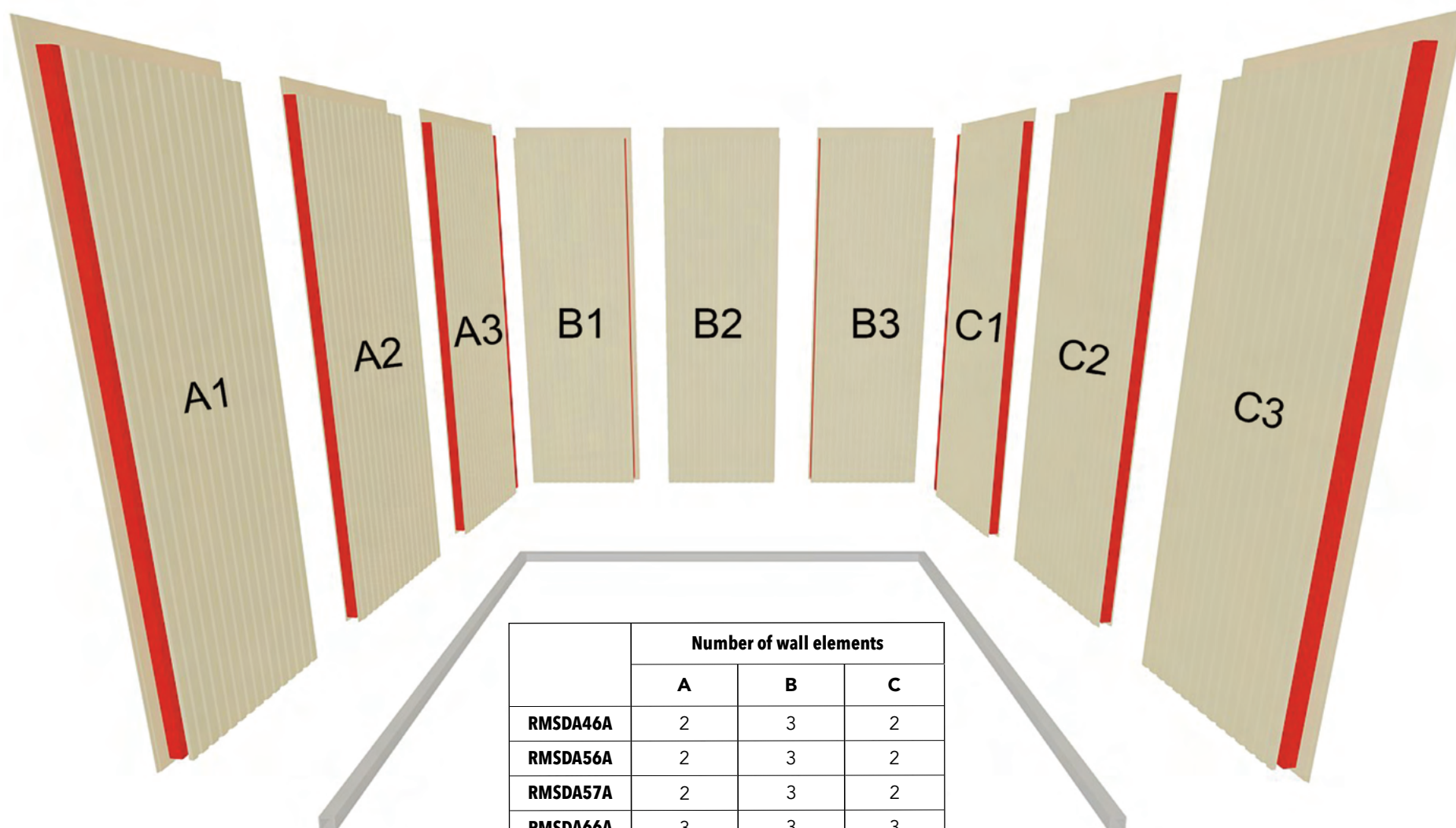

3. Multichip Closing System

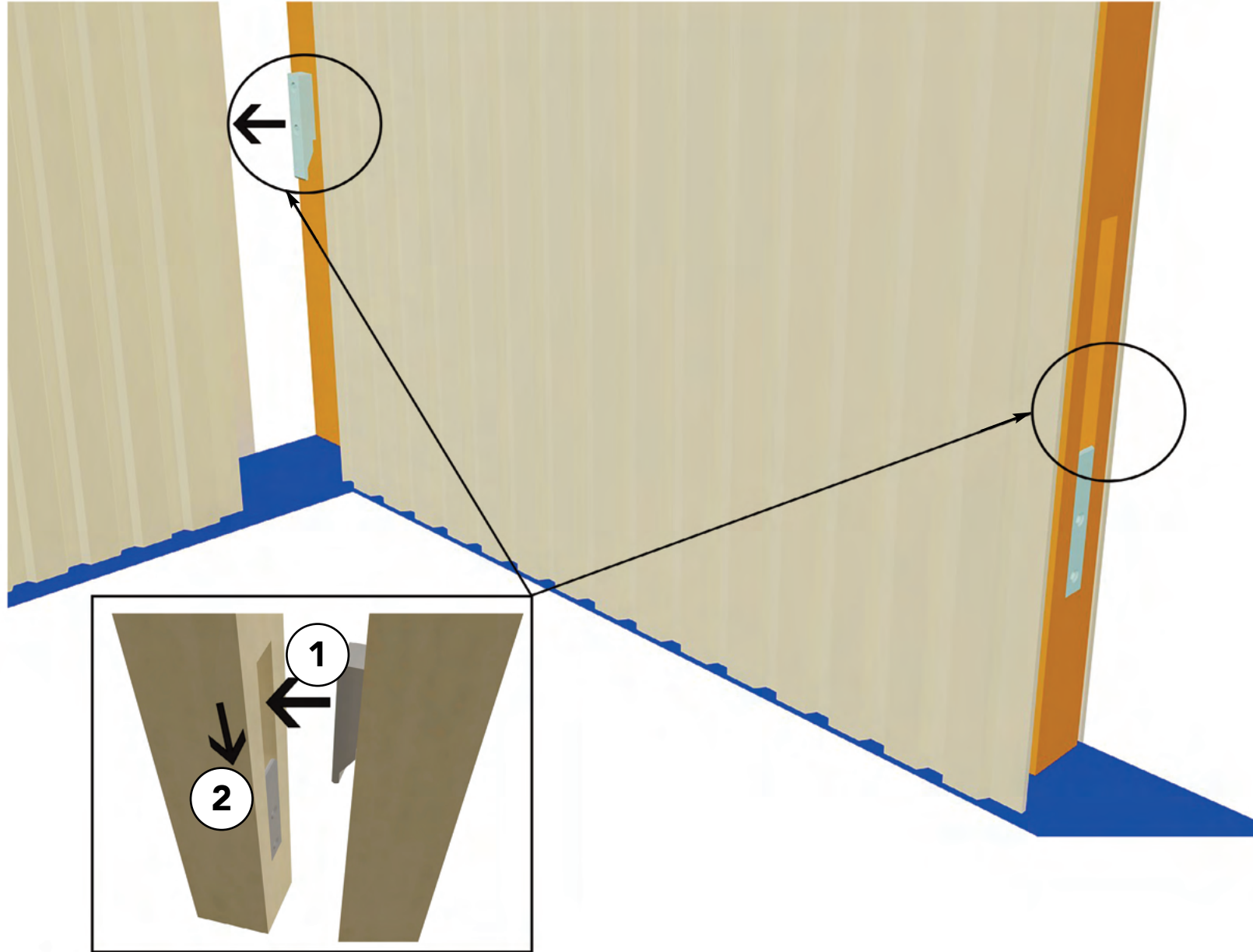

4. Fixing First Corner Walls

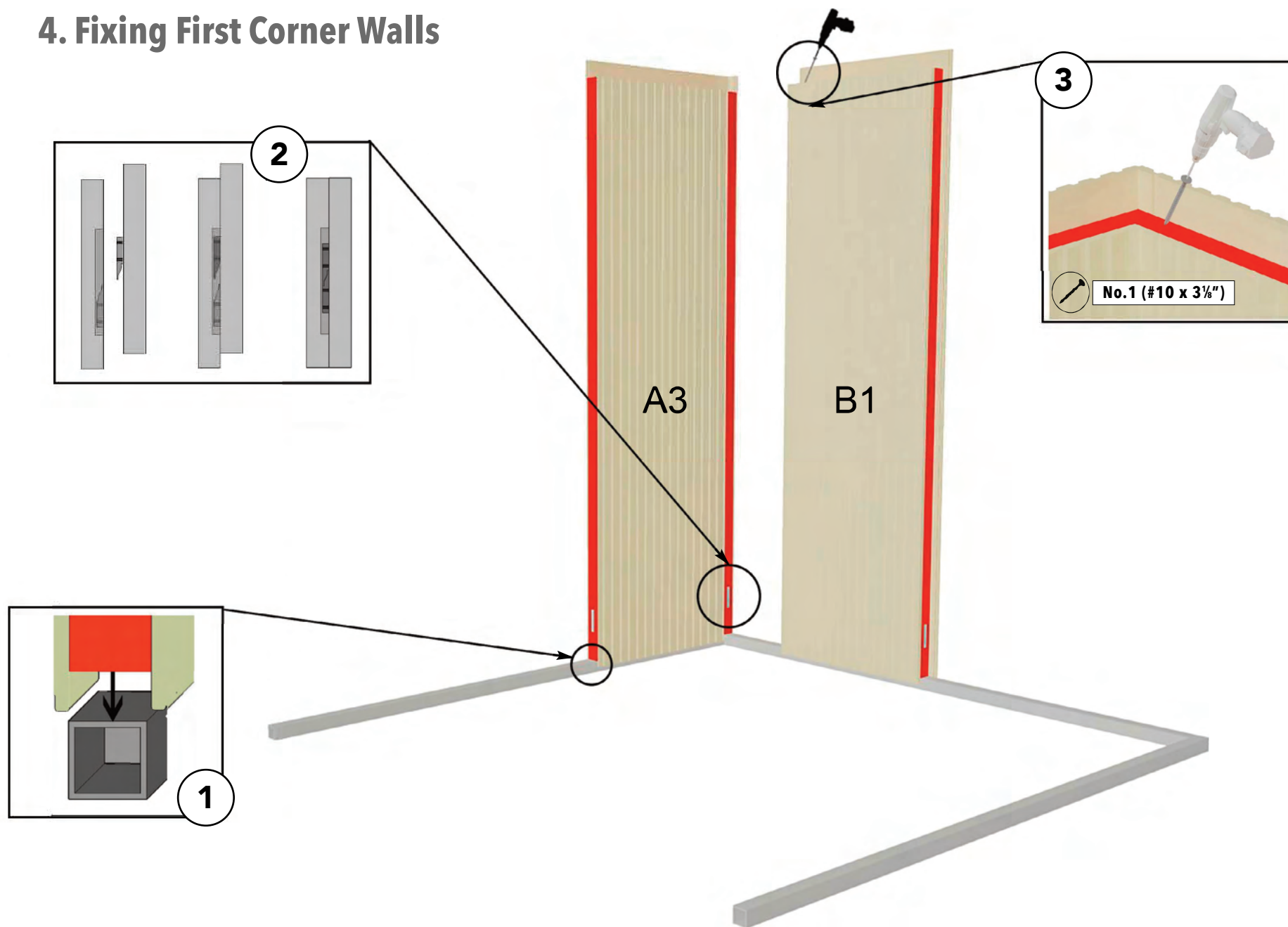

5. Fixing Walls A 1 & A2

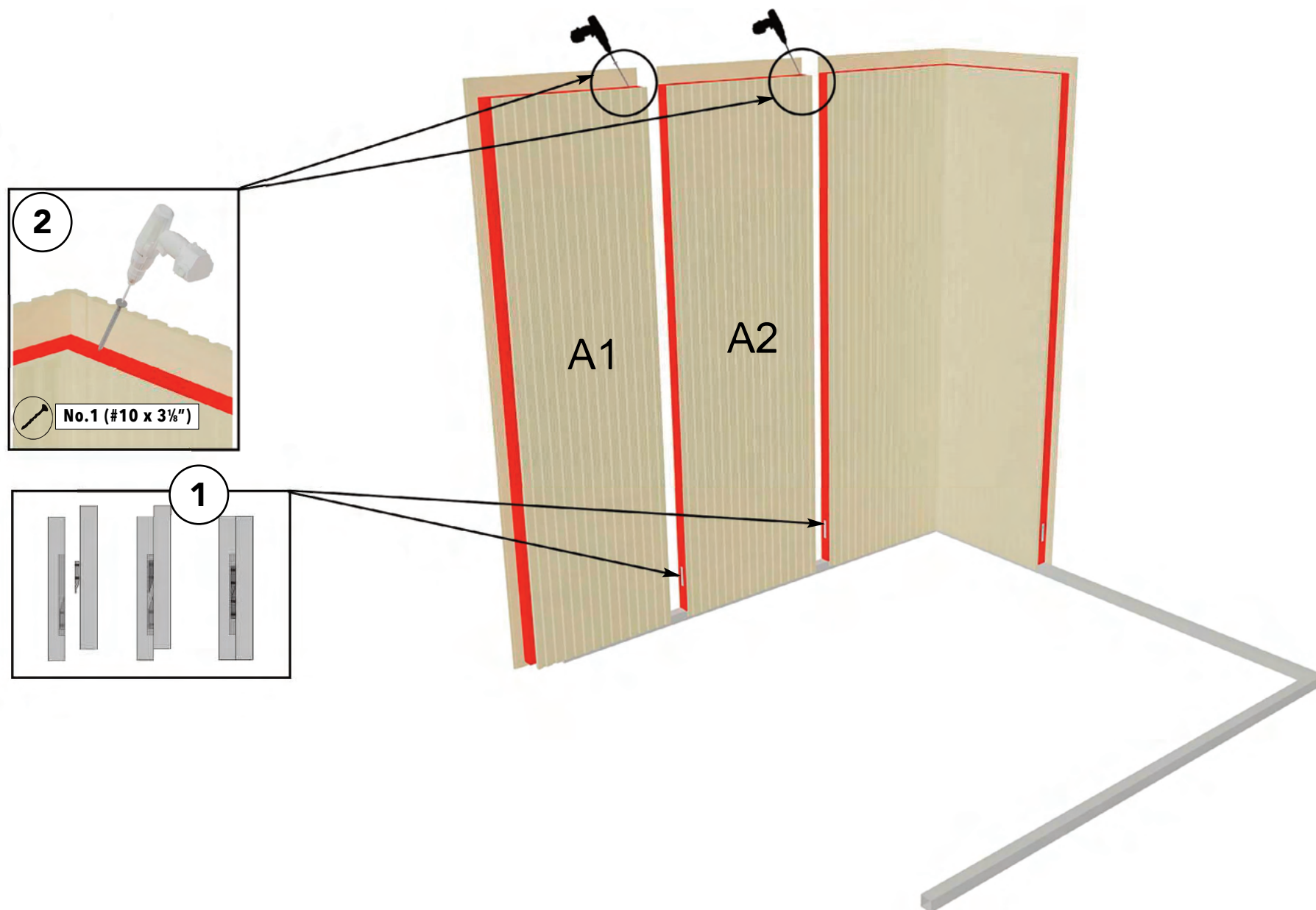

6. Fixing Walls B2 & 83

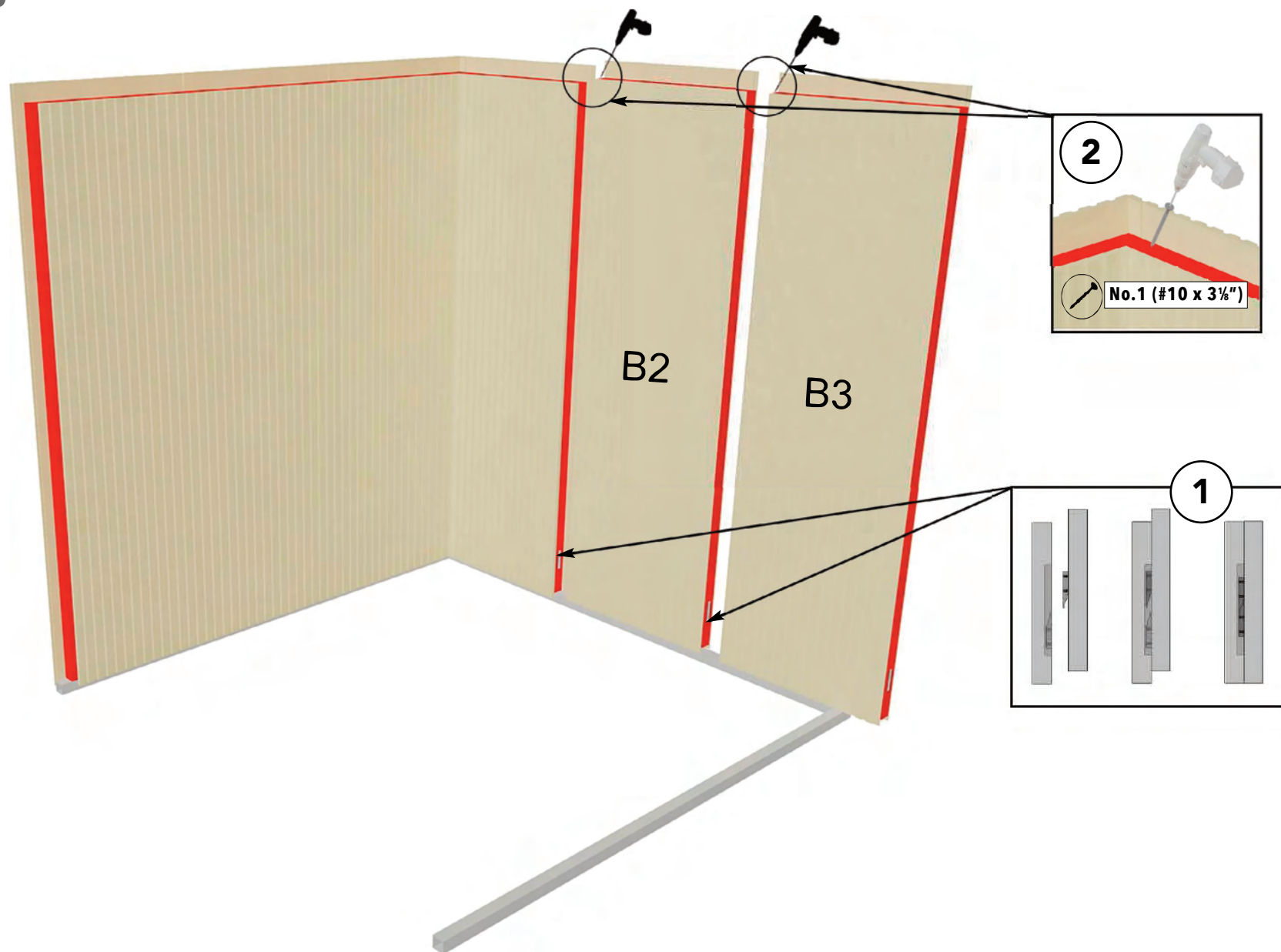

7. Fixing Walls C1 & C2 & C3

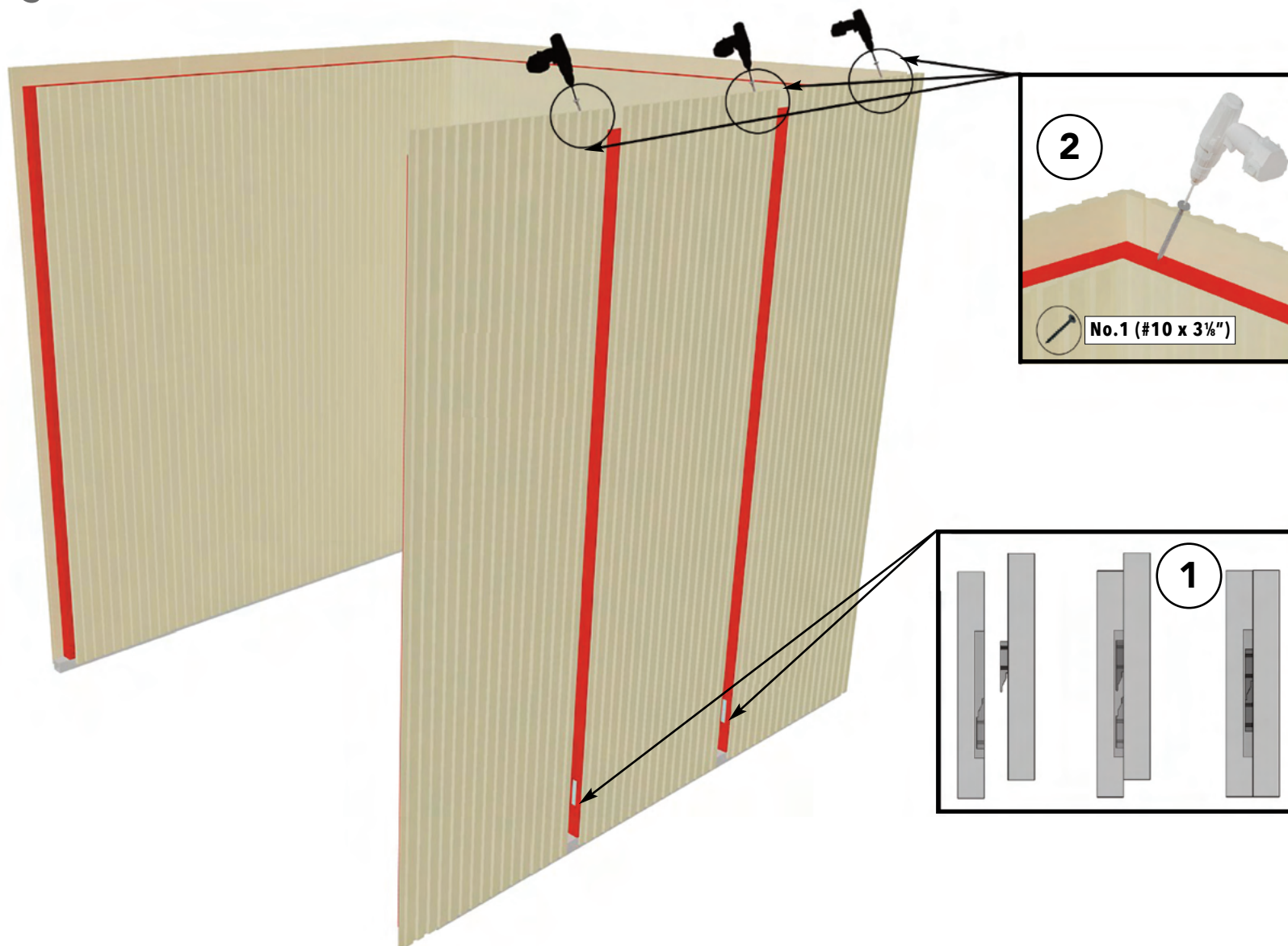

8. Fixing Ceilings

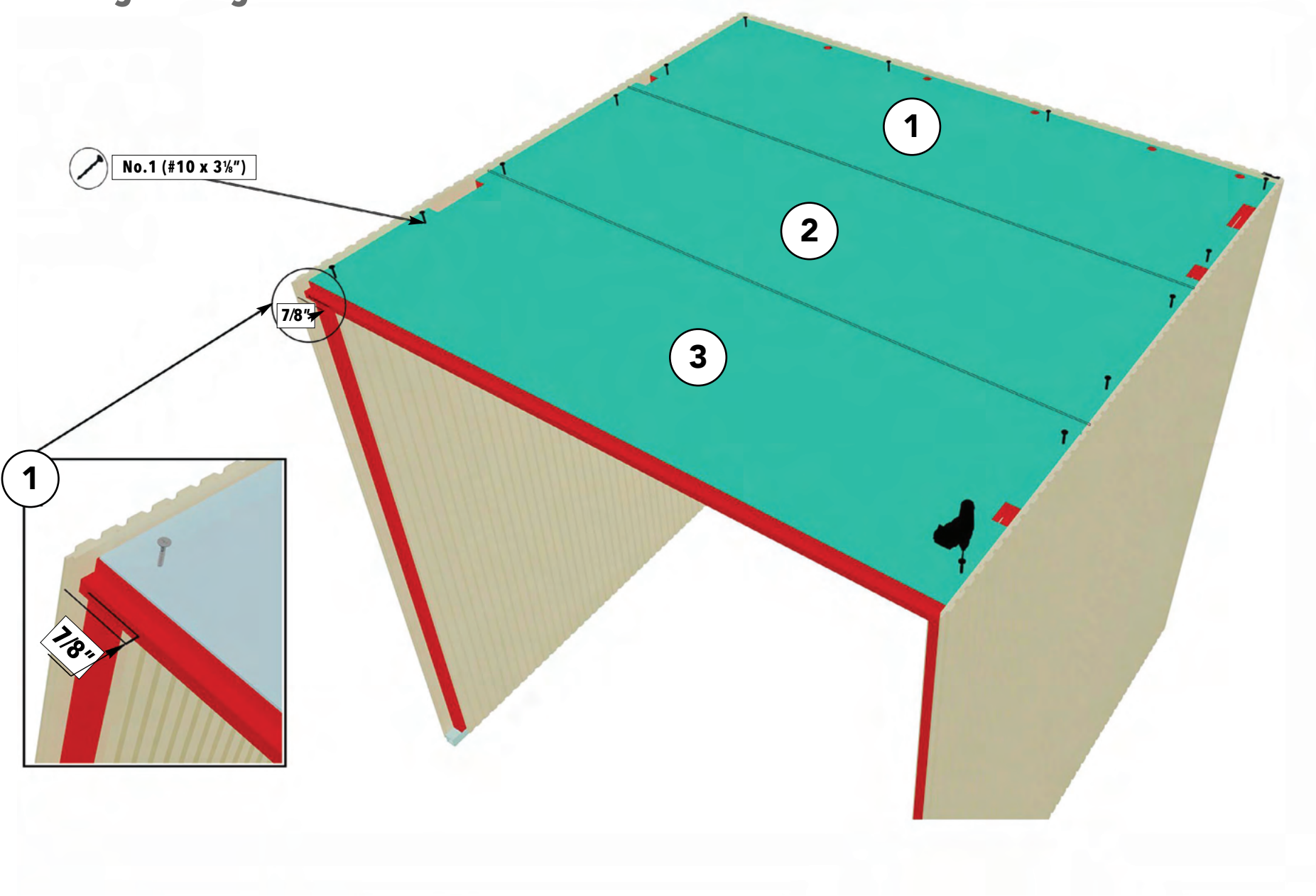

9. Interior

RMSDA66A
RMSDA67A
RMSDA68A

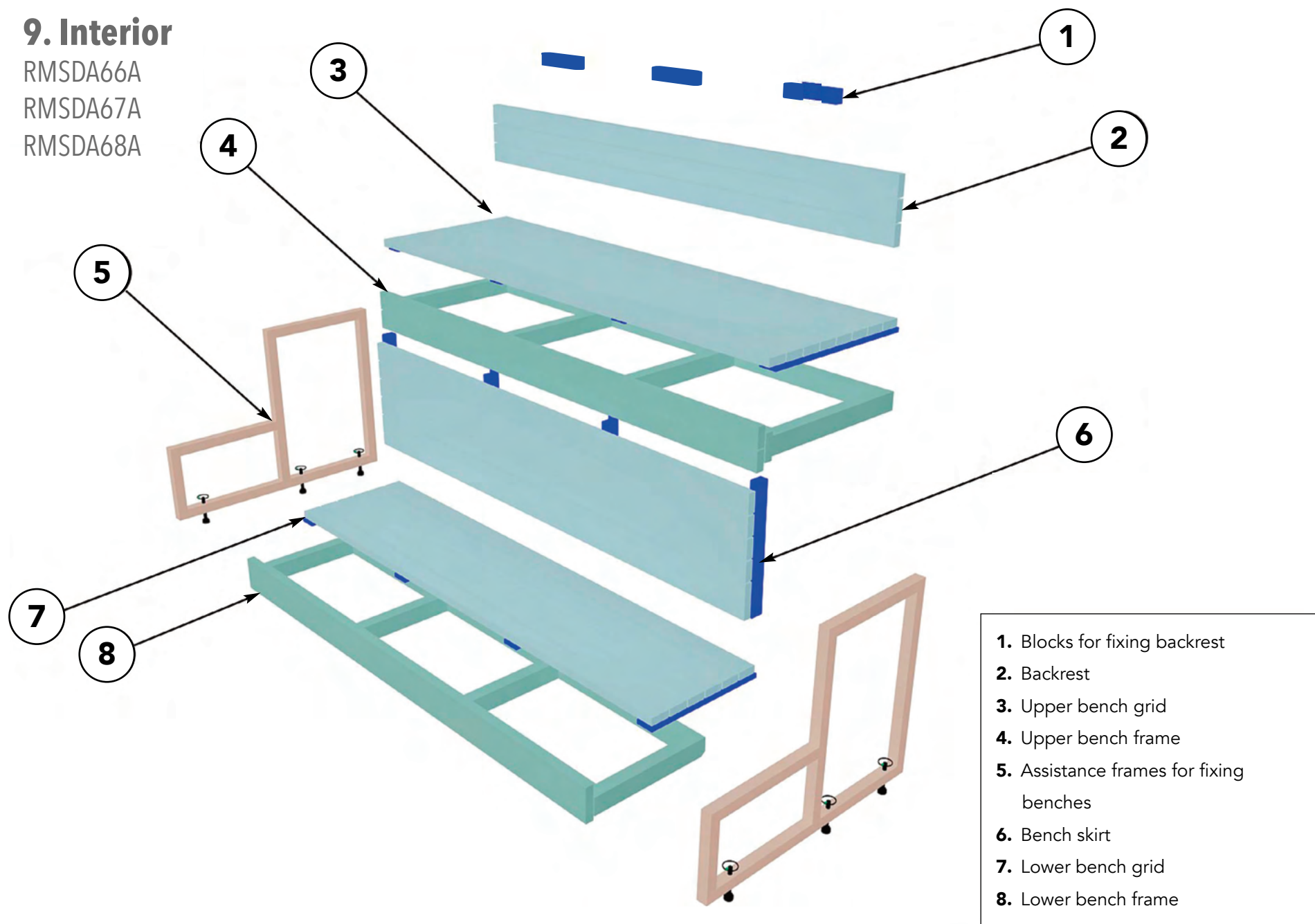

9.1 Interior

RMSDA57A
RMSDA56A
RMSDA46A

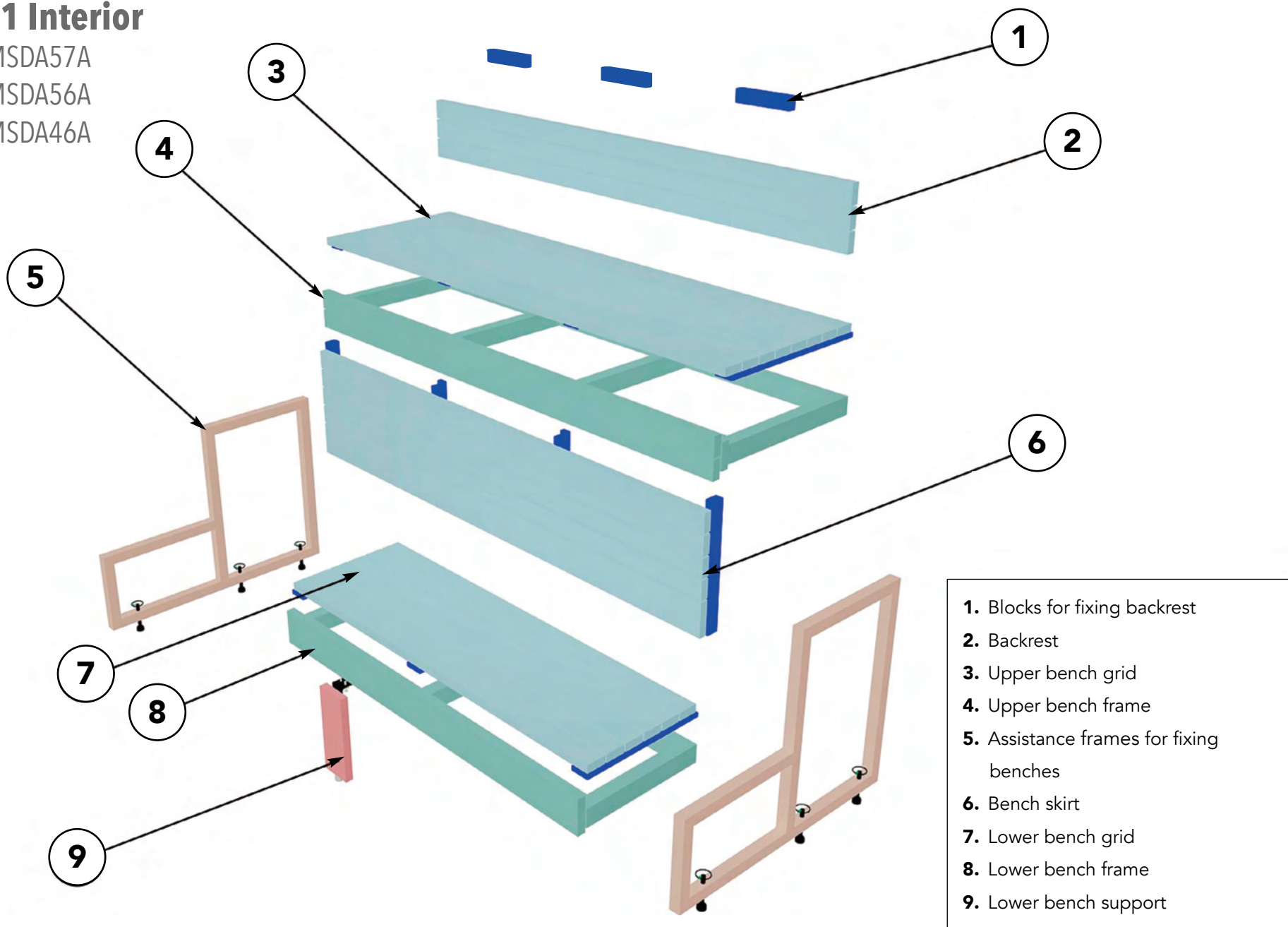

10. Assistance Frames

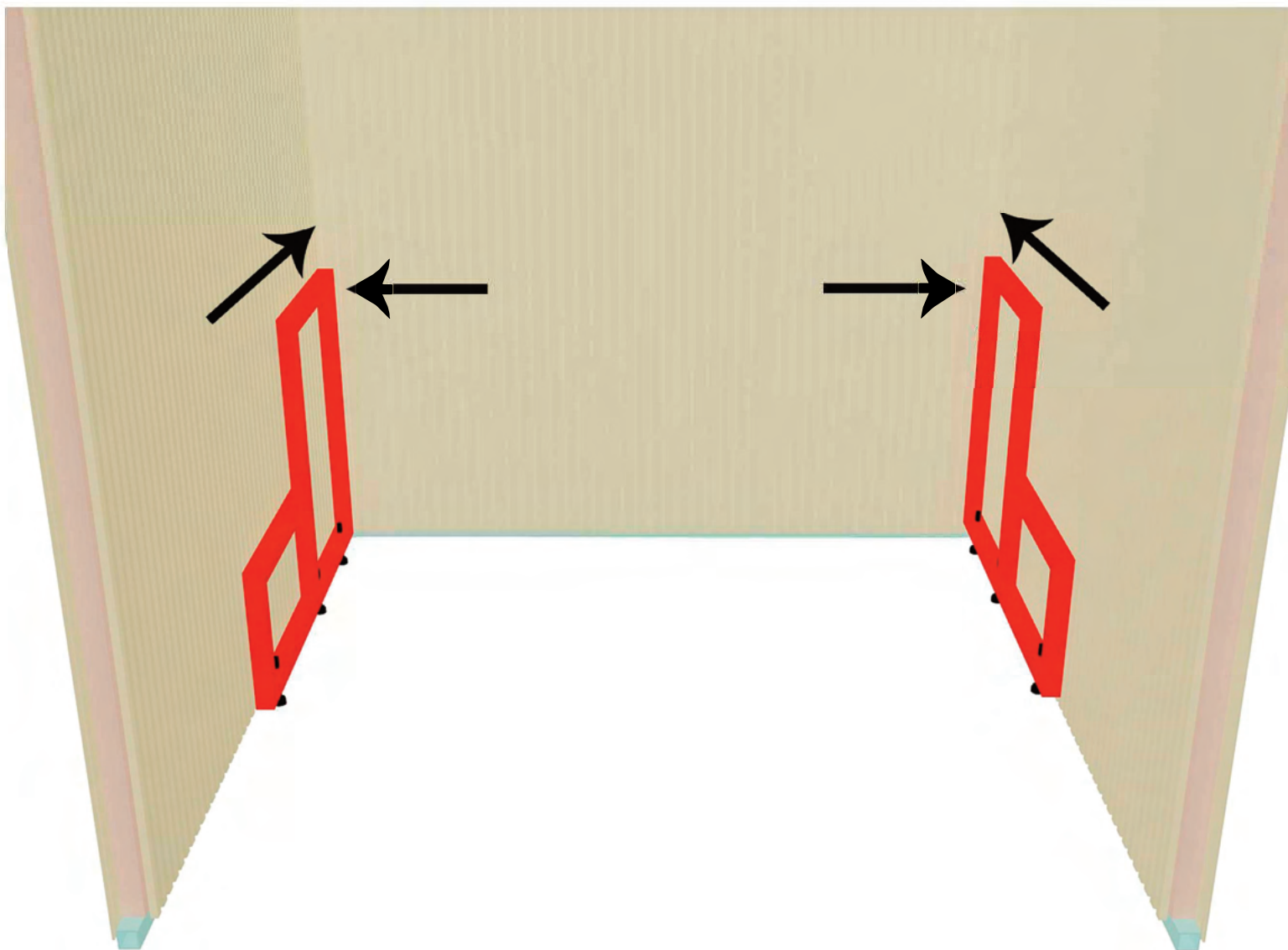

11. Bench Support Installing

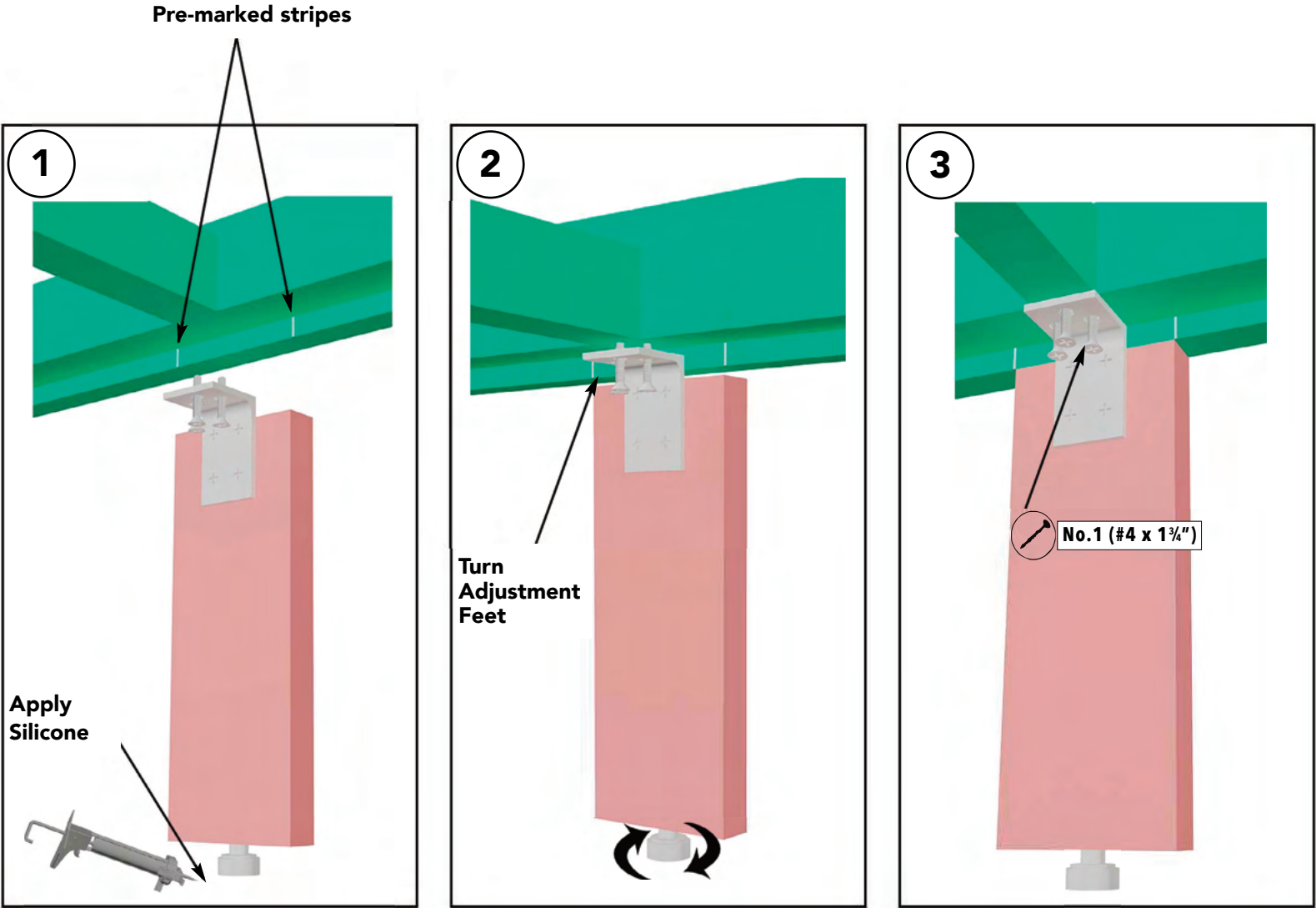

12. Bench Frames & Backrest Blocks Fixing

RMSDA66A

RMSDA67A

RMSDA68A

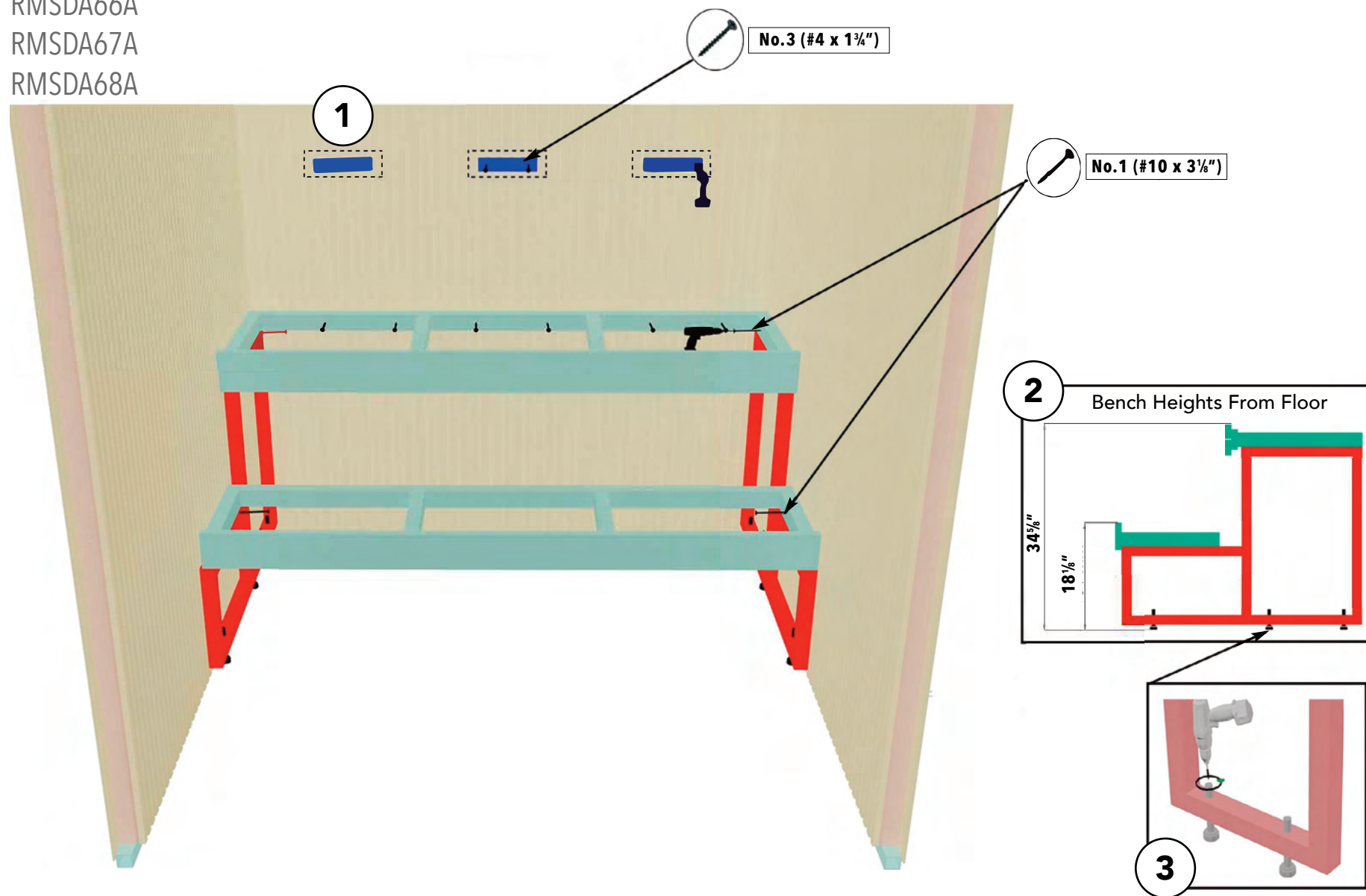

12.1 Bench Frames & Backrest Blocks Fixing

RMSDA66A

RMSDA67A

RMSDA68A

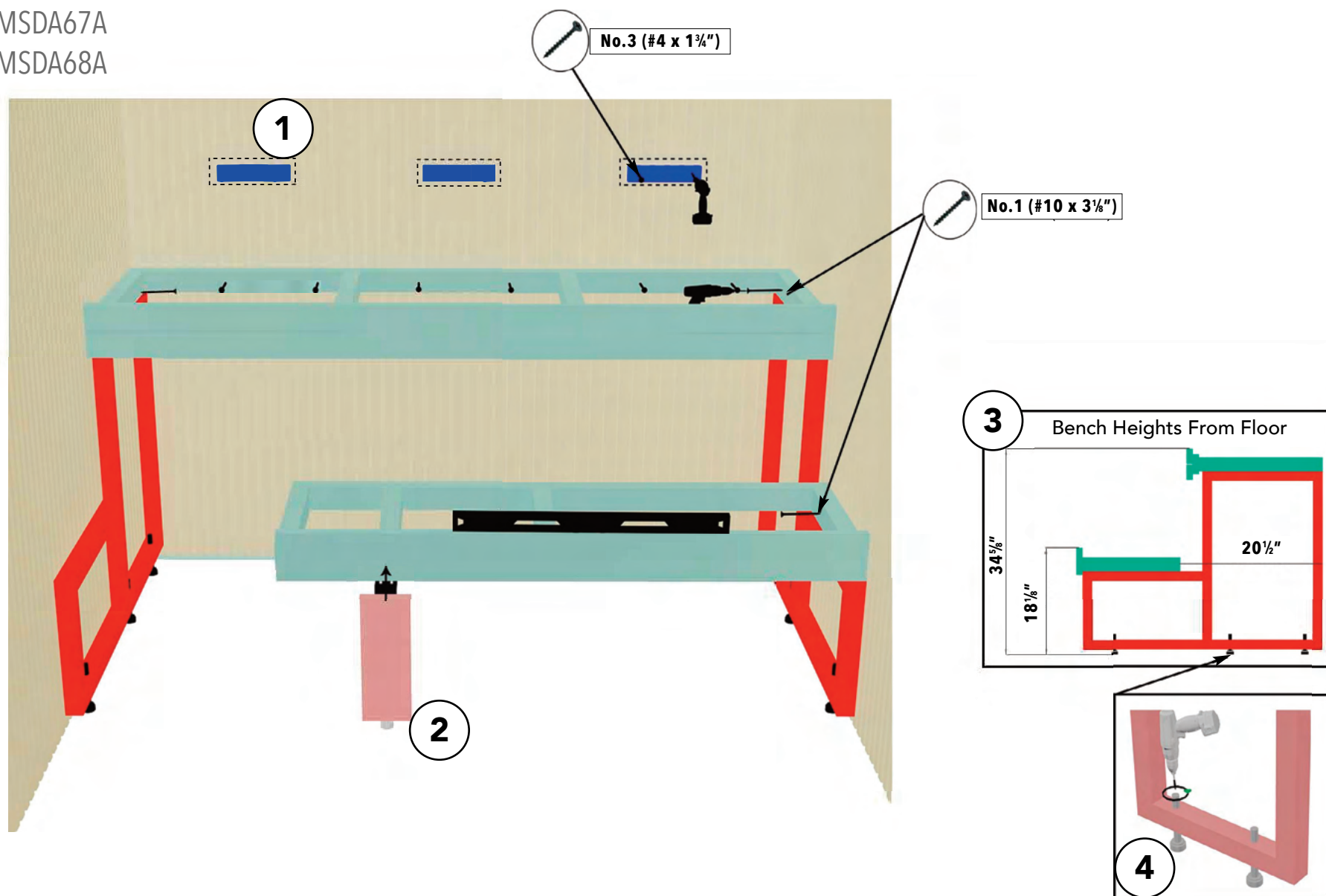

13. Removing Assistance Frames

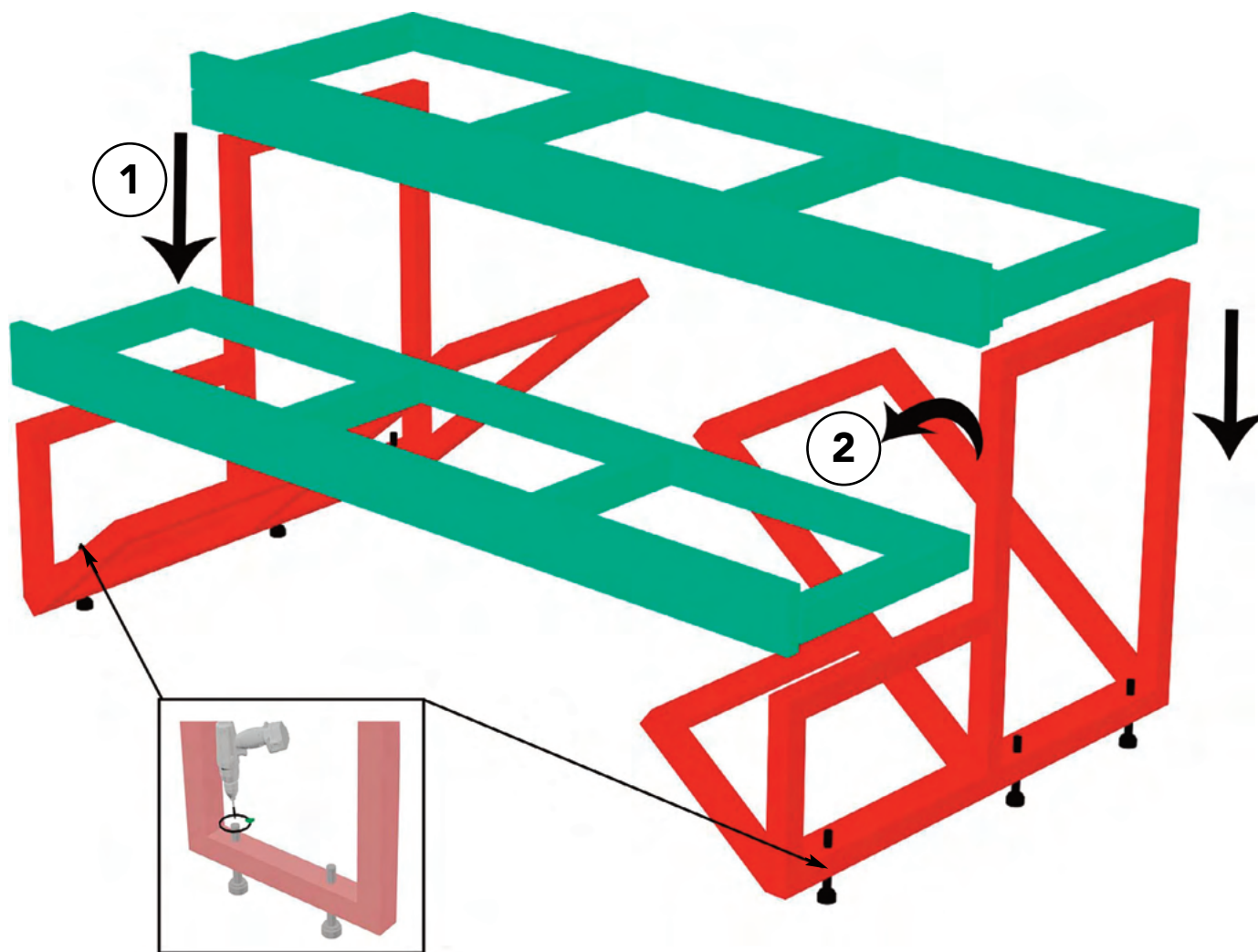

14. Wiring Inside Walls



1. Push down wires from precut holes on ceiling

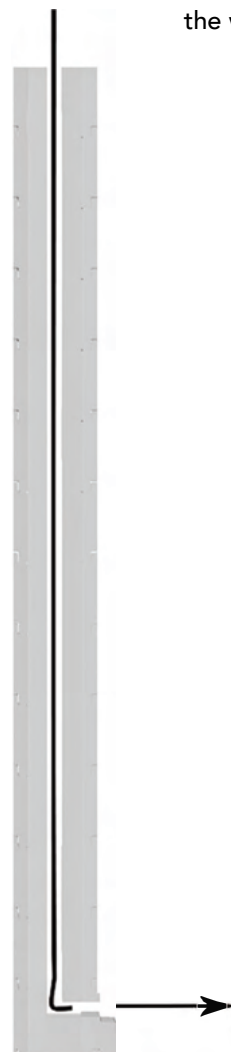

2. Pull out wires from precut holes in the walls



3. Connect wires

15. Connecting LED-Strips

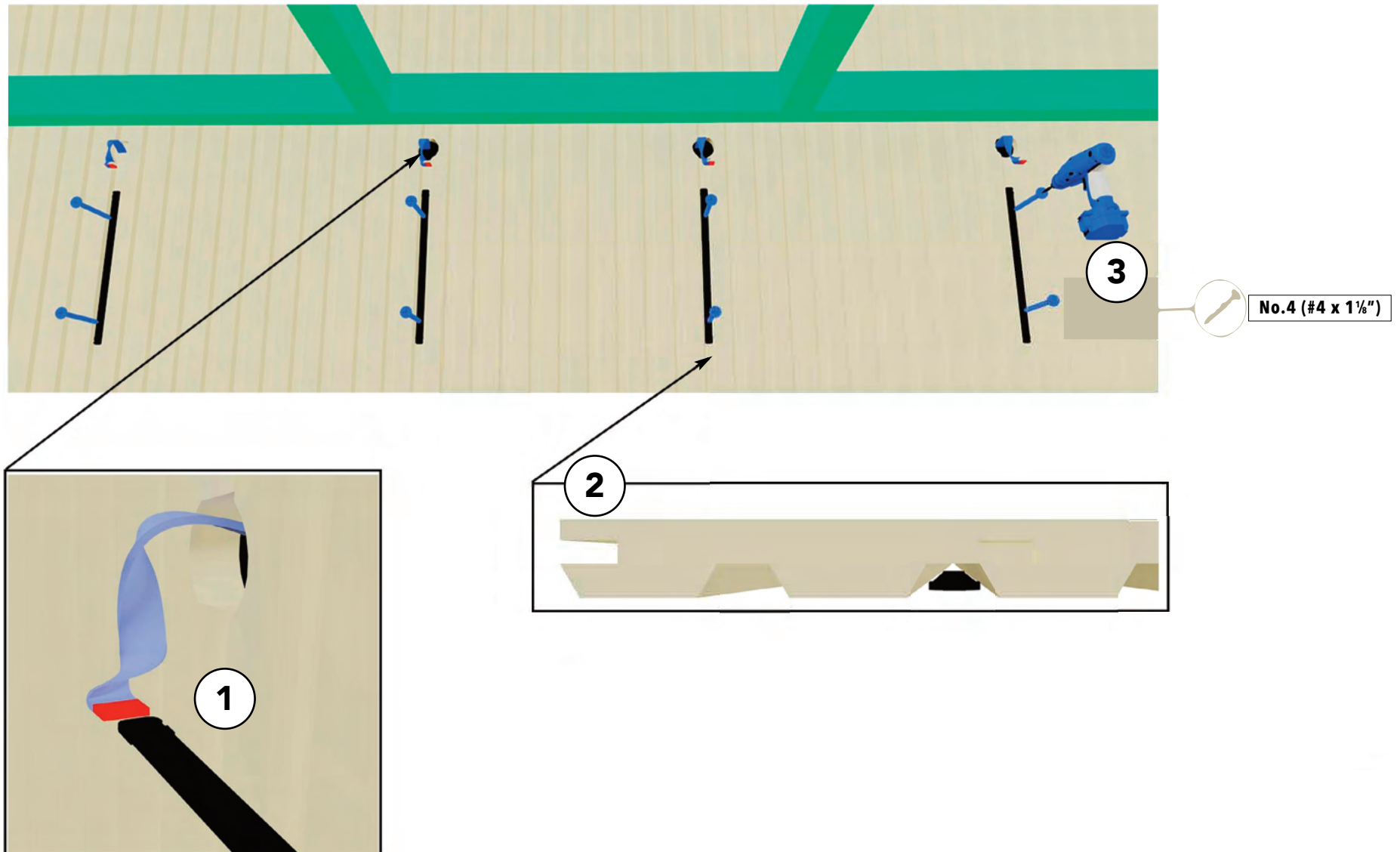

! WARNING All Electrical wiring to be installed by a qualified licensed electrician in accordance with local and national electrical code.

16. Fixing Bench Skirt

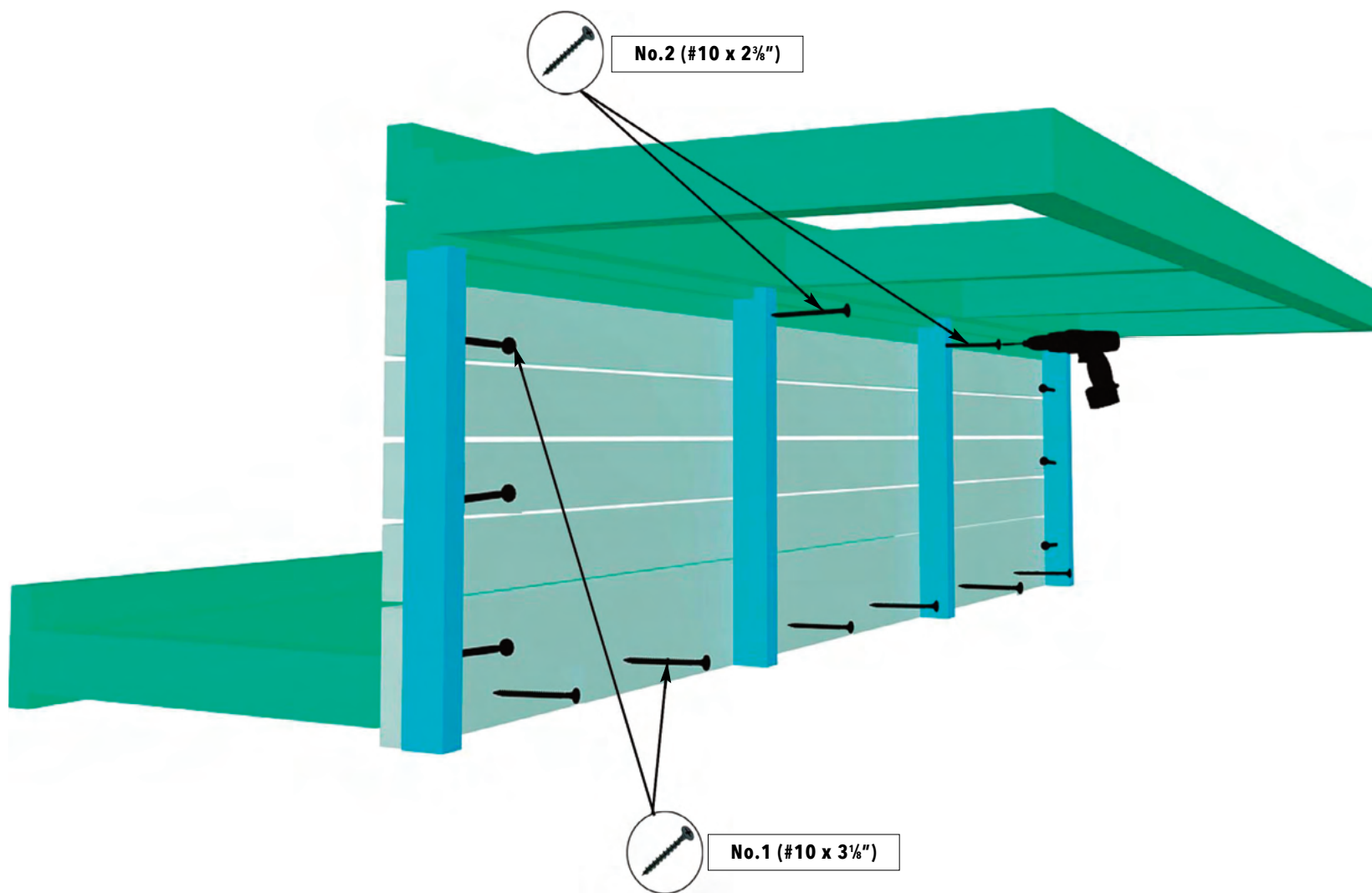

17. Backrest & Bench Grids

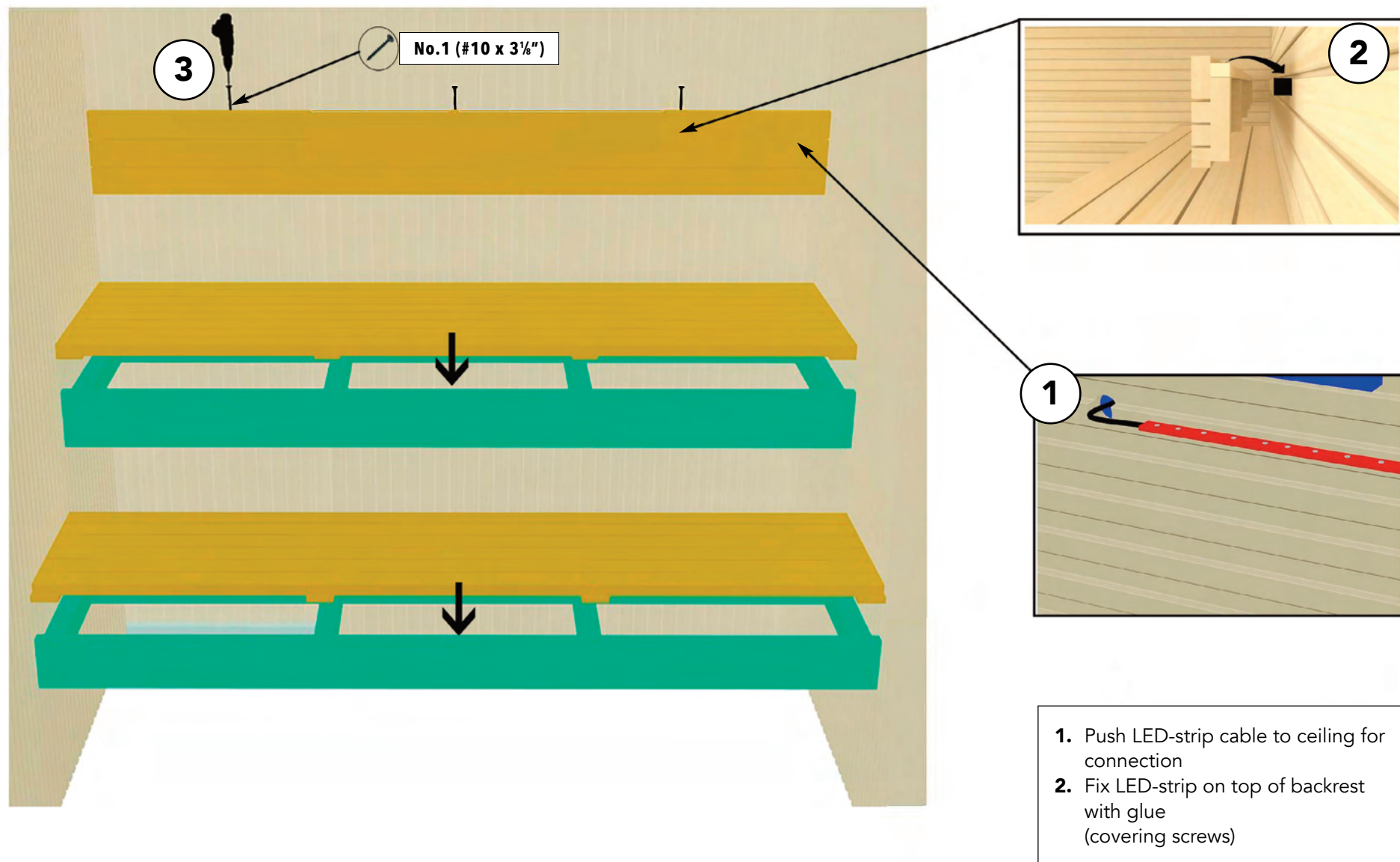

18. Interior 11

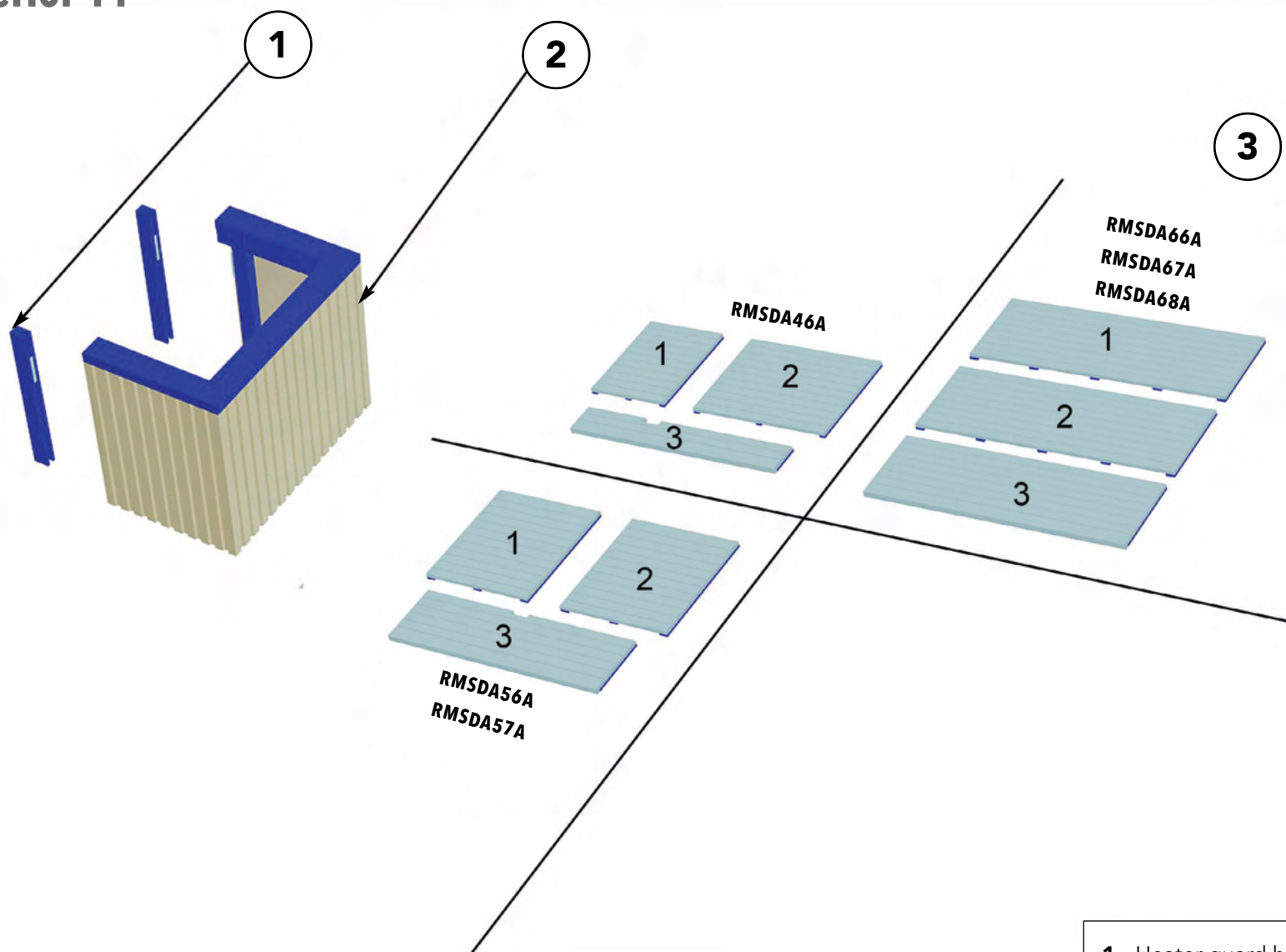

- 1. Heater guard holders
- 2. Heater guard
- 3. Floor grids

19. Heater Guard

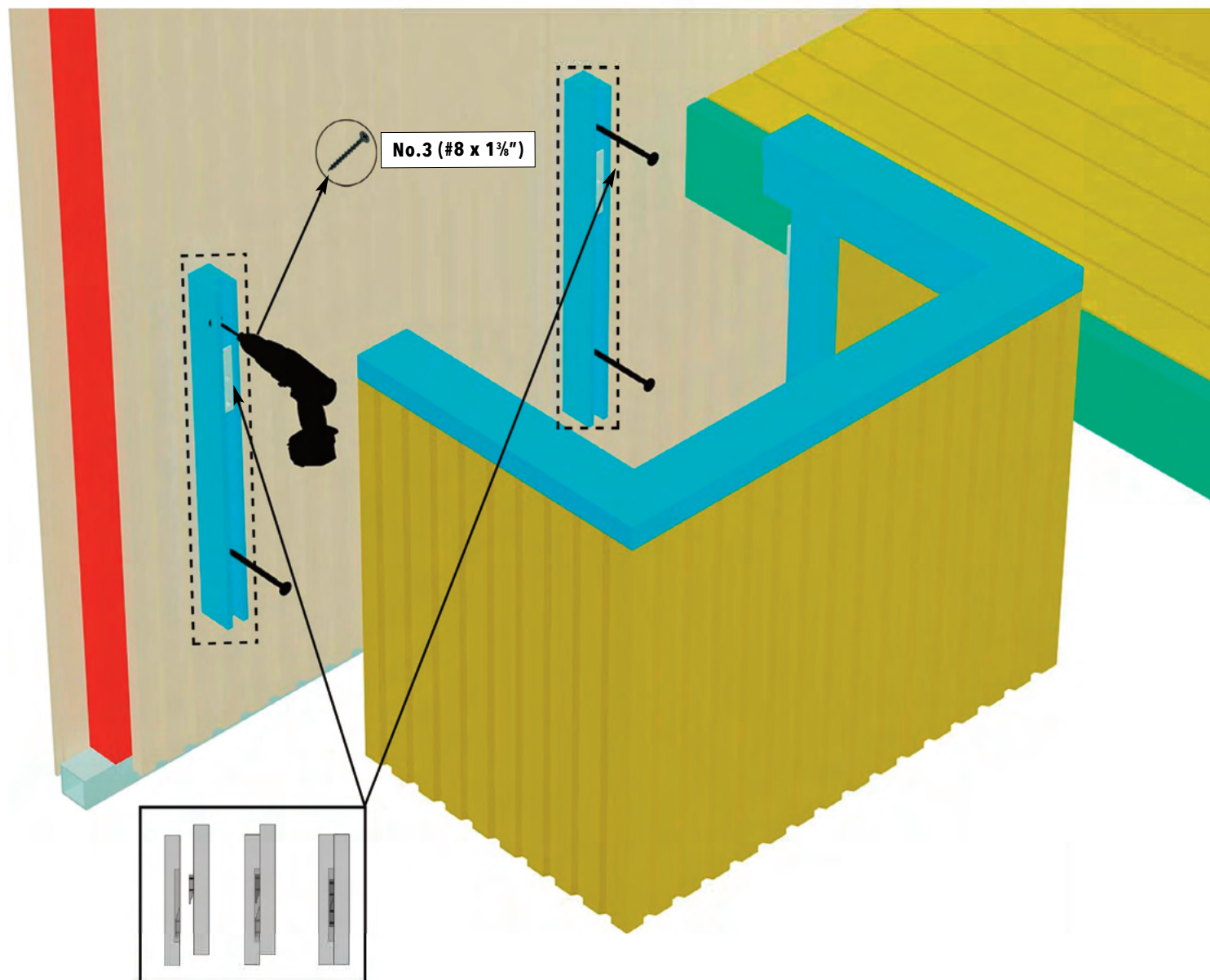

20.1. Electrical Connections

1. Run cables through the pre drilled holes in the walls to the ceiling.

! WARNING All electrical wiring to be installed by a qualified licensed electrician in accordance with national electrical code and local electrical code.

ELECTRICAL DIAGRAM

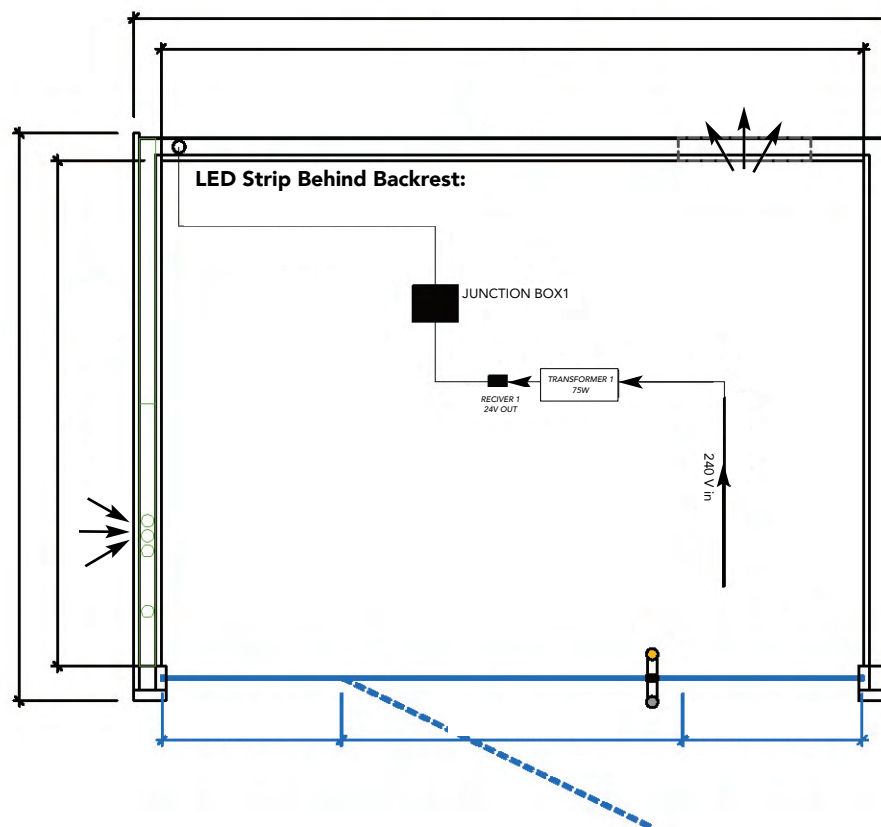

21. Glass Wall

1. Lift the glass wall in place and fix with screws.
2. Check the distance (A) between installed walls. They must be equal ($A=B$) for the door to be installed.
3. Place the door upper wooden frame piece and fix with screws from top.
4. Apply a bead of silicone between the glass panels and the floor on the outside of the sauna.

NOTE! Make sure **NOT** to leave any gaps between glasswall elements and interior cladding!

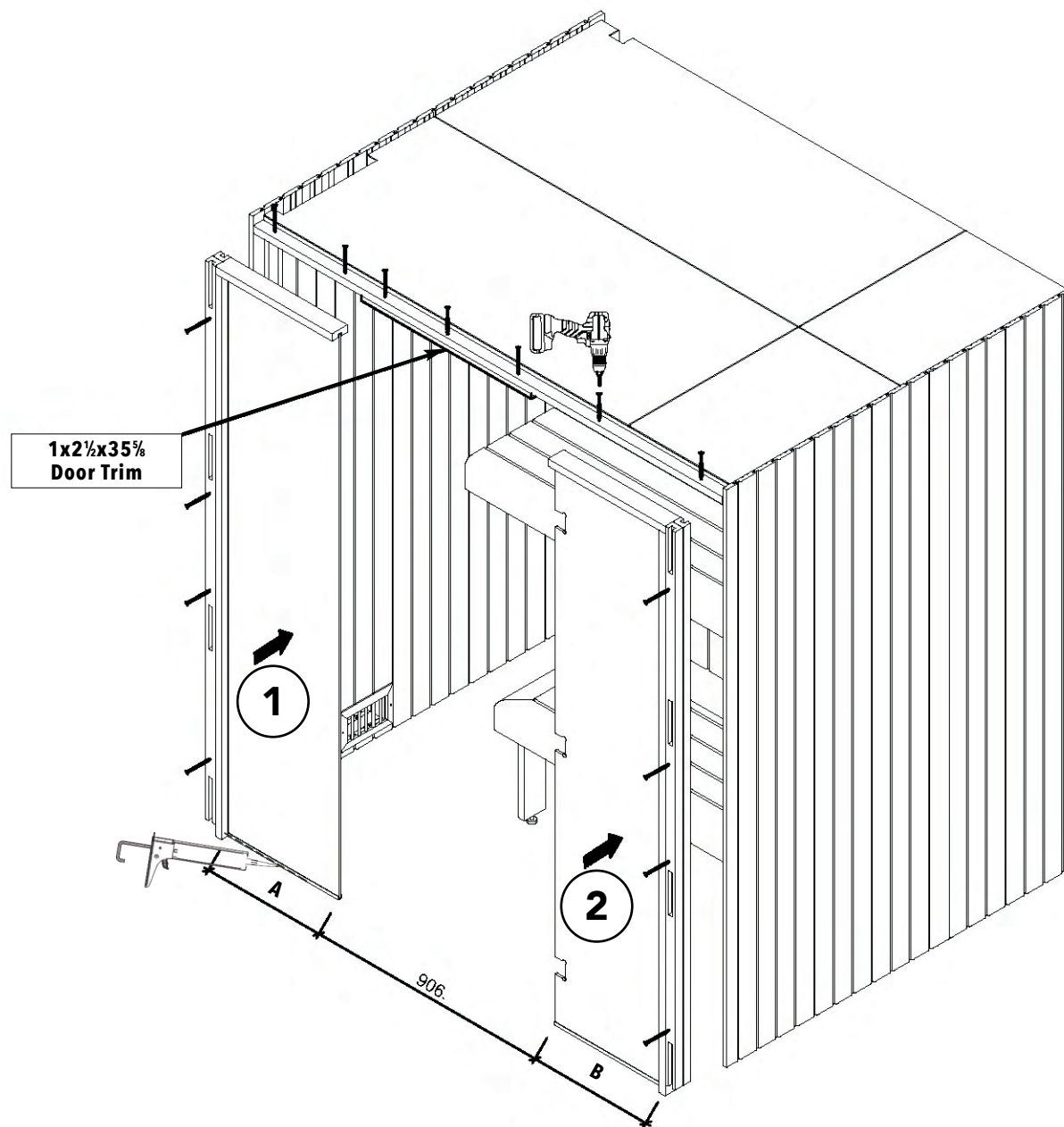

22. Door

1. Fit the hinges on door according to Figure 22c.
2. Fit the door to glass wall according to Figure 22c.
3. Fit the handle to the door according to Figure 22b.

CAUTION to prevent shattering, never rest the door on its corner or directly on a hard surface. Always rest the door on a soft protective surface.

Figure 22b.
Premium handle

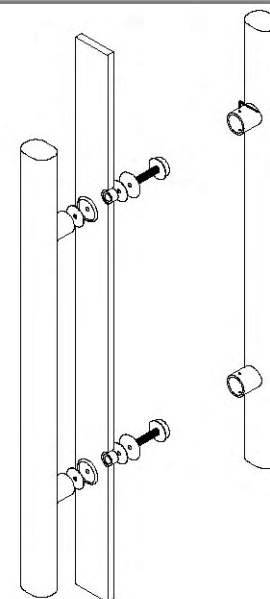
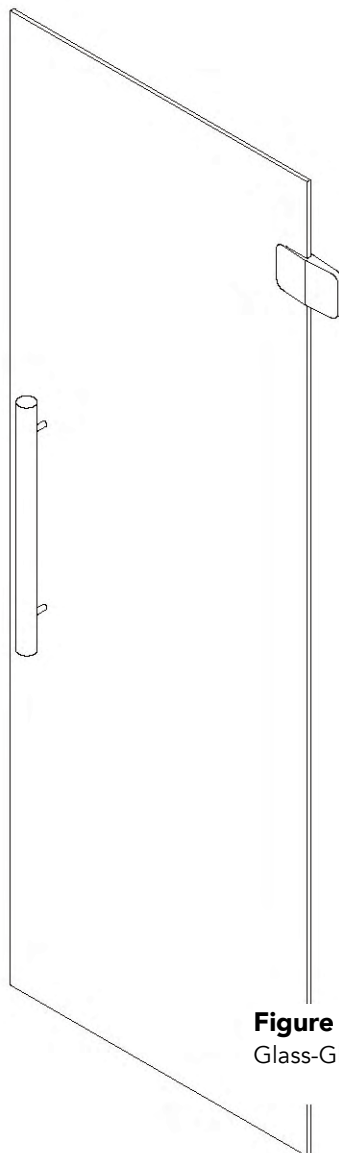
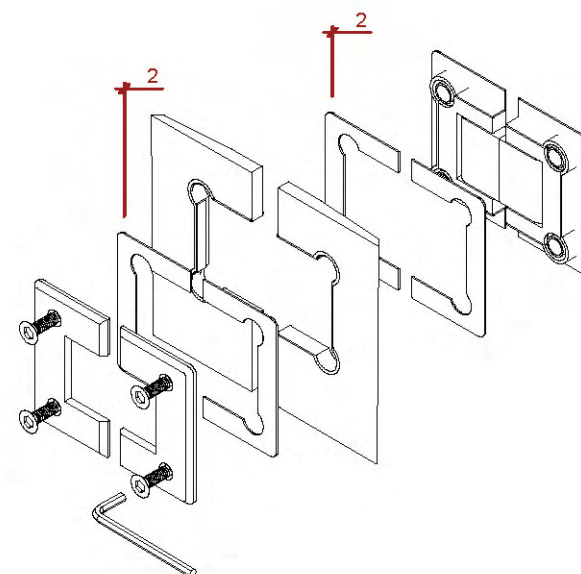

Figure 22c.
Glass-Glass Hinges
Use 2mm washers for the hinges!

Figure 22c.
Glass-Glass Hinges



23. Finishing Touches

1. Install Mouldings

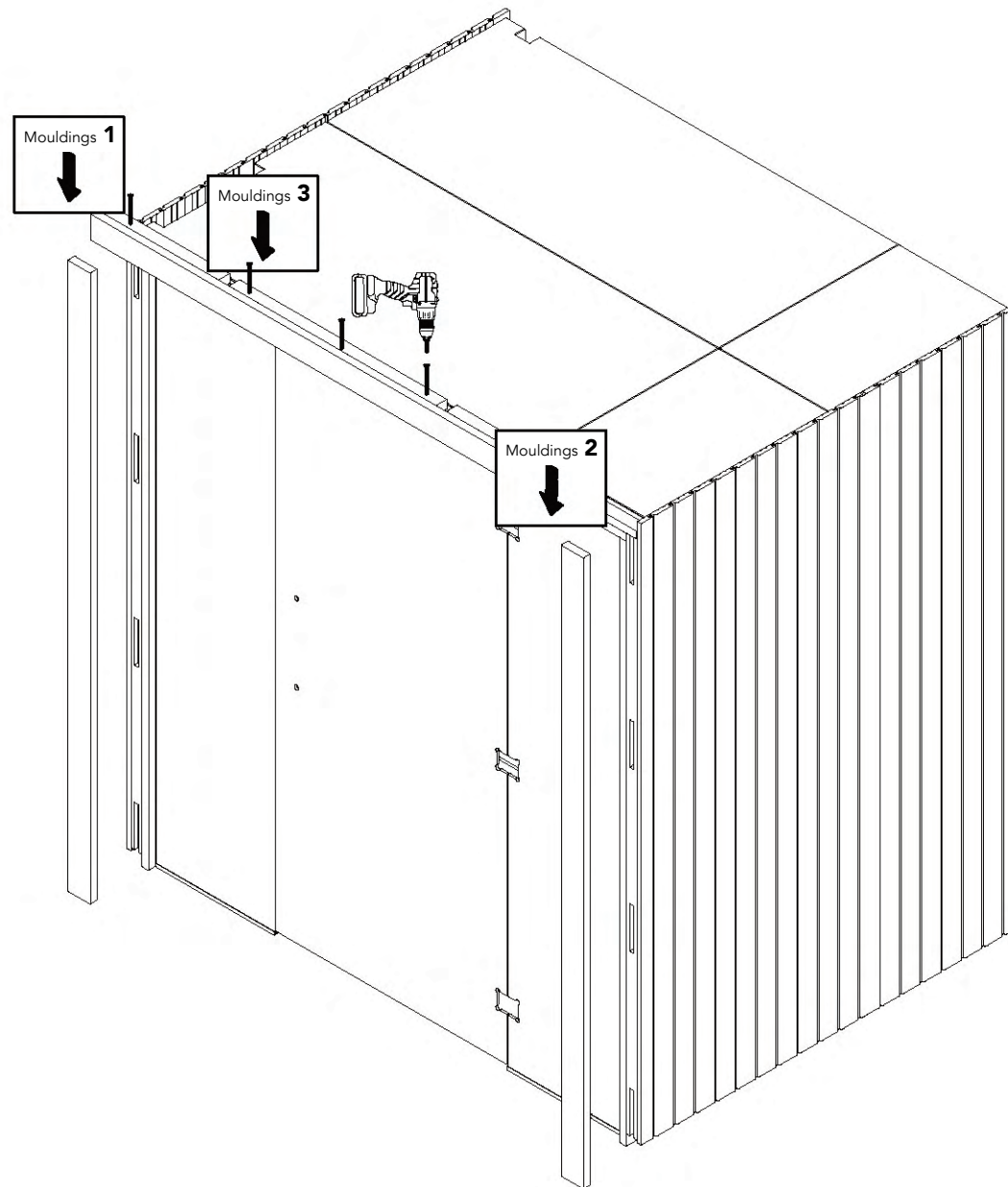
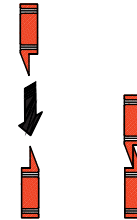

Figure 23
Multichip view



24. Completed Sauna

1. Check the level of all elements.
2. Check the functionality of all moving parts.
3. If needed make adjustments on adjustable components.

NOTE! Upon the first use sauna must be gradually and steadily taken up to normal operating temperature under constant supervision and afterwards thoroughly ventilated due to evaporation of various substances that might be present from production of the sauna and/or its components.

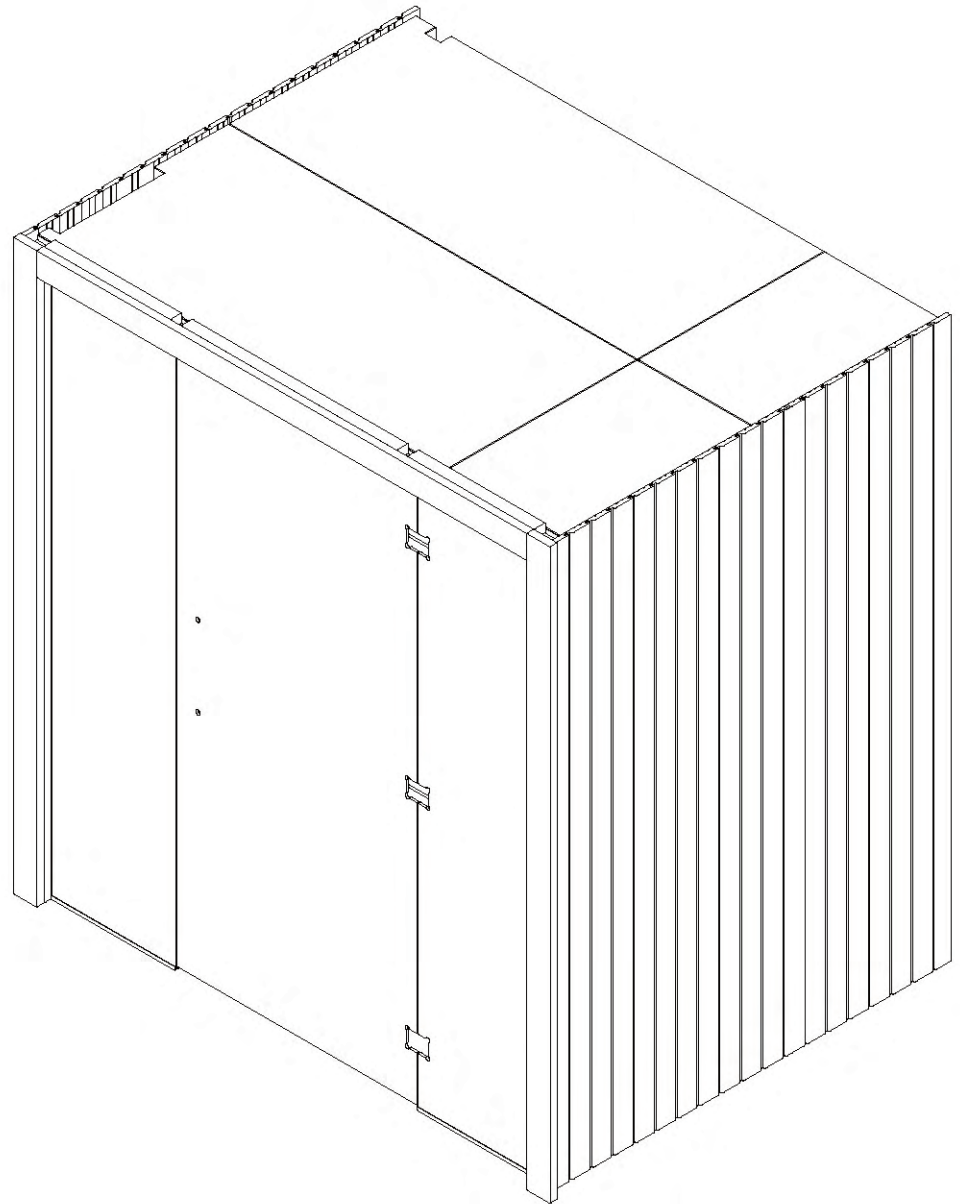

mr.steam®

Feel Good Inc.®

www.mrsteam.com

Products, information and specifications are subject to change without notice.

Please call Sales & Support at 1.800.76.STEAM (East Coast) or 1.800.72.STEAM (West Coast) for more information.

mr.steam® hello@mrsteam.com | www.mrsteam.com

43-20 34th Street, Long Island City, NY 11101 1 800 76 STEAM | 9410 S. La Cienega Blvd. Inglewood CA 90301 1 800 72 STEAM

2025 © MrSteam and des., A Lifetime of Pleasure, AirTempo, AromaFlo, AudioWizard, AutoFlush, AutoSteam, Butler Package, ChromaSteam, Clean Steam...Every Time, Club Therapy, CT Day Spa, Digital 1, Express Steam, Feel Good Inc., From Bathroom to Spa, iButler, iSpa Package, iSteam, iTempo, iTempo/Plus, Linear Steamhead, Making Wellness a Way of Life, Music Therapy, My Steam, SmartSizing, Spa Package, Steam Genie, Steam on Demand, Steam in a Box, Steam@Home, SteamStart, SteamTherapy, Tala, Tala Bath & Body, Tempo, The Intelligent Steambath, Valet Package, and Virtual Spa System are registered trademarks of MR.STEAM.

PUR100594 REV 5.25



Installation, Operation and Maintenance Manual

Saunas by Mr.Steam

Wall Mounted Models: SCA04A - SCA09A

IMPORTANT: Leave this material with the home owner

mr.steam® | Feel Good Inc.®

MrSauna Heater

Installation and Operating Instructions

TABLE OF CONTENTS

Section 1: General Information4

Section 2: Heater Specification Chart5

Installing the Heater5-7

Section 3: Electrical Wiring/8

Wiring Diagrams8

Section 4: Sauna Rocks/Installing the Rocks9

Section 5: Maintenance and Cleaning10

Section 6: Thermometer/Humidity Gauge10

Section 8: Bucket & Ladle10

Control Unit11

Installing/Wiring Control Unit11

Section 9: Using the Control12

Trouble Shooting13

Wall Mounted Models: SCA09A-SCA09A

BOX CONTENTS:

1. Sauna Heater
2. Installation & Operating Instructions
3. (6) Mounting Screws
4. CAUTION Placard & Screws
5. WARNING Placard & Screws
6. Bulb Guard Assembly
7. 44 lbs. Rocks (separate carton)

⚠ WARNING

REDUCE THE RISK OF OVERHEATING

1. Exit immediately if uncomfortable, dizzy, or sleepy. Staying too long in a heated area is capable of causing overheating.
2. Supervise children at all times.
3. Check with a doctor before use if pregnant, in poor health, or under medical care.
4. Breathing heated air in conjunction with consumption of alcohol, drugs, or medication is capable of causing unconsciousness.

L2342-1 Rev A

HYPERTHERMIA occurs when the internal temperature of the body reaches a level several degrees above the normal body temperature of 98.6°F. The symptoms of hyperthermia include an increase in the internal temperature of the body, dizziness, lethargy, drowsiness, and fainting. The effects of hyperthermia include:

- a) Failure to perceive heat;
- b) Failure to recognize the need to exit the room;
- c) Unawareness of impending hazard;
- d) Fetal damage in pregnant women;
- e) Physical inability to exit the room; and
- f) Unconsciousness.

IMPORTANT NOTE: As you follow these instructions, you will notice warning and caution symbols. This blocked information is important for the safe and efficient installation and operation of this sauna heater. These are two types of potential hazards that may occur during this installation and operation:

 **WARNING** states a hazard that may cause serious injury or death if precautions and instructions are not followed.

 **CAUTION** signals a situation where minor injury or product damage may occur if you do not follow instructions.

IMPORTANT NOTE: This highlights information that is especially relevant to a problem-free installation.

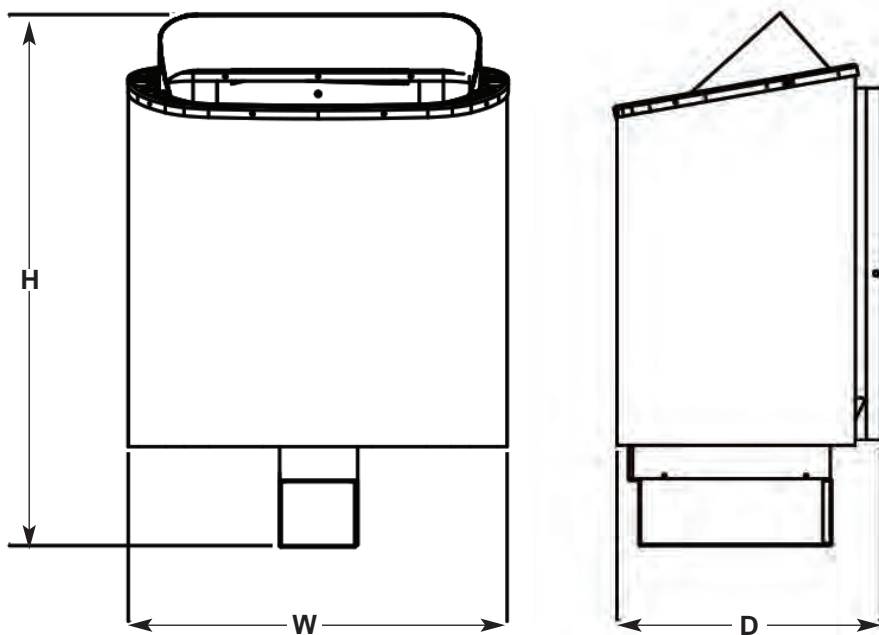

⚠ WARNING Electric Shock Hazard - High voltage exists within this equipment. There are no user serviceable parts in this equipment. All installation and service to this equipment should be performed by qualified licensed personnel in accordance with local and national codes. Failure to do so may expose user or repair person to dangerous high voltage and may result in an unsafe or inoperable heater.

Electrical outlets or receptacle must not be installed in a sauna room. Outlets may expose user to shock.

⚠ CAUTION Use only 90° C rated copper wire of the size and type indicated in the Heater Specification Chart and the temperature rating indicated on the heater junction box. Failure to do so may result in inoperable heater or fire. All heaters and controls must be wired and grounded per NEC to prevent electrical shock.

Read all instructions carefully before installation. Please leave all instructions and warranty with the owner. Owner: Please fill out and return warranty certificate promptly.

Section 1: General Information

MrSauna Sauna Heaters are for permanent installation and electrical connection. All wiring and connections to be according to NEC. To determine the correct wire size and circuit protection refer to the Heater Specification Chart below.

Heater Specification Chart								
Model No.	kW	Volts/Phase	Amps	Wire Size	Knockout	H	W	D
SCA04AC1	4.5	240/1	19	10	3/4	21 ½	16 ⅝	11 ¾
SCA06AC1	6.0	240/1	25	8	3/4	21 ½	16 ⅝	11 ¾
SCA09AC1	9.0	240/1	38	8	3/4	24 ½	16 ⅝	11 ¾

Section 2: Securing Heater to the Wall

The Mr. Sauna heater must be mounted on a flat wall, as shown in the room instructions. The heater has not been designed to be used in rooms other than those supplied by MrSteam.

Installing the Heater:

1. Verify correct heater voltage, phase and amperes for installation site.
2. Remove all packaging materials including the plastic bag, element spacers and protective plastic. Locate and keep all other materials.
3. Locate the mounting bracket as shown in the installation instructions for the sauna room

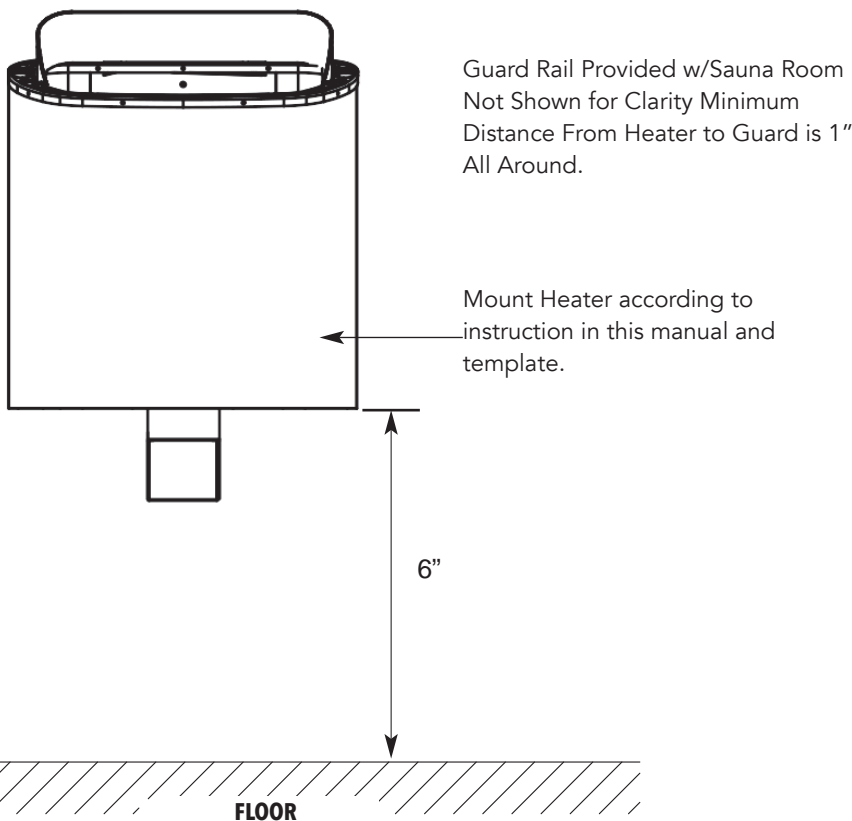
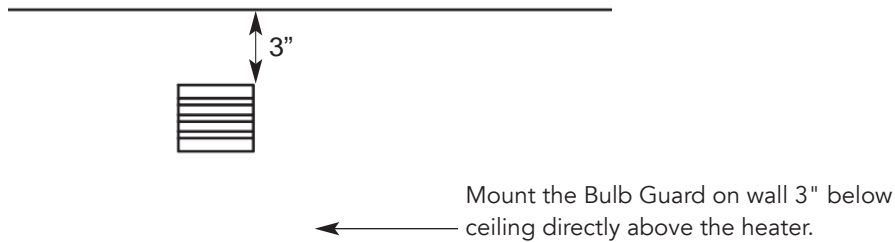

⚠ WARNING

Do not use the sauna room or heater for drying clothes, bathing suits, etc. Do not hang towels above heater or place any object other than the rocks supplied on or in the heater. If any darkening of the wall around the heater is noticed discontinue sauna use immediately. Failure to do any of above may result in fire and/or smoke hazard.

⚠ CAUTION

Inspect sauna regularly for required maintenance to heater, rocks, control and benches. Replace wood surfaces which show any signs of deterioration.

Minimum clearance from any part of heater to another surface (benches, heater guard, rail, walls...etc.) to be 1 inches minimum. Failure to do so may result in fire and/or smoke hazard. Mounting brackets supplied provide proper clearance from wall behind heater.

CAUTION To ensure safe operation, ensure the mounting bracket is level and secured to the wall using the 6 screws provided.

Heater Model	Height From Floor "A"
SCA04A	8 ½"
SCA06A	8 ½"
SCA09A	11 ¼"

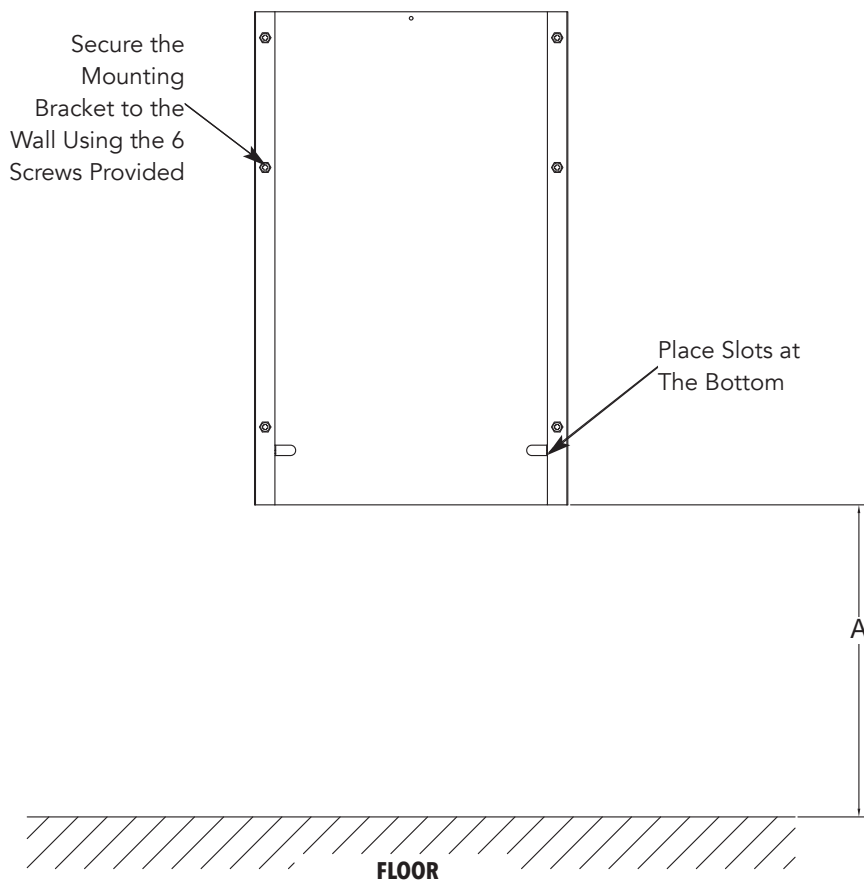

4. Determine the height of the mounting bracket from the floor.
5. Secure the bracket using the 6 screws provided. The slots in the mounting bracket shall be towards the floor.
6. Lift the heater onto the mounting bracket such that all 4 posts and supported by the mounting bracket.
7. Using the screw provided, secure the heater to the mounting bracket as shown

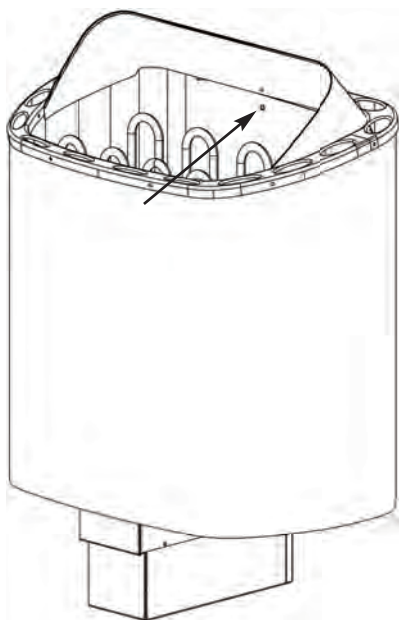

WARNING To prevent a shock and burn hazard, the heater must be screwed to the bracket as shown.

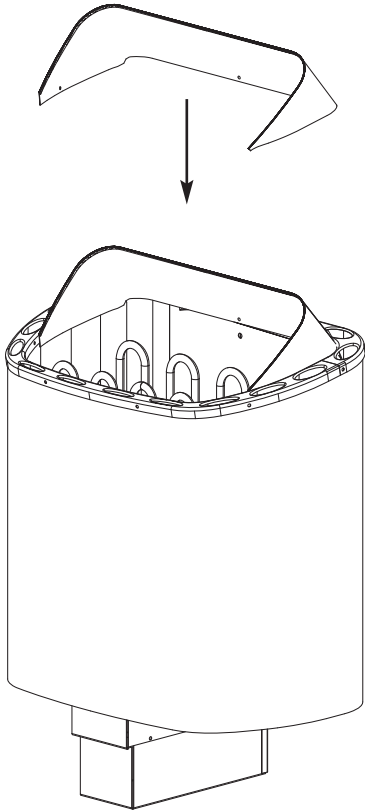

- 8.** Remove the heat shield from the heater and secure it in place using the 3 screws provided.

Section 3: Electrical Wiring

All wiring must be accomplished by a licensed electrical contractor. Refer to the Heater Specification Chart to determine the wire size and circuit protection required. The complete sauna consisting of heater and temp/time control should be properly grounded according to NEC requirements.

Heater Electrical Connections

1. Verify that heater is securely mounted to the wall
2. Turn off the circuit breaker providing power to the sauna heater power supply.
3. Remove 6 screws from the wiring box cover
4. Route power supply through knock out
5. Connect the ground line to the ground lug
6. Connect power voltage to L1 and L2 on the contactor
7. Check all power connections for correct and secure connections
8. Replace the wiring box cover and secure with the 6 provides screws

Diagram 2: Wiring Diagrams

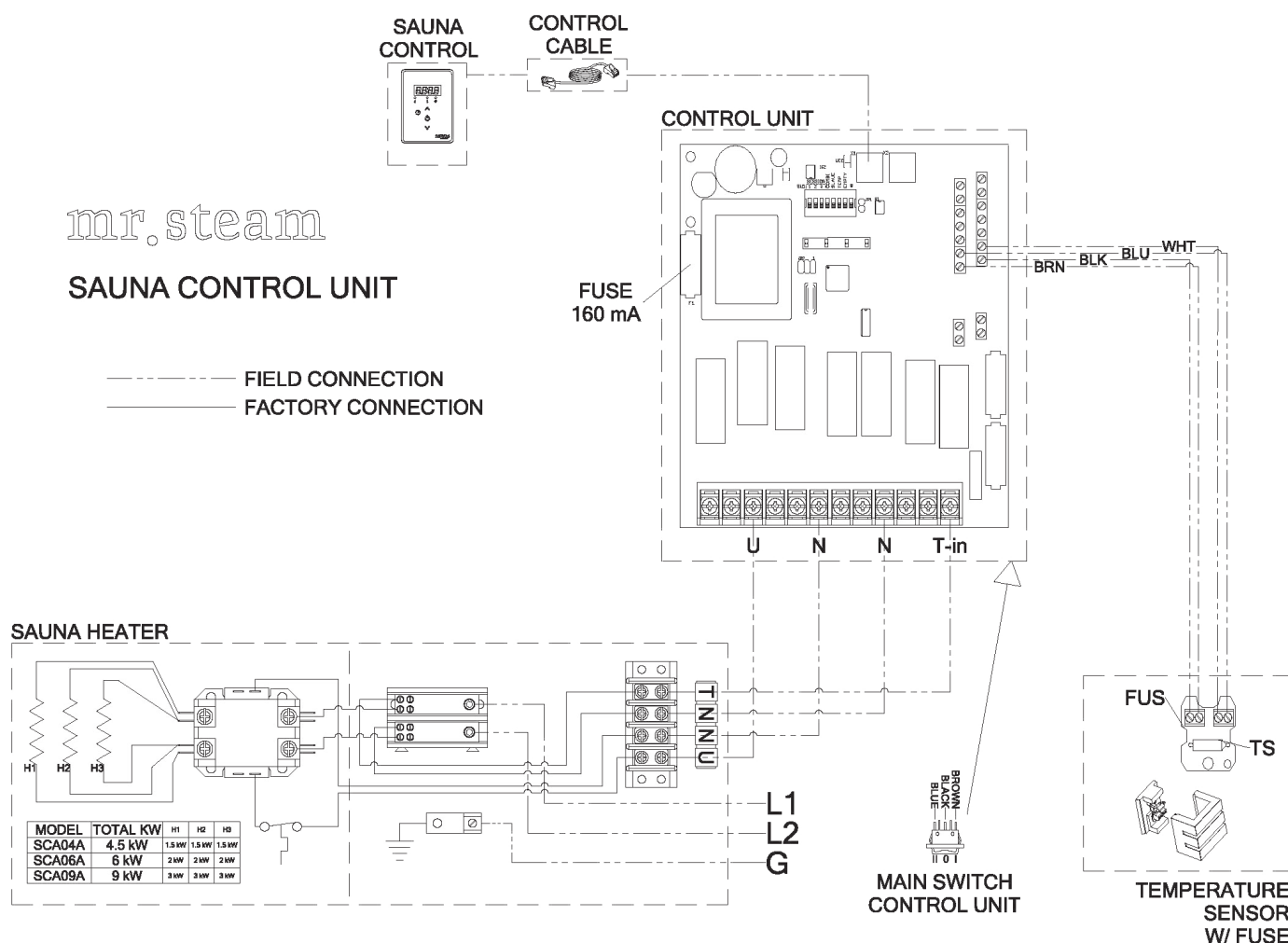

Section 4: Sauna Rocks

The Sauna heater must not be operated unless the rock compartment in the top of the heater is filled with the rocks that are furnished with the heater. They should be placed so that the air is free to travel between the rocks. Over packing the rocks may trip the heater hi-limit temperature device.

The heater is set up for use with 44 lbs. of rocks.

IMPORTANT NOTE:

Do not place more than 44lbs. of rocks in the heater.

Installing the Rocks

1. Verify that the heater is securely mounted to the wall according to instructions.
 2. Verify that the heater is OFF and that the elements and are not hot.
 3. Check the rock compartment and remove any packing or foreign materials.
 4. Open the rock carton and place the rocks into the rock compartment as shown in diagram below. The rocks should be positioned so that the air is free to travel between the rocks.
- IMPORTANT NOTE:** Over packing the rocks may trip the heater hi-limit temperature device.
5. The rocks should fit below the top surface. Any rocks that are protruding should be removed and discarded.

⚠ WARNING

Use only with rocks supplied with the heater.

Alternate rocks may damage the heater, cause personal injury or result in an inoperable heater. Electrical outlets or receptacle must not be installed in a sauna room. Outlets may expose user to shock.

⚠ CAUTION

Do not put chlorinated pool or spa water on heater. Excessive water use on heater may cause damage and void warranty.

Packing the rocks too tightly may cause the heater high limit temperature device to trip.

Diagram 3

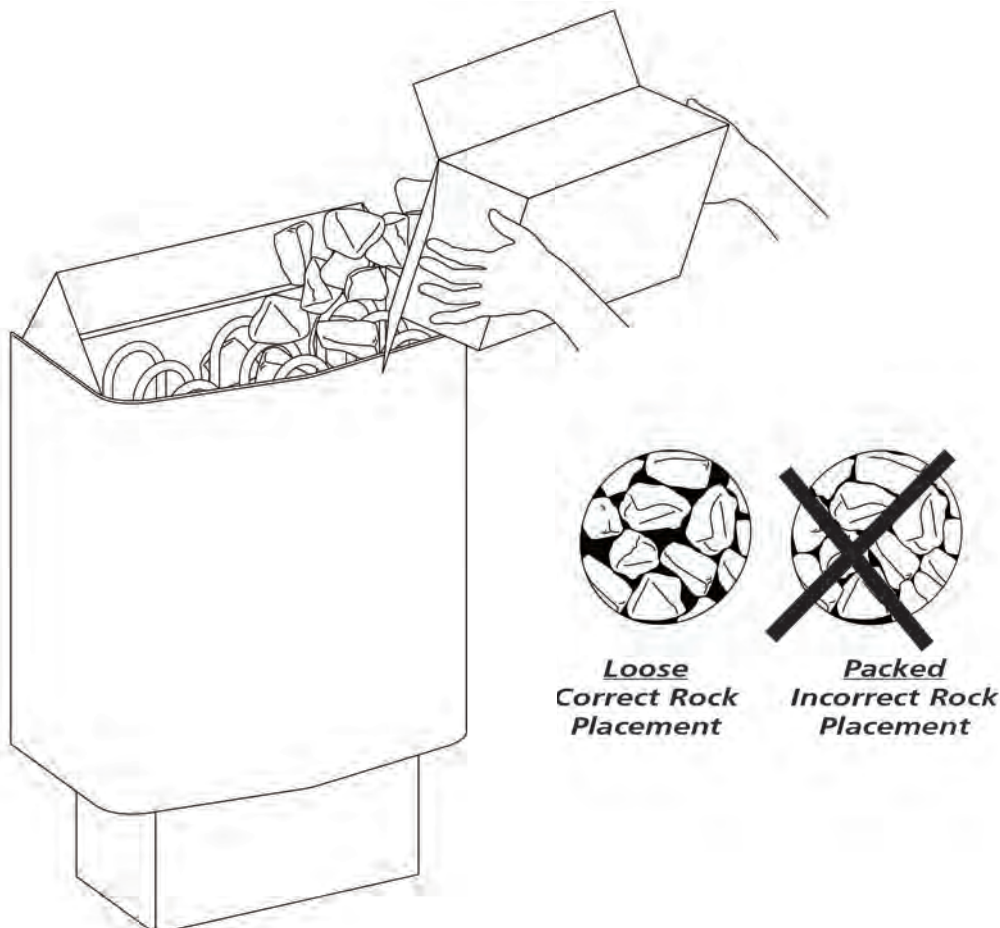

Section 5: Maintenance and Cleaning

The sauna heater should be cleaned occasionally with a damp cloth. Never use any solvents or bleaches. The rocks should be removed once a year for cleaning. Replace with original factory rocks if they appear to be crumbling.

 **WARNING** Cleaning of the heater and rocks shall only be performed when the heater is cool and power has been disconnected at the breaker.

Section 6: Thermometer/Humidity Gauge

Locate an optional thermometer or humidity gauge 6" down from the ceiling on a wall preferably so that the gauge can be observed from outside the sauna room through a door or window.

Note :

Ideal humidity range 25% - 45%

Ideal Room Temperature: 160°F - 180°F

Section 8: Bucket & Ladle

Ladle have long wooden handles to help keep from exposing hands to steam. Do not pour chlorinated pool or spa water on heater. Use only fresh, clean tap water. Excessive water use on heater may cause damage and void warranty.

WARNING

Saunas expose the users to elevated temperatures. If used improperly or by inappropriate persons, exposure to heat can be harmful to health, causing overheating, hyperthermia, and even death. The following guidelines must be followed:

Leave sauna immediately if uncomfortable, dizzy or sleepy.

Staying too long in sauna can cause overheating and even death.

Especially at risk are children under 10, the elderly, and those taking alcohol, drugs, and medicine.

Check with a doctor before using sauna if pregnant, or under medical care.

CAUTION

Minors should be adequately supervised whenever near a hot or warming sauna to prevent burns from accidental contact.

The heater gets extremely hot during operation and should not be touched or burns may result.

A guardrail or fence is required around the heater to prevent burns from accidental contact.

Control Unit

CAUTION

To prevent damage to the control unit or an inoperable condition:

- Do not mount control unit inside the sauna room
- The control unit is protected against water splashed, however it should not come into direct contact with water
- When mounting the control unit on a wall, the switch must face downward
- Secure the control unit with 4 screws.

Important Notes

- The control cable length is 15 feet
- The room temperature cable is 13 feet water.

Installing the Control Unit

1. Remove the cover of the control unit by removing the two screws on each side of the control unit.
2. Secure the control unit in place with 4 screws in the location shown.
3. The control unit shall be mounted on an outdoor room locate in a area where it will not be covered by snow. The control unit may be mounted on to of an indoor room. However it must be mounted on a way where there is a Gap at least 1" under it to allow for of airflow.

Wiring the Control Unit

1. Connect the T, N, N and U terminals in the sauna heater to the T-in, N, N and U terminals on in the control unit. Refer to the wiring diagram on page 3.
2. Wiring between the sauna heater and control unit shall be run in conduit.

CAUTION

Use only 14 AWG 90 °C rated copper wire between control unit and the sauna heater.

Temperature Probe

WARNING

To ensure safe operation and proper temperature control install the temperature probe as shown on page 5.

1. Install temperature probe on wall directly above the heater, 3" down from the ceiling (see page 5).
2. Using the wire provided connect the temperature probe to the control unit according to the wiring shown on page 8.
3. Cover the temperature probe with the guard provided.

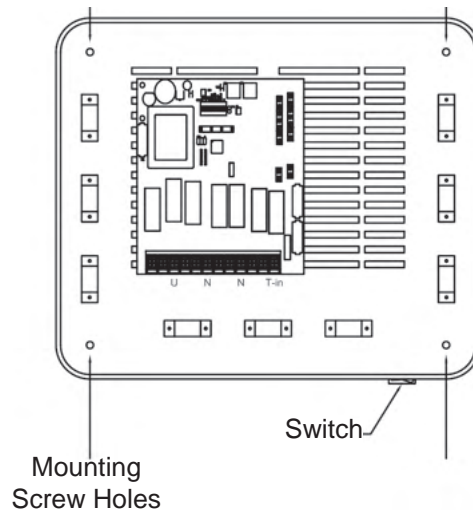
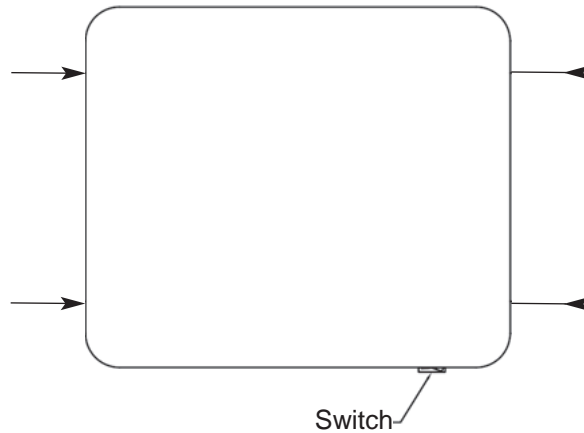
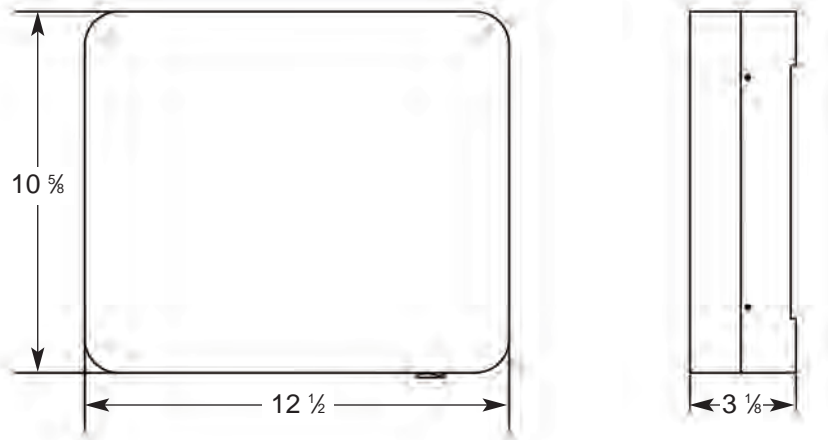

Sauna Control

1. Install the shower control per the instructions provided with the room.
2. Plug the control cable into the sauna control and control unit as shown in the wiring diagram on page 8.

Section 9: Using the Sauna

Temperature Units

When the heater is OFF, press the power button and down arrow at the same time. The control will beep and display the new temperature units

1. Turn on power to the sauna at the breaker.
2. Turn on power to the control unit by putting the control unit switch into the I positions.

IMPORTANT NOTES:

- The maximum set temperature is 190°F
- The maximum duration is 60 minutes.
- Sauna rooms may take 30-45 minutes to reach desired temperature.

Display

The Display Defaults to the Room Temperature. Pressing the Up/Down Arrow Will Adjust Set Temperature.

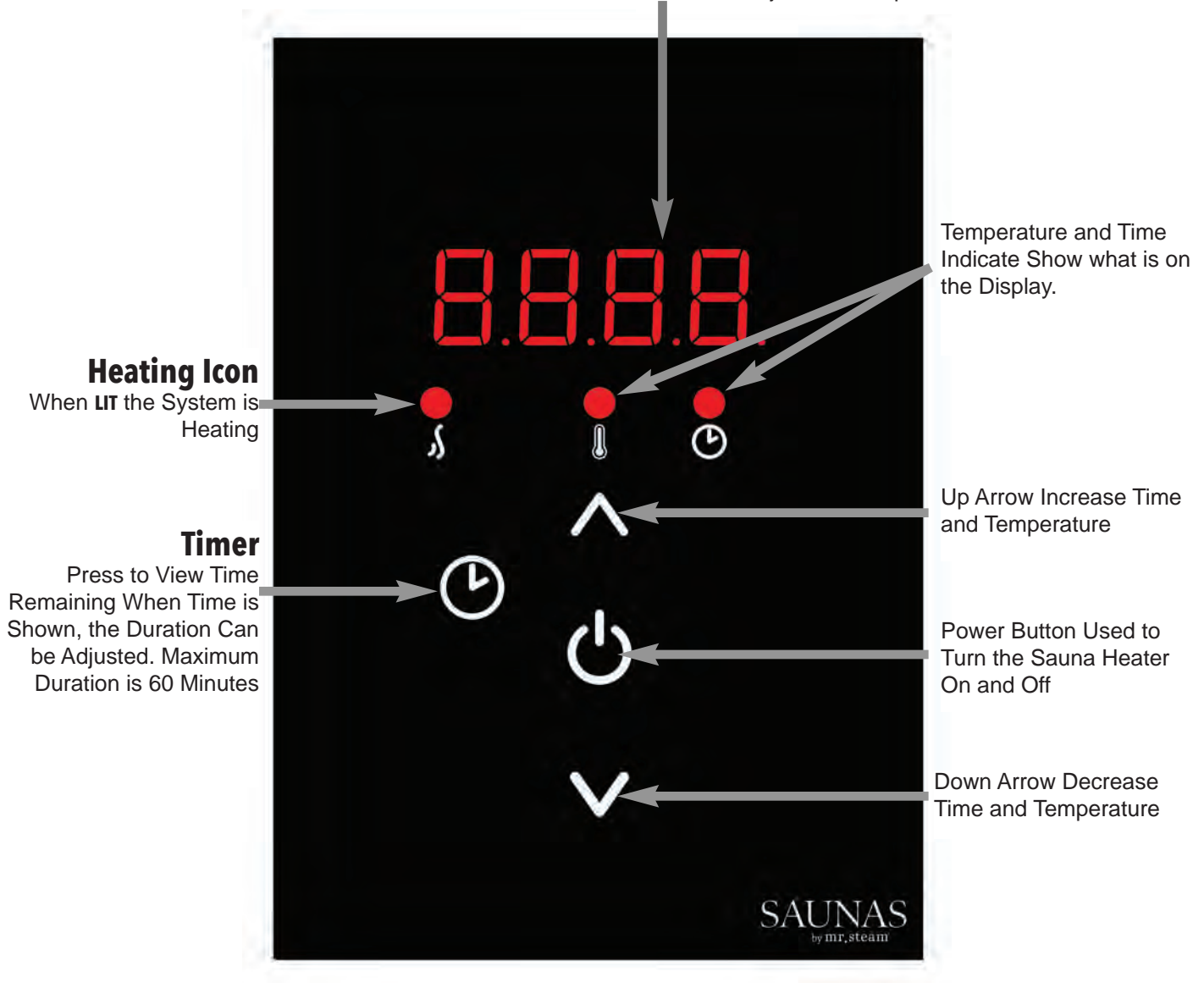

Trouble Shooting

If an error occurs, the heater will turn off and the control will display an error message while beeping.

Error Code	Problem	Solution
E1	Temperature Sensor is not recognized	Ensure the temperature probe is installed and connected correctly
E2	Temperature sensor short circuit	Check the wire between the control and the control unit is not damaged
E3	Thermal fuse is open	Check the continuity of the thermal fuse
		*Note , if the thermal fuse is open the sensor needs replacement, however you need to determine why the room over heated to prevent future problems
		Check the wire between the control and the control unit is not damaged
		Ensure the temperature probe is installed and connected correctly
E7	Communication failure	Check the cable from the control to the control unit
		If the area where the cable is located has power wiring next to it it may cause interference problems
E8	Over Temperature	Discontinue use and contact technical service
E10	PCB Overheated	Check ventilation of control unit, the system can restart when the control unit cools

The LED lights in the control unit also correspond to the errors noted above.

Error	LED 1	LED 2	LED 3	LED 4
E1	Off	Off	Off	On
E2	Off	Off	On	Off
E3	Off	Off	On	On
E7	Off	Off	On	On
E8	Off	Off	Off	Off
E10	Off	Off	On	Off

mr.steam®

Feel Good Inc.®

www.mrsteam.com

Products, information and specifications are subject to change without notice.

Please call Sales & Support at 1.800.76.STEAM (East Coast) or 1.800.72.STEAM (West Coast) for more information.

mr.steam® hello@mrsteam.com | www.mrsteam.com

43-20 34th Street, Long Island City, NY 11101 1 800 76 STEAM | 9410 S. La Cienega Blvd. Inglewood CA 90301 1 800 72 STEAM

2025 © MrSteam and des., A Lifetime of Pleasure, AirTempo, AromaFlo, AudioWizard, AutoFlush, AutoSteam, Butler Package, ChromaSteam, Clean Steam...Every Time, Club Therapy, CT Day Spa, Digital 1, Express Steam, Feel Good Inc., From Bathroom to Spa, iButler, iSpa Package, iSteam, iTempo, iTempo/Plus, TempoTouch, TempoFlex, Linear Steamhead, Making Wellness a Way of Life, Music Therapy, My Steam, SmartSizing, Spa Package, Steam Genie, Steam on Demand, Steam in a Box, Steam@Home, SteamStart, SteamTherapy, Tala, Tala Bath & Body, Tempo, The Intelligent Steambath, Valet Package, and Virtual Spa System are registered trademarks of MR.STEAM.

PUR 100595 REV 5.25