



Installation, Operation and Maintenance Manual

TempoFlex

IMPORTANT: Leave this material with the home owner.

mr.steam® | Feel Good Inc.®

READ ME FIRST!

! WARNING As you follow these instructions, you will notice warning and caution symbols. This blocked information is important for the safe and efficient installation and operation of this generator. These are types of potential hazards that may occur during installation and operation:

! WARNING Indicates a potentially hazardous situation, which, if not avoided, could result in death or serious injury.

! CAUTION Indicates a potentially hazardous situation, which, if not avoided may result in minor or moderate injury or product damage.

NOTICE is used to address practices not related to physical injury.

IMPORTANT NOTE: This highlights information that is especially relevant to a problem-free installation.

All information in these instructions is based on the latest product information available at the time of publication. MrSteam reserves the right to make changes at any time without notice. More current instructions may be available at www.mrsteam.com.

When installing and using this electrical equipment, basic safety precautions should always be followed, including the following:

IMPORTANT SAFETY INSTRUCTIONS

1. READ AND FOLLOW ALL INSTRUCTIONS

2. ! WARNING
Supervise children at all times.

3. ! WARNING Steam is hot and can cause injury or death if improperly used. Steam rooms contain steam and elevated temperatures. Please read and observe all warnings in this manual before installing or using a steam room.

4. ! WARNING
To reduce the risk of injury:
A. The wet surfaces of steam enclosures may be slippery. Use care when entering or leaving.
B. The steam head is hot. **DO NOT** touch the steam head and avoid the steam near the steam head.
C. Prolonged use of the steam system can raise excessively the internal human body temperature and impair the body's ability to regulate its internal temperature (hyperthermia). Limit your use of steam to

10-15 minutes until you are certain of your body's reaction.

D. Excessive temperatures have a high potential for causing fetal damage during the early months of pregnancy. Pregnancy or possibly pregnant women should consult a physician regarding correct exposure.

E. Obese persons and persons with a history of heart disease, low or high blood pressure, circulatory system problems, or diabetes should consult a physician before using a steambath.

F. Persons using medication should consult a physician before using a steambath since some medication may induce drowsiness while other medications may affect heart rate, blood pressure and circulation.

SAVE THESE INSTRUCTIONS

! WARNING

REDUCE THE RISK OF OVERHEATING AND SCALDING

1. EXIT IMMEDIATELY IF UNCOMFORTABLE, DIZZY OR SLEEPY. STAYING TOO LONG IN A HEATED AREA IS CAPABLE OF CAUSING OVERHEATING.
2. SUPERVISE CHILDREN AT ALL TIMES.
3. CHECK WITH A DOCTOR BEFORE USE IF PREGNANT, DIABETIC, IN POOR HEALTH OR UNDER MEDICAL CARE.
4. BREATHING HEATED AIR IN CONJUNCTION WITH CONSUMPTION OF ALCOHOL, DRUGS, OR MEDICATION IS CAPABLE OF CAUSING UNCONSCIOUSNESS.
5. DO NOT CONTACT STEAM HEAD OR STEAM AT THE STEAM HEAD.

REDUCE THE RISK OF SLIPPING AND FALL INJURY

1. USE CARE WHEN ENTERING OR EXITING THE STEAM ROOM. FLOOR MAY BE SLIPPERY

NOTE: FOR ADDITIONAL SAFETY CONSIDERATIONS SEE OWNER'S MANUAL

WHICH IS KEPT:

THE OWNER'S MANUAL CAN BE FOUND AT WWW.MRSTEAM.COM

USE OF STEAM ROOM IN CONJUNCTION WITH CONSUMPTION OF ALCOHOL CAN BE DANGEROUS AND CAN RESULT IN INJURY THROUGH SLIP AND FALL OR OTHERWISE.

mr.steam 43-20 34th Street, Long Island City, NY 11101 • 1 800 76 STEAM • www.mrsteam.com

PUR100378 5/22

HYPERTHERMIA occurs when the internal temperature of the body reaches a level several degrees above the normal body temperature of 98.6°

F. The symptoms of hyperthermia include an increase in the internal temperature of the body, dizziness, lethargy, drowsiness, and fainting. The effects of hyperthermia include:

- a) Failure to perceive heat;
- b) Failure to recognize the need to exit the steambath;
- c) Unawareness of impending risk;
- d) Fetal damage in pregnant women;
- e) Physical inability to exit the steambath and
- f) Unconsciousness.

! WARNING The use of alcohol, drugs, or medication can greatly increase the risk of hyperthermia

! WARNING The peel and stick warning label is an essential part of providing a safe environment for steam room users. The peel and stick warning label is supplied with the instruction manual provided with the steam generator and must be applied to the wall of the shower or steam enclosure, at a point that is visible to all users. Failure to install this sticker may result in serious injury or death.

TABLE OF CONTENTS

Important Safety Instructions1

Before Installing3

Dimensional Information4

General Installation Guidelines5

Installation Instructions for Tempoflex6

Wireless Installation7-8

Wireless Receiver9

TempoFlex Operating Instructions10

User Prests11

Charging12

System Status Codes12

BEFORE INSTALLING

Carefully inspect the control and packaging for shipping damage. In the event of shipping damage, please contact the carrier for claim information. Our customer service department can assist you with any missing or damaged parts.

⚠ CAUTION To avoid unintentional steambath operation, **DO NOT** locate the control where other controls, accessories, shower heads, valves, body sprays or similar within the shower could cause confusion or interfere with the MrSteam control's intended use and function. Do not use any MrSteam equipment without reading and understanding the respective Installation and Operation Manual and MrSteam steam generator Installation and Operation Manual. Failure to read and understand these instructions may result in an inoperative or hazardous installation.

⚠ WARNING A peel and stick warning sticker is provided in the MrSteam steam generator Installation, Operation and Maintenance Manual. This manual is provided with every steam generator. The warning sticker must be read and permanently affixed in a conspicuous location near the steam room. Failure to read and affix this warning sticker in a conspicuous location may result in serious injury or death. Please call MrSteam at 800 767-8326 for a free replacement or if you have any questions regarding the warning sticker.

Install the MrSteam steambath controls according to installation instructions. Failure to install according to instructions will result in an inoperative control or hazardous overheating or inadequate heating of the steam room. If a MrSteam steambath control is installed outside the steam room a Remote Temperature Probe (PN MSTs) must be installed inside the steam room per instructions for the Remote Temperature Probe. Failure to install according to instructions will result in an inoperative control and overheating of the steam room

⚠ CAUTION MrSteam steambath control wiring inside conduit together with power lines or close to hot water or steam piping. Doing so may result in an inoperative or hazardous installation.

⚠ WARNING **DO NOT** alter or modify any MrSteam product. Doing so may result in an inoperative or hazardous installation and will void the warranty.

IMPORTANT NOTES:

- Turn power to the steam generator **OFF** before connecting the control to the generator. Failure to turn the power off will result in an inoperable control.
- **DO NOT** operate MrSteam steambath controls with anything other than a MrSteam steambath generator compatible with the control. MrSteam residential steam generators with serial numbers lower than 1174000, or any other brand of steam generator are not to be operated with TempoFlex controls. Doing so may result in an inoperative installation.
- This document contains important safety, operation and maintenance information. Leave this document with the homeowner. **DO NOT** discard this document.
- Discontinue use of the steam generator or control if the steam generator is damaged or otherwise not functioning properly. Doing so may result in an inoperative or hazardous installation.
- All drawings are for illustrative purposes only.

DIMENSIONAL INFORMATION FOR TEMPOFLEX

BOX CONTENTS:

- TempoFlex Control
- Decorative Trim
- Control Cable (3')
- Wireless Receiver
- Power Supply
- Power Cord (30')
- Mounting Screws (2)
- Steamhead
- Tube of Silicone Sealant
- Surface Mount Bayonet
- Installation Manual

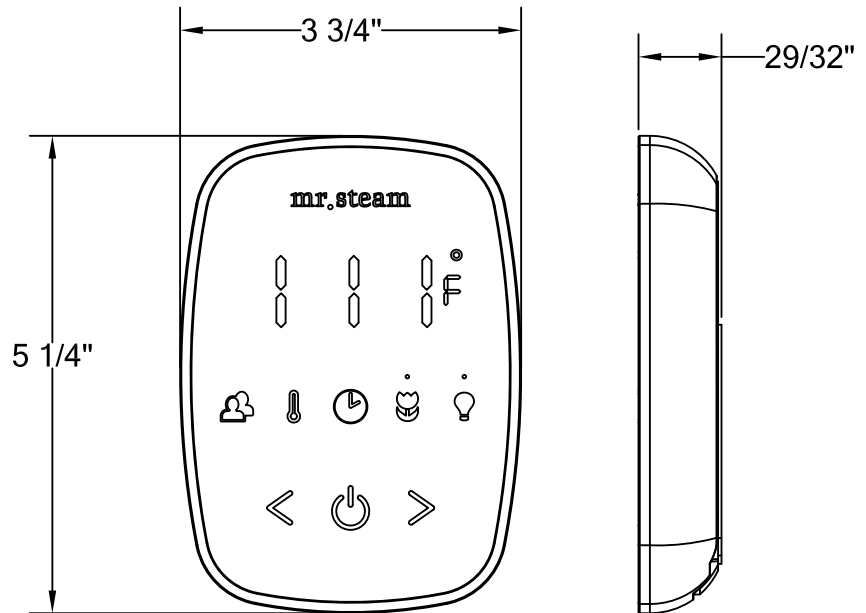

TempoFlex
(shown with decorative Trim)

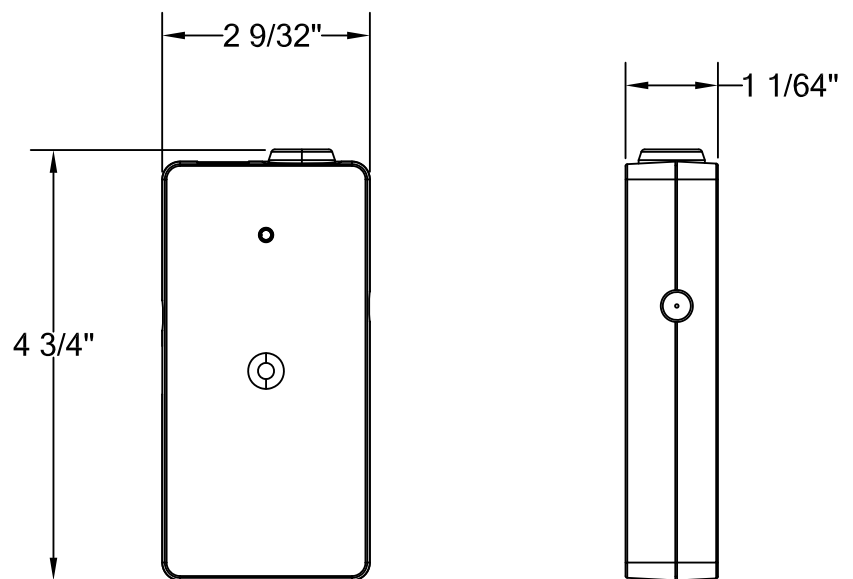

Wireless Receiver

GENERAL INSTALLATION GUIDELINES

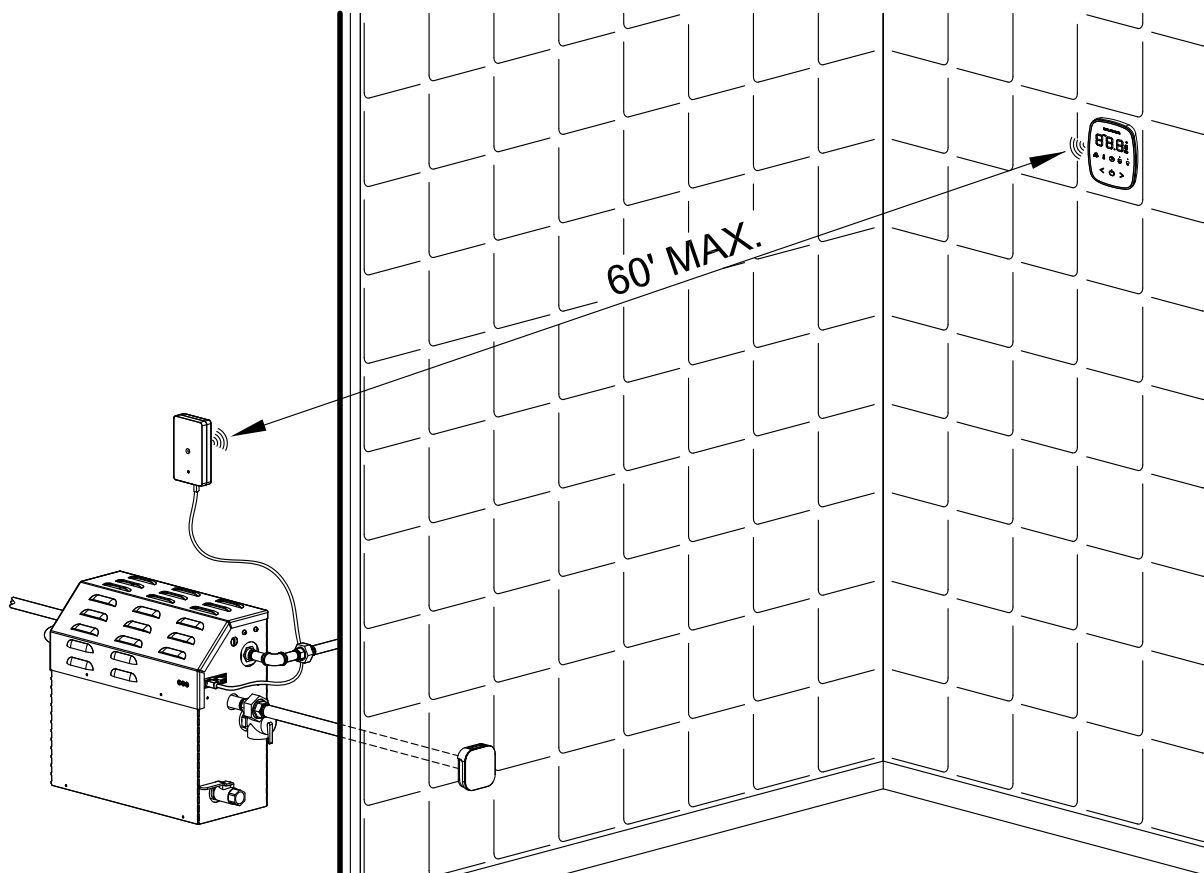

CAUTION The control features an integral temperature sensor. Locate the control in a location representative of the desired steam bathing temperature. **DO NOT** locate the control above or near the steam head or direct steam emissions. The ideal location for the control is on a wall opposite the steam head.

NOTICE To avoid unintentional steambath operation, **DO NOT** locate the control where other controls, accessories, shower heads, valves, body sprays or similar within the shower could cause confusion or interfere with the MrSteam control's intended use and function

If the control is installed outside the steam room a Remote Temperature Probe part number MST5 must be installed inside the steam room.

INSTALLATION INSTRUCTIONS FOR TEMPOFLEX

IMPORTANT NOTE:

TempoFlex can be installed completely wireless, or with a power wire from the generator. Follow the instructions according to your preferred installation.

STEP 1

Determine the desired installation location of the control. The TempoFlex controls are designed to be installed inside or outside the steam room as a matter of personal preference. If the control is installed outside the steam room a Remote Temperature Probe part number MSTS must be installed inside the steam room.

NOTICE

See installation instructions for the MSTS Temperature Probe before rough-in or installation of control. If the control is installed inside the steam room the control must be located:

- 4-5 feet above the floor near the bather seating area.
- On a vertical wall
- Mounting surface should be clean and dry

The control features an integral temperature sensor. Locate the control in a location representative of the desired steam bathing temperatures. **DO NOT** locate the control above or near the steam head or direct steam emissions. Locating the controls near the steamhead or near direct steam emissions may result in poor steam room temperature control.

NOTICE

DO NOT mount on grout/caulk lines.

The control can be located up to 60 feet from the wireless receiver. Construction materials affect the communication between the control and receiver. Test the range of the TempoFlex. It may be necessary to change the location of the wireless receiver to improve the range.

Water supply and steam piping must be flushed to remove flux and other debris prior to connecting the steam generator. Failure to flush the steam piping may result in flux poisoning or a hazardous condition. Failure to flush the steam piping may result in blockage or an inoperable system.

WIRELESS INSTALLATION INSTRUCTIONS FOR TEMPOFLEX

IMPORTANT NOTE:

TempoFlex can be installed completely wireless, or with a power wire from the generator. Follow the instructions according to your preferred installation.

STEP 2 – WIRELESS INSTALLATION

- 2A. Remove the mounting bayonet from the back of the TempoFlex Control.
- 2B. Remove and discard the release paper to expose the adhesive liner.
- 2C. Ensure the mounting surface is clean & dry.
- 2D. Place the bayonet on the wall in the desired location.
- 2E. Wait 15 minutes before placing the control on the bayonet.
To ensure the adhesive is secured.

NOTICE

Use the screw and anchor to secure the bayonet to the wall as required for rough or uneven wall surfaces. The surface mount bayonet supports the weight of the TempoFlex control.

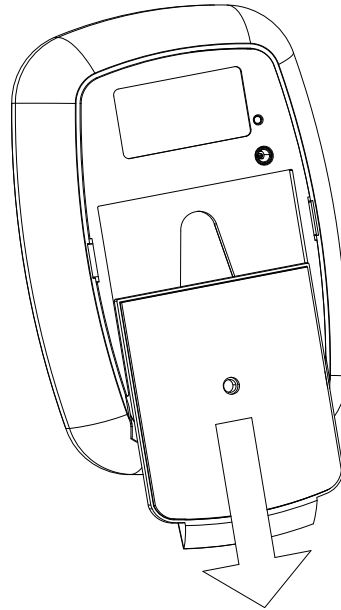

Wireless Figure 2a

WIRED INSTALLATION INSTRUCTIONS FOR TEMPOFLEX

IMPORTANT NOTE:

The wire provides power for the control, the communication is still wireless.

STEP 2 – WIRELESS INSTALLATION

IMPORTANT NOTE: TempoFlex controls are paired from the factory, ensure the control and wireless receiver are paired **BEFORE** attaching to wall.

- 2A. Determine the center of where the control shall be located.
- 2B. Drill a 3/8" diameter hole in the tile as shown and route the power cord from the wireless receiver to the steam room
- 2C. Plug the power cord into the back of the Tempo Flex
- 2D. Apply silicone around the power cord connector, such that when it is pushed into the hole it will create a seal
- 2E. Ensure the mounting surface is clean and dry.
- 2F. Remove and discard the release paper to expose the adhesive liner.
- 2G. Place the TempoFlex on the wall in the desired location

NOTICE

Use masking tape to support the control while the Silicone cures.

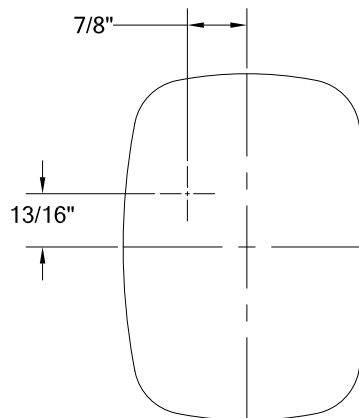

Wired Figure 2b

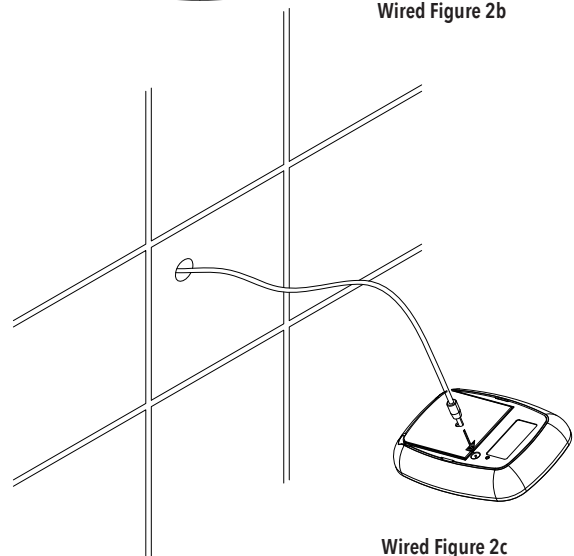

Wired Figure 2c

WIRED INSTALLATION INSTRUCTIONS FOR TEMPOFLEX (CONT.)

IMPORTANT NOTE:

The wire provides power for the control, the communication is still wireless.

STEP 3 – WIRED INSTALLATION

IMPORTANT NOTE:

TempoFlex controls are paired from the factory, ensure the control and wireless receiver are paired **BEFORE** attaching to wall.

- 3A. Plug the other end of the power cable into EITHER side of the wireless receiver which is connected to the steam generator.
- 3B. Plug the power supply cable into the connector on the opposite side of the wireless receiver from the power cable.
- 3C. Plug the power supply into a 120 volt outlet.

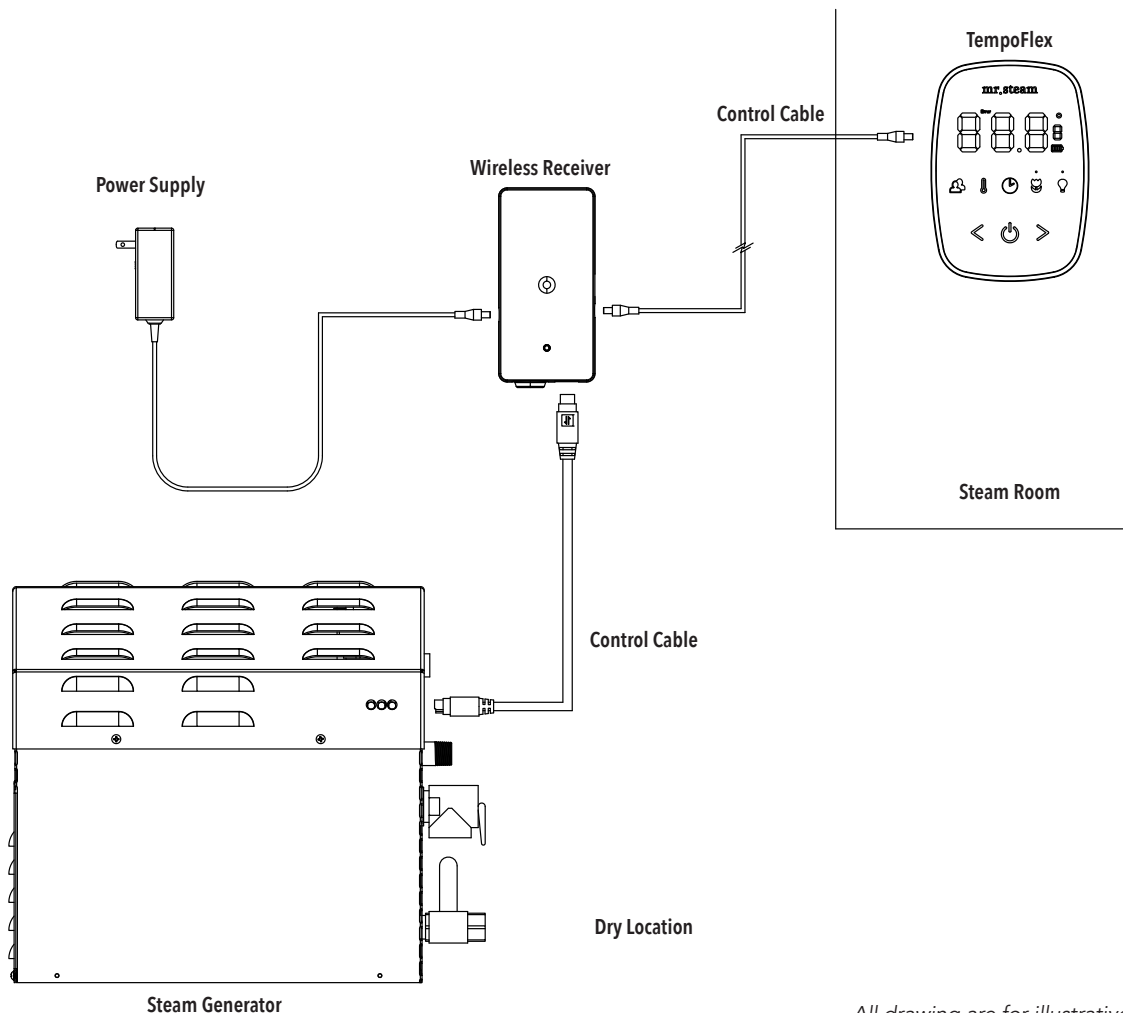

WIRELESS RECEIVER INSTALLATION

The control can be located up to 60 feet from the wireless receiver. Construction materials may affect the communication between the control and the receiver. Test the range of the TempoFlex. It may be necessary to change the location of the wireless receiver to improve the range. Contact MrSteam technical service for an optional 30 or 60 foot cable.

Using the 3 foot cable provided, plug one end into the steam bath generator and the other end into the TempoFlex wireless receiver

NOTICE The generator shall not be powered when the wireless receiver is plugged into it.

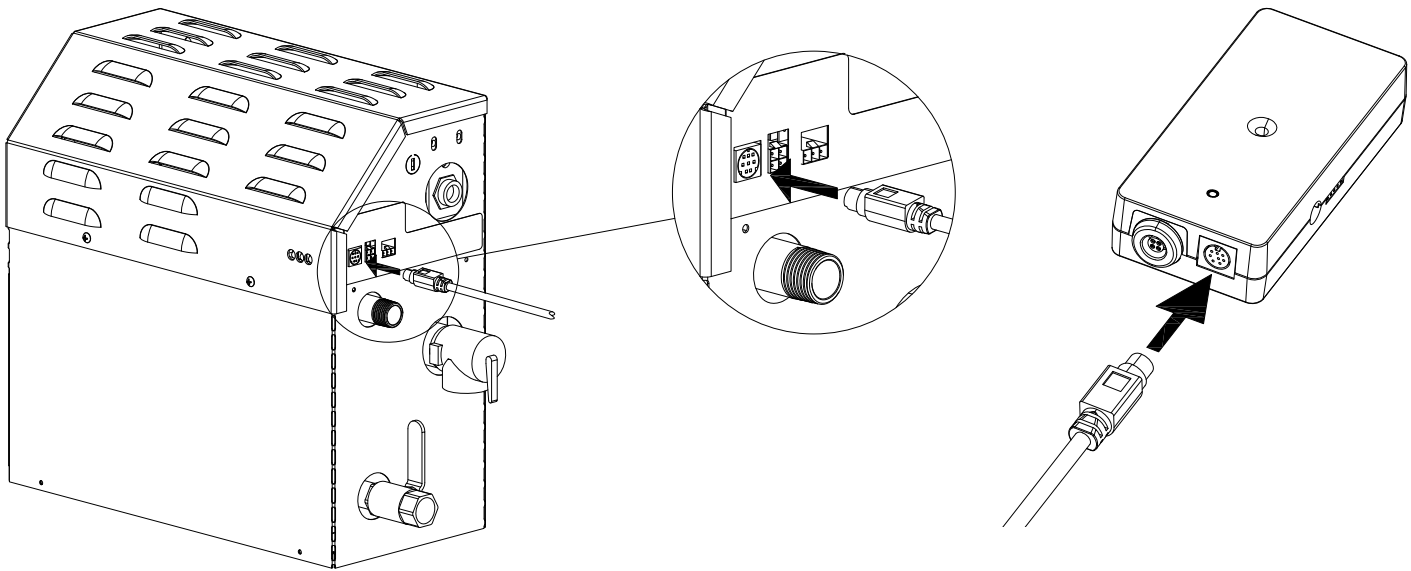

Attach the dongle on a wall adjacent to the steam generator using the screw provided.

NOTICE Do not rest the wireless receiver on the steam generator, The metal case of the generator may shield the wireless signal.

CHROMAX

If installing the optional ChromaSteamX lighting system, follow the Instructions provided with the ChromaSteamX.

Plug the ChromaSteamX communication cable into the grey connector on the TempoFlex wireless receiver

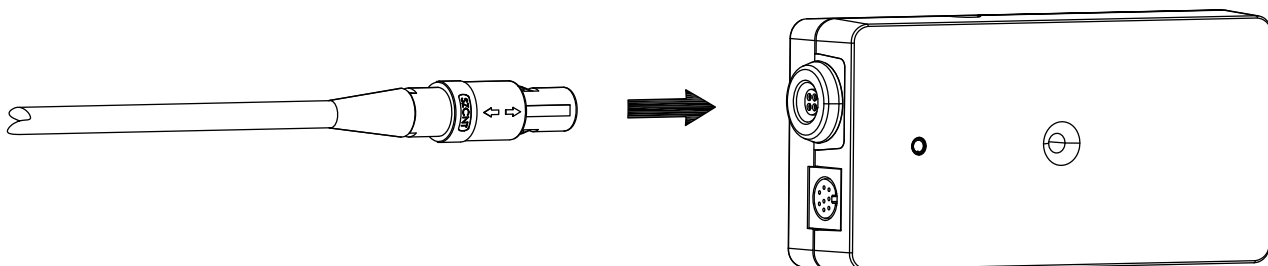
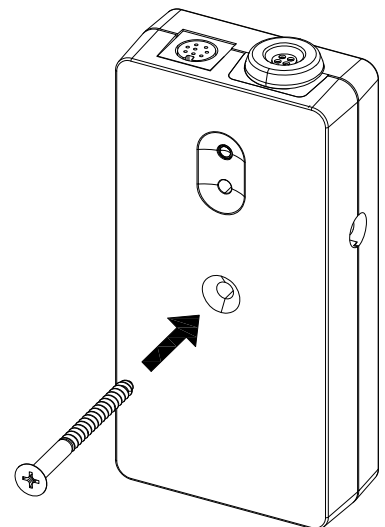

TEMPOFLEX OPERATING INSTUCTIONS

The TempoFlex features programmable temperature control, steam bath duration, AromaSteam **ON/OFF**, ChromaX control and two personal settings.

! WARNING Set the steam bathing temperature according to personal preference, however it is highly recommended to begin steam bathing at a low temperature setting for a very short duration to gauge comfort and safety levels

The LCD will be **OFF** until a button is pressed. The LCD remains lit for 10 seconds after the last button is pressed. When the steam generator turns **OFF** the display will turn on and read **OFF**. While the generator is steaming the LED above AROMA and CHROMA will alternately flash every 2 seconds.

ON/OFF

DIAGRAM 1

Press the **ON/OFF** key for second to start the flow of steam. The temperature set point is displayed. Steam will begin to flow 5 – 7 minutes after the control is turned **ON**. The duration required for the steam room to reach steam bathing temperatures depends on the steam room construction and steam generator specifications. To stop the flow of steam before time expires press the **ON/OFF** key. Steam may continue to flow for a short time after the control is turned **OFF**.

Diagram 1

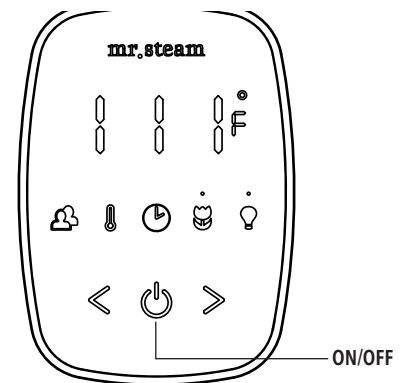

SETTING THE STEAMBATH DURATION

DIAGRAM 2

Press **TIME** key to set or display the steambath duration. The default time setting is 20 minutes. With the time displayed, press the **LEFT** or **RIGHT** arrows to set the desired duration time (2-60 minutes) in two minute increments.

Diagram 2

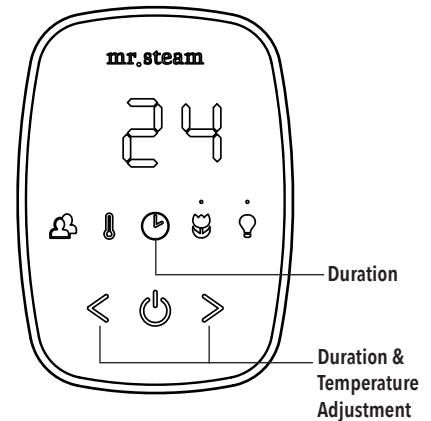
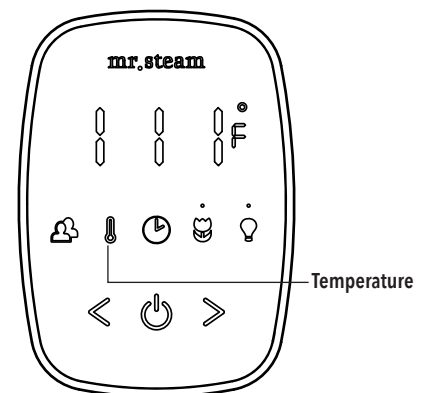

Diagram 3

SETTING THE TEMPERATURE

DIAGRAM 3

Press **TEMP** key to set the desired temperature or display the temperature setting. The default temperature setting is 110 *F. With the temperature displayed, press the **LEFT** or **RIGHT** arrows to set the desired temperature in one degree increments. Set the steam bathing temperature according to personal preference, however it is highly recommended to begin steam bathing at a low temperature setting for a very short duration to gauge comfort and safety levels



USER PRESETS

DIAGRAM 4

Use the user button to store preferred settings.

To program preferred settings:

Turn the steambath **ON**. Press the user button

once to program Pr1, twice to program Pr2

Enter the preferred time and temperature settings.

To select program 1 press the user button, Pr1 will be displayed, Press it twice to select program 2, Pr2 will be displayed. The Steambath will operate at the stored settings.

Diagram 4

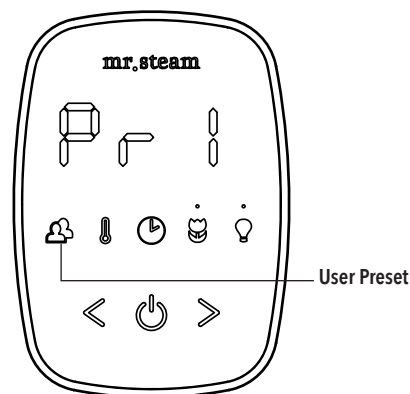

AROMASTEAM

The AromaSteam is an optional accessory that automatically injects aromatic oil into the steam. With the steambath **ON**, press the AROMA button. The AromaSteam will turn on and the **LED** above the AROMA button will turn **ON**. Press the AROMA button to turn AromaSteam off during a steam session. AromaSteam will automatically turn off when the steam generator stops heating. To conserve battery life the **LED** will only be lit when the display is **ON**



CHROMAX

The ChromaX is an optional accessory that provides colored light in the steam room. Press the CHROMA button to turn the light **ON**. When the ChromaX is on, momentarily press the CHROMA button to change the color of the ChromaX. A long press on the CHROMA button will turn the ChromaX off. To conserve battery life the **LED** will only be lit when the display is **ON**



CHANGING THE TEMPERATURE UNITS (*F/*C)

When the generator is **ON**, press and hold the TEMPERATURE button for 10 seconds, the temperature units will toggle to Fahrenheit (F) or Celsius (C)

USING TEMPOFLEX AS A REMOTE

The TempoFlex can be removed from its holder and used as a remote control to warm up the steam shower. When TempoFlex is returned to its holder the steam generator will run for the full set duration. After 10 minutes the steam generator turns off if TempoFlex is not returned to its dock. The steam generator will not restart for 30 minutes unless TempoFlex is returned to its dock and started with the **ON/OFF** button.

USING STEAMLINX WITH TEMPOFLEX

SteamLinx will allow the steam generator to warm up the steam room for 10 minutes, To continue the steam bath session, press any button on the TempoFlex (except the **ON/OFF** button). After 10 minutes the steam generator will turn off if TempoFlex is not touched. The steam generator will not restart for 30 minutes unless TempoFlex is returned to its dock and started with the **ON/OFF** button.

USER CHARGING TEMPOFLEX

The TempoFlex will need periodic charging. The time between charges will depend on use. When the battery begins to get low a battery icon will be displayed to the right of the display.

Remove the TempoFlex from its wall dock by sliding it up and off the bayonet Holder and plug the charger into the charging port on the back of the control.

Use a soft cloth to dry off the control

WARNING TempoFlex must be charged in a dry location. The control must be dry before plugging in the charger.
When the control is fully charged the battery icon will disappear

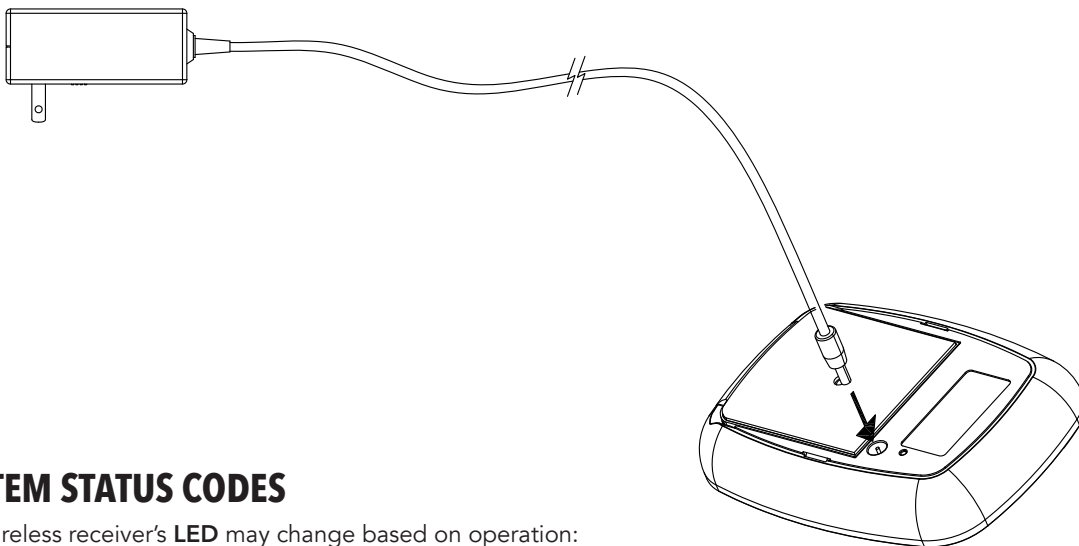
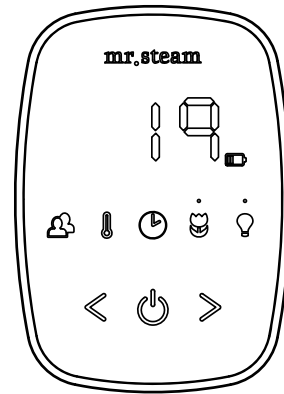

SYSTEM STATUS CODES

The wireless receiver's **LED** may change based on operation:

WHITE When the system is powered up the wireless receiver will boot up, the generator may turn on and off during this process. The process is complete when the **LED** turns green.

SOLID GREEN Steam system is not being used

GREEN WITH AMBER FLASHES Indicates the system is **ON**. The wireless receiver flashes each time information is exchanged between the TempoFlex and the wireless receiver.

The TempoFlex may display a status code if the system is not functioning correctly.

CO Indicates the TempoFlex control has lost communication with the wireless receiver.

Ensure all connections are secure between the steam generator and wireless receiver and there is a green **LED** on the wireless receiver.

ERR P indicates an error while pairing, reset the system and redo pairing.

PRR1/2 Indicates an error with the internal (or MSTs) temperature probe.

ERR1 The incorrect field voltage is being supplied to the steam bath generator (green **LED** on steam generator will be **OFF**).

H2O/ERRB Steam generator water level is not satisfied.

A complete list of steam generator status codes and troubleshooting can be found in the MrSteam Residential Steambath Installation Operation and Maintenance Manual.

PAIRING

TempoFlex controls are paired at the factory. Pairing should not normally need to be done, however it is recommended to confirm operation before committing the control to the wall.

To confirm pairing, plug the wireless receiver into the generator as described on page 6. Press the power button on the TempoFlex, if the control displays **ON** and then 20, it is paired. If the control displays **CO** it will need to be paired to the wireless receiver by following the steps below:

- A. Turn off power to the steam bath
- B. After 1 minute turn power to the steam bath back on
- C. While the wireless receiver's **LED** is white, use a blunt object to press the button on the back of the TempoFlex control, the TempoFlex will display **OFF**
- D. Press and hold the user preset button
- E. When pairing is complete the display will show P followed by **OFF**

IMPORTANT NOTE The control does **NOT** need to be in the wall dock during pairing.

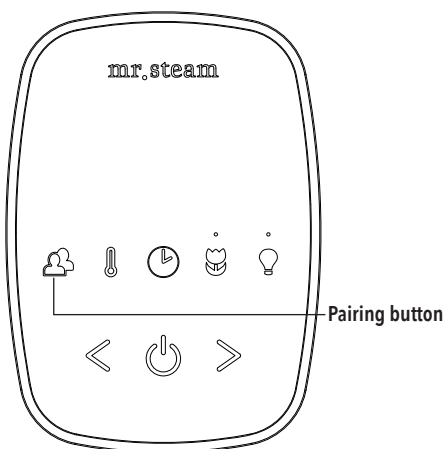
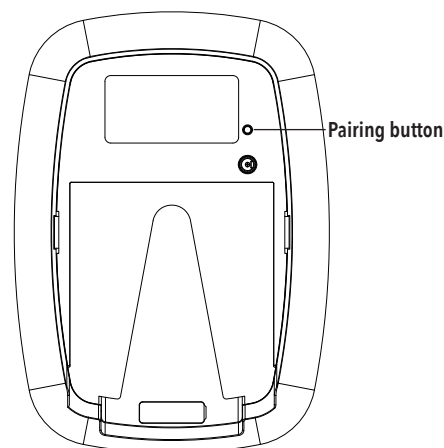

CARE TIPS FOR TEMPOFLEX CONTROLS & STEAM HEADS

1. Use only mild soap and water on a soft cloth to clean the control and steam head.
2. **DO NOT** use abrasive cleansers
3. If the decorative cover is damaged call MrSteam technical service for replacement parts.

WARRANTY

To view or download the MrSteam Residential Generator Warranty and register your Product go to: **blog.mrsteam.com/wr**

mr.steam®

Feel Good Inc.®

www.mrsteam.com

Products, information and specifications are subject to change without notice.

Please call Sales & Support at 1.800.76.STEAM (East Coast) or 1.800.72.STEAM (West Coast) for more information.

mr.steam® hello@mrsteam.com | www.mrsteam.com

43-20 34th Street, Long Island City, NY 11101 1 800 76 STEAM | 9410 S. La Cienega Blvd. Inglewood CA 90301 1 800 72 STEAM

2025 © MrSteam and des., A Lifetime of Pleasure, AirTempo, AromaFlo, AudioWizard, AutoFlush, AutoSteam, Butler Package, ChromaSteam, Clean Steam...Every Time, Club Therapy, CT Day Spa, Digital 1, Express Steam, Feel Good Inc., From Bathroom to Spa, HomeWizard, iButler, iGenie, iSpa Package, iSteam, iTempo, iTempo/Plus, TempoTouch, TempoFlex, Linear Steamhead, Making Wellness a Way of Life, Music Therapy, My Steam, SmartSizing, Spa Package, Steam Genie, Steam on Demand, Steam in a Box, Steam@Home, SteamStart, SteamTherapy, Tala, Tala Bath & Body, Tempo, The Intelligent Steambath, Valet Package, and Virtual Spa System are registered trademarks of MR.STEAM.

PUR 100547 REV 6.25